

DEPARTMENT OF COUNTY ENGINEER  
 DIVISION OF BUILDING AND SAFETY  
 COUNTY OF LOS ANGELES  
 WILLIAM J. FOX, COUNTY ENGINEER  
 CASBATT D. GRIFFIN, SUPT OF BUILDING

# BUILDING

APPLICATION

1

**FOR APPLICANT TO FILL IN**

BUILDING ADDRESS: 917 1/2 SUNSET BLVD

LOCALITY: VI HOLLYWOOD

NEAREST CROSS ST.: Park

OWNER: CHARLES H. HORNBERG

MAIL ADDRESS: 917 1/2 SUNSET BLVD

CITY: L.A. TEL. NO. \_\_\_\_\_

ARCHITECT OR ENGINEER: \_\_\_\_\_ TEL. NO. \_\_\_\_\_

ADDRESS: \_\_\_\_\_

CONTRACTOR: \_\_\_\_\_ TEL. NO. \_\_\_\_\_

ADDRESS: OWNER

LEGAL DESCRIPTION: \_\_\_\_\_ LOT NO. 1 BLOCK -

TRACT: 7980

SIZE OF LOT: 55X100 NO. OF BLDGS. NOW ON LOT: 2

USE OF EXISTING BLDG.: OFF & SHOW ROOM NO. OF FAMILIES: -

**DESCRIPTION OF WORK**

NEW	ALTERATION	<input checked="" type="checkbox"/>	ADDITION
REPAIR	DEMOLITION		

NO. OF STORIES: 80 NO. OF FLOORS: 1 FLOORS: 1

EXT. WALL COVERING: STEEL ROOF COVERING: CONCRETE

USE OF STRUCTURE: ERECT PARTITION FOR KITCHEN. INSTALL WAREHOUSE.

I HEREBY ACKNOWLEDGE THAT I HAVE READ THIS APPLICATION AND STATE THAT THE INFORMATION GIVEN IS CORRECT.

I AGREE TO COMPLY WITH ALL COUNTY ORDINANCES AND STATE LAWS REGULATING BUILDING CONSTRUCTION.

SIGNATURE OF PERMITTEE: Charles Hornberg

ADDRESS: \_\_\_\_\_

AUTHORIZED AGT.: \_\_\_\_\_

VALUATION: 500.00

**FOR OFFICE USE ONLY**

DISTRICT NO.: 9W PLAN OR REC. NO.: \_\_\_\_\_ PERMIT NO.: 5155808

RECEIVED BY: Holt DATE OF APPL.: 4/7/53 DATE ISSUED: 4/7/53

BUILDING ADDRESS: 917 1/2 Sunset Blvd

LOCALITY: VI Hollywood

NEAREST CROSS ST.: \_\_\_\_\_

FIRE ZONE: \_\_\_\_\_ NO. OF PLANS: 1 TYPE: V GROUP: R

BLDG. SETBACK LINE: None CRD. NO. \_\_\_\_\_

USE ZONE: 2 APPROVED BY: \_\_\_\_\_ DATE: \_\_\_\_\_

MAP NUMBER: 9308 HOUSE NUMBERING NO. ASSIGNED BY: \_\_\_\_\_

**CORRECTIONS**

FOUNDING

**APPROVALS**

FOUNDATION: LOCATION FORMS, MATERIALS	INSPECTOR'S SIGNATURE	DATE
FRAMES: FIRE STOPS, BRACING BOLTS	<u>[Signature]</u>	
FURTHER LOCATION: GAS VENT, DUCTS	<u>[Signature]</u>	
LATH, INT.	<u>[Signature]</u>	
LATH, EXT.	<u>[Signature]</u>	
PLASTER, INT.	<u>[Signature]</u>	
PLASTER, EXT.	<u>[Signature]</u>	
HOUSE NUMBER CORRECT AND POSTED		
FINAL		

P.C.R. FEE: \_\_\_\_\_ PERK: 400

# APPLICATION FOR BUILDING PERMIT

COUNTY OF LOS ANGELES  
 DEPARTMENT OF COUNTY ENGINEER  
 BUILDING AND SAFETY DIVISION  
 JOHN A. LAMBIE, COUNTY ENGINEER  
 COLEMAN W. JENKINS, SUPT OF BUILDING

FOR APPLICANT TO FILL IN  
(Print or type only)

ASSESSOR MAP BOOK	PAGE	PARCEL
BUILDING ADDRESS	9176 Sunset Blvd	
LOCALITY	W. Hollywood	
NEAREST CROSS ST	Cody	
DISTRICT NO.	CIRCLE TYPE CONST.	APPROVED BY
5	RE-CONSTR.	Shore
STATISTICAL CLASSIFICATION		SEWER MAP
CLASS NO.	922 DOWELL UNITS	BK PG
USE ZONE	MAP NO.	
CR	4305	
SPECIAL CONDITIONS		

BUILDING ADDRESS **9176 SUNSET BLVD**

LOT NO. **1** BLOCK **-**

TRACT **7980**

SIZE OF LOT **55 X 100** NO. OF BLDGS. NOW ON LOT **2**

USE OF EXISTING BLDG. OFF. + SHOW ROOM

CORNER **CHARLES F. HORNBERG JR.** TEL. NO. **GR2-4461**

ADDRESS **624 NILES ROAD**

CITY **LOS ANGELES**

ARCHITECT OR ENGINEER \_\_\_\_\_ TEL. NO. \_\_\_\_\_

ADDRESS \_\_\_\_\_

CONTRACTOR **KINCAN GLASS** LIC. NO. **EX9-3257**

ADDRESS **2405 KINCAN BLVD** LIC. NO. \_\_\_\_\_

CITY **SANTA MONICA** LIC. CLASS \_\_\_\_\_

CONSTRUCTION LENDER NAME AND BRANCH **HOME**

ADDRESS \_\_\_\_\_

SO. FT. SIZE **10x12** NO. OF STORIES **-** NO. OF FAMILIES **-** NEW

USE OF STRUCTURE **Replace 10x12** ADD

**POWER OF TROKEN GLASS** ALTER

SIGNATURE OF APPLICANT **[Signature]** REPAIR

VALUATION \$ **100** DEMOL

P.C. FEE \$ \_\_\_\_\_

PNT. FEES **4.00**

I HEREBY ACKNOWLEDGE THAT I HAVE READ THIS APPLICATION AND STATE THAT THE ABOVE IS CORRECT AND AGREE TO COMPLY WITH ALL ORDINANCES AND LAWS REGULATING BUILDING CONSTRUCTION. I CERTIFY THAT IN DOING THE WORK AUTHORIZED HEREBY I WILL NOT EMPLOY ANY PERSON IN VIOLATION OF THE LABOR CODE OF THE STATE OF CALIFORNIA IN RELATION TO WORKMEN'S COMPENSATION INSURANCE.

SIGNATURE OF PERMITTEE **[Signature]**

ADDRESS \_\_\_\_\_

BLDG. SETBACK FROM FRONT PROP. LINE OF \_\_\_\_\_ (STREET)

TYPE OF EXISTING HIGHWAY	SETBACK FROM CL.	HIGHWAY WIDTH	YARD	TOTAL

BLDG. SETBACK FROM SIDE PROP. LINE OF \_\_\_\_\_ (STREET)

TYPE OF EXISTING HIGHWAY	SETBACK FROM CL.	HIGHWAY WIDTH	YARD	TOTAL

CORNER CUTOFF YES  NO

SEE REVERSE SIDE FOR SPECIAL APPROVALS

ask to replace 1/4 plate glass w/ same type as existing glass per Sec. int (e)

APPROVALS	DATE	INSPECTOR'S SIGNATURE
FOUNDATION: LOCATION FORMS, MATERIALS		
FRAME: FIRE STOPS, BRACING, BOLTS		
FURNACE: LOCATION, GAS VENT, DUCTS		
LATH, INT.		
LATH, EXT.		
HOUSE NUMBER CORRECT AND POSTED		
FINAL	<b>2/29/71</b>	<b>[Signature]</b>

JOHN F. LEWIS, PRINCIPAL STRUCTURAL ENGINEER  
 PERMIT VALIDATION

PLEASE CHECK VALIDATION CA NO CASH

LAD 2585 FEB 19 1 400

*[Handwritten signature]*

INSPECTOR COPY

Agency

DEPARTMENT OF BUILDING AND SAFETY  
COUNTY OF LOS ANGELES  
315 N. FOX STREET, LOS ANGELES, CALIF. 90012

DEPARTMENT OF BUILDING AND SAFETY  
COUNTY OF LOS ANGELES  
315 N. FOX STREET, LOS ANGELES, CALIF. 90012

APPROVED AS TO ZONING	APPROVED AS TO CONSTRUCTION	APPROVED AS TO PLANS	APPROVED AS TO SPECIFICATIONS
DATE: 10/15/78	DATE: 10/15/78	DATE: 10/15/78	DATE: 10/15/78

APPROVED AS TO ZONING	APPROVED AS TO CONSTRUCTION	APPROVED AS TO PLANS	APPROVED AS TO SPECIFICATIONS
DATE: 10/15/78	DATE: 10/15/78	DATE: 10/15/78	DATE: 10/15/78
APPROVED AS TO ZONING	APPROVED AS TO CONSTRUCTION	APPROVED AS TO PLANS	APPROVED AS TO SPECIFICATIONS
DATE: 10/15/78	DATE: 10/15/78	DATE: 10/15/78	DATE: 10/15/78
APPROVED AS TO ZONING	APPROVED AS TO CONSTRUCTION	APPROVED AS TO PLANS	APPROVED AS TO SPECIFICATIONS
DATE: 10/15/78	DATE: 10/15/78	DATE: 10/15/78	DATE: 10/15/78
APPROVED AS TO ZONING	APPROVED AS TO CONSTRUCTION	APPROVED AS TO PLANS	APPROVED AS TO SPECIFICATIONS
DATE: 10/15/78	DATE: 10/15/78	DATE: 10/15/78	DATE: 10/15/78
APPROVED AS TO ZONING	APPROVED AS TO CONSTRUCTION	APPROVED AS TO PLANS	APPROVED AS TO SPECIFICATIONS
DATE: 10/15/78	DATE: 10/15/78	DATE: 10/15/78	DATE: 10/15/78

APPROVED AS TO ZONING	APPROVED AS TO CONSTRUCTION	APPROVED AS TO PLANS	APPROVED AS TO SPECIFICATIONS
DATE: 10/15/78	DATE: 10/15/78	DATE: 10/15/78	DATE: 10/15/78
APPROVED AS TO ZONING	APPROVED AS TO CONSTRUCTION	APPROVED AS TO PLANS	APPROVED AS TO SPECIFICATIONS
DATE: 10/15/78	DATE: 10/15/78	DATE: 10/15/78	DATE: 10/15/78







D. B. 17 341 224

DEPARTMENT OF BUILDING AND SAFETY  
COUNTY OF LOS ANGELES  
Wm. J. Fox, Chief Engineer

APPLICATION FOR PERMIT  
**PLUMBING** 1

NATURE OF INSTALLATION

ROUGH	FIXTURES	COMPLETE
HEATER	CESSPOOL	SEPTIC TANK
GAS	MISCELLANEOUS	

DISTRICT NO.	GROUP	ZONE	PERMIT NO.
9	E	C2	49156
RECEIVED BY	READY FOR FIRST INSPECTION	DATE ISSUED	
<i>[Signature]</i>	<i>[Signature]</i>	5-19-42	

APPLICANT FILL IN HEAVILY OUTLINED PORTION ONLY.

PLUMBING

NAME: *[Blank]*

ADDRESS: *[Blank]*

CITY: *[Blank]* TEL. NO.: *[Blank]*

COUNTY CERT. NO.: *[Blank]* OFFICE: *[Blank]*

JOB ADDRESS: *2175 Sycamore Ave.*

LOCALITY: *W. Hollywood*

NEAREST CROSS ST.: *Corn*

OWNER NAME: *[Blank]*

MAIL ADDRESS: *[Blank]* TEL. NO.: *[Blank]*

CITY AND STATE: *[Blank]*

LOCATION OF SEPTIC TANK, OR CESSPOOL

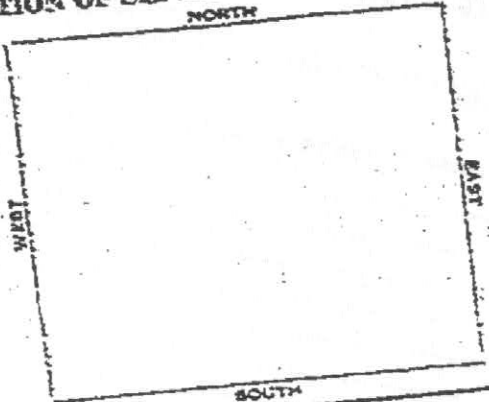

I AM THE LEGAL POSSESSOR OF THE ABOVE LOS ANGELES COUNTY CERTIFICATE OF QUALIFICATION.  
*[Signature]*  
PLUMBER

I AM THE LEGAL OWNER OF THE PROPERTY DESCRIBED ABOVE.  
*[Signature]*  
OWNER

CORRECTIONS

DESCRIPTION OF WORK

BATH TUB	FURNACE
SHOWER	DISHWASHER
LAVATORY	REFRIGERATOR
KITCHEN SINK	WATER SOFTENER
FLOOR SINK	SAND TRAP
SLOP SINK	FLOOR DRAIN
WASH TRAY	URINAL
WATER CLOSET	DRINKING FOUNTAIN
WATER HEATER	DENTAL LAVATORY
METER GAS OUTL.	SODA FOUNTAIN
TOTAL NUMBER OF FIXTURES	
CESSPOOL	SEPTIC TANK

APPROVALS

	DATE	INSPECTOR'S NAME
ROUGH PLUMBING		
GAS PIPING		
GAS VENT		
CESSPOOL		
SEPTIC TANK		
SEWER		
UTILITY CO. NOTIFIED		
FINAL		

TOTAL FEE

*150*

ORIGINAL

DEPARTMENT OF BUILDING  
COUNTY OF LOS ANGELES

APPLICATION FOR PERMIT  
PLUMBING

1

NATURE OF INSTALLATION				DISTRICT NO.	AREA	NO.	PERMIT NO.
ROUGH PLUMBING	<input type="checkbox"/>	PICTURES	<input type="checkbox"/>	9			17872
HEATER	<input checked="" type="checkbox"/>	CESSPOOL	<input type="checkbox"/>	READY FOR FIRST INSPECTION	RECEIVED BY <i>[Signature]</i>		DATE ISSUED 12-30-35
GAS	<input checked="" type="checkbox"/>	MISCELLANEOUS	<input type="checkbox"/>	COMPLETE			
				SEPTIC TANK			

APPLICANT FILL IN HEAVILY OUTLINED PORTION ONLY

PLUMBER NUMBER	NAME	E E BURT	JOB ADDRESS	9176 1/2 Sunset Blvd
	ADDRESS	7524 - Sunset Blvd	LOCALITY	8037
	CITY	Los Angeles, TEL. NO. Gr 1156	NEAREST CROSS ST.	
	STATE LICENSE NO.	3643	COUNTY REG. NO.	705

LOCATION OF SEPTIC TANK, OR CESSPOOL

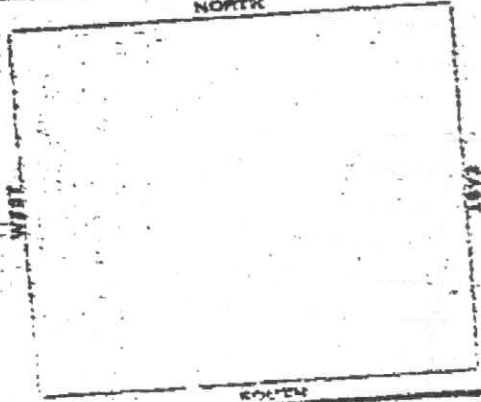

OWNER NAME	Mrs A E Kaercher
MAIL ADDRESS	P O Box 903
CITY	Everly Hills, Cal. No.

CORRECTIONS  
*7/4 Hollywood*

DESCRIPTION OF WORK

- |  |  |
|--|--|
| <input type="checkbox"/> BATH TUB                | <input type="checkbox"/> FURNACE           |
| <input type="checkbox"/> SHOWER                  | <input type="checkbox"/> DISHWASHER        |
| <input type="checkbox"/> LAVATORY                | <input type="checkbox"/> REFRIGERATOR      |
| <input type="checkbox"/> KITCHEN SINK            | <input type="checkbox"/> WATER SOFTENER    |
| <input type="checkbox"/> FLOOR-SINK              | <input type="checkbox"/> SAND TRAP         |
| <input type="checkbox"/> SLOP-SINK               | <input type="checkbox"/> FLOOR-DRAIN       |
| <input type="checkbox"/> WASH TRAY               | <input type="checkbox"/> URINAL            |
| <input type="checkbox"/> WATER CLOSET            | <input type="checkbox"/> DRINKING FOUNTAIN |
| <input checked="" type="checkbox"/> WATER HEATER | <input type="checkbox"/> DENTAL LAVATORY   |
| <input checked="" type="checkbox"/> METER        | <input type="checkbox"/> SODA FOUNTAIN     |
| <input type="checkbox"/> GAS OUTL.               |  |

TOTAL NUMBER OF FEATURES	23	50
SEPTIC TANK		
CESSPOOL		
PERMIT FEE		1.00
TOTAL FEE		1.50

APPROVALS

	DATE	INSPECTOR'S NAME
ROUGH PLUMBING		
GAS PIPING	12-30-35	[Signature]
GAS VENT		
CESSPOOL		
SEPTIC TANK		
SEWER		
UTILITY CO. NOTIFIED	12-30-35	[Signature]
FINAL		

ORIGINAL







FORM 9-30 1944

DEPARTMENT OF BUILDING AND SAFETY  
COUNTY OF LOS ANGELES  
WM. J. FOX, CHIEF ENGINEER

APPLICATION FOR PERMIT

BUILDING

1

NO. OF PLANS <b>0</b>	BLDG. CHECKED LINE APPROVED BY _____ DATE _____	CRK. NO.	DISTRICT NO. <b>9</b>	PLAN CK. NO. <b>none</b>	PERMIT NO. <b>760938</b>
FIRE ZONE <b>3</b>	APPROVED BY _____ DATE _____		RECEIVED BY <b>Yance</b>	DATE OF APPL. <b>2-4-44</b>	DATE ISSUED <b>2-4-44</b>
USE ZONE <b>C-2</b>	APPROVED BY _____ DATE _____				

APPLICANT FILL IN HEAVILY OUTLINED PORTION ONLY

ARCHITECT OR ENGINEER	NAME	BUILDING ADDRESS <b>9174 Suncrest</b>
	ADDRESS <b>owner</b>	LOCALITY <b>Hollywood Cal</b>
	CITY	NEAREST CROSS ST. <b>10th</b>
	STATE LICENSE NO. TEL. NO.	
CONTRACTOR	NAME <b>Wood &amp; ...</b>	OWNER NAME <b>Wm. J. Fox</b>
	ADDRESS <b>9174 Suncrest</b>	MAIL ADDRESS <b>same</b>
	CITY <b>Los Angeles</b>	CITY <b>same</b> TEL. NO.
	STATE LICENSE NO. TEL. NO.	
LEGAL DESCRIPTION	LOT NO. <b>1</b>	SIZE OF LOT <b>24x40</b>
	BLOCK	NO. OF BLDGS. NOW ON LOT <b>1</b>
	TRACT <b>7980</b>	
	USE OF BLDGS. NOW ON LOT <b>5 units</b>	

I HEREBY ACKNOWLEDGE THAT I HAVE READ THIS APPLICATION AND STATE THAT THE ABOVE IS CORRECT AND AGREE TO COMPLY WITH ALL COUNTY ORDINANCES AND STATE LAWS REGULATING BUILDING CONSTRUCTION.

SIGNATURE OF OWNER AUTHORIZED AGENT *[Signature]*

CORRECTIONS

*2-4-44 Yance - found ...  
Obtain Ventilation permit ...  
Other errors -*

DESCRIPTION OF WORK

USE OF BUILDING *Alterations to existing  
metal partitions  
Divide space - 5 rooms  
to be photo studio  
non development*

NEW	TYPE <b>V</b>	GROUP <b>F</b>
ALTERATION	NO. OF ROOMS <b>5</b>	NO. OF FAMILIES <b>0</b>
ADDITION	SIZE	
REPAIR	STORIES <b>1</b>	
MOVING	WALL COVERING <b>Stucco</b>	
DEMOLISH	ROOF COVERING <b>Composition</b>	

FINAL APPROVAL

VALUATION <b>5</b>	P.C.S. <b>YES</b>	INSPECTOR'S NAME <b>Yance</b>
<b>570</b>	FEE <b>3.50</b>	DATE <b>2-11-44</b>

ORIGINAL



DEPARTMENT OF BUILDING AND SAFETY  
 COUNTY OF LOS ANGELES  
 WM. J. FOX, CHIEF ENGINEER

APPLICATION FOR PERMIT  
**BUILDING**

1

FOR APPLICANT TO FILL IN

FOR OFFICE USE ONLY

BUILDING ADDRESS: 9176 W. Sunset Blvd  
 LOCALITY: West Hollywood  
 NEAREST CROSS ST.: Canyon  
 OWNER: F. E. Heath  
 MAIL ADDRESS: 9176 W. Sunset Blvd  
 CITY: Los Angeles TEL. NO.: 7-27-22  
 ARCHITECT OR ENGINEER: [Signature] TEL. NO.:  
 ADDRESS:  
 CONTRACTOR: [Signature] TEL. NO.: 7-27-22  
 ADDRESS: 346 Canyon  
 LEGAL DESCRIPTION: LOT NO. 1 BLOCK  
 TRACT: 7982  
 SIZE OF LOT: 44' x 28' NO. OF BLOOR. NOW ON LOT: 1  
 USE OF EXISTING BLDG.: Warehouse NO. OF FAMILIES: - NO. OF ROOMS: 10

DISTRICT NO. 9	PLAN CK. NO. -	PERMIT NO. 2278
RECEIVED BY [Signature]	DATE OF APPL. 3-2-48	DATE ISSUED 3-2-48
BUILDING ADDRESS 9176 W. SUNSET Blvd	LOCALITY W. Hollywood	NEAREST CROSS ST. Canyon
FIRE ZONE -	NO. OF PLANS -	TYPE I
BLDG. SETBACK LINE 25' E on S. side	DEPT. NO. 1716	APPROVED BY [Signature]
USE ZONE C-2	APPROVED BY [Signature]	DATE 3/2/48

**DESCRIPTION OF WORK**

NEW	ALTERATION <input checked="" type="checkbox"/>	ADDITION
REPAIR	MOVING	DEMOLISH
SQ. FT. SIZE	NO. OF ROOMS: 10	STORIES: 1
WALL COVERING: Stucco	ROOF COVERING: Gypsum	
USE OF NEW BUILDING	INSTALL 12 TWO	
WINDOWS IN EXISTING OFFICE BLDG.		

**CORRECTIONS**

1. [Handwritten correction]

2. [Handwritten correction]

3. [Handwritten correction]

I HEREBY ACKNOWLEDGE THAT I HAVE READ THIS APPLICATION AND STATE THAT THE ABOVE IS CORRECT AND AGREE TO COMPLY WITH ALL COUNTY ORDINANCES AND STATE LAWS REGULATING BUILDING CONSTRUCTION.

SIGNATURE OF OWNER: [Signature]

AUTHORIZED AGT: [Signature]

**APPROVALS**

FOUNDATION: LOCATION, FORMS, MATERIALS	INSPECTOR	DATE
FRAME: FIRE STOP, BRACING, BOLTS		
LATH, INT.		
LATH, EXT.		
PLASTER, INT.		
PLASTER, EXT.		
FINAL	[Signature]	4/8/48

ONE-2 234 SETS 4-47 5

VALUATION: 150.00

P.C.S.  
 FEE: -  
 FEE: 2.00

ORIGINAL



DEPARTMENT OF BUILDING AND SAFETY  
COUNTY OF LOS ANGELES

WM. J. FOX, CHIEF ENGINEER

APPLICATION FOR PERMIT

**BUILDING**

1

FOR APPLICANT TO FILL IN

FOR OFFICE USE ONLY

BUILDING ADDRESS 9176 Sunset Blvd.  
 LOCALITY West Hollywood  
 NEAREST CROSS ST. Cole St.  
 OWNER Beachwood Hardware  
 MAIL ADDRESS 8520 Sunset Blvd.  
 CITY L.A. TEL. NO. CR 4-5132  
 ARCHITECT OR ENGINEER \_\_\_\_\_ TEL. NO. \_\_\_\_\_

DISTRICT NO. 901 PLAN CK. NO. \_\_\_\_\_ PERMIT NO. 7835  
 RECEIVED BY MM DATE OF APPL. 2-28-50 DATE ISSUED 2-28-50  
 BUILDING ADDRESS 9176 Sunset Blvd.  
 LOCALITY West Hollywood  
 NEAREST CROSS ST. Cole St.  
 FIRE ZONE \_\_\_\_\_ NO. OF PLANS 2 TYPE II GROUP F

ADDRESS \_\_\_\_\_  
 CONTRACTOR V.E. DeHaven TEL. NO. WH 1-996  
 ADDRESS 8020 Mayvase Pl.  
 LEGAL DESCRIPTION LOT NO. 1 BLOCK \_\_\_\_\_  
 TRACT 7980  
 SIZE OF LOT 50 X 90 NO. OF BLDGS. NOW ON LOT 2  
 USE OF EXISTING BLDG. Store NO. OF FAMILIES \_\_\_\_\_ NO. OF ROOMS 3

BLDG. SETBACK LINE 45' E DIST. NO. 2776  
 APPROVED BY \_\_\_\_\_ DATE 2-28-50  
 USE ZONE C-2 APPROVED BY M. Marcollet DATE 2-28-50

CORRECTIONS

3-2-50 - see note attached  
revised drawings - to correct  
details shown in drawings

DESCRIPTION OF WORK

NEW \_\_\_\_\_ ALTERATION  ADDITION \_\_\_\_\_  
 REPAIR \_\_\_\_\_ MOVING \_\_\_\_\_ DEMOLISH \_\_\_\_\_  
 SQ. FT. \_\_\_\_\_ NO. OF ROOMS \_\_\_\_\_ STORIES \_\_\_\_\_  
 WALL COVERING \_\_\_\_\_ ROOF COVERING \_\_\_\_\_  
 USE OF NEW BUILDING NEW FRONT INSTALLED  
IN PRESENT BLDG. FOR  
CAR SHOW ROOM.  
- DISPLAYING ONLY -  
Manufacturer's Details.

I HEREBY ACKNOWLEDGE THAT I HAVE READ THIS APPLICATION AND STATE THAT THE ABOVE IS CORRECT AND AGREE TO COMPLY WITH ALL COUNTY ORDINANCES AND STATE LAWS REGULATING BUILDING CONSTRUCTION.

SIGNATURE OF PERMITTEE V.E. DeHaven  
 AUTHORIZED AGT. \_\_\_\_\_

APPROVALS

FOUNDATIONAL LOCATION - FERMS, MATERIALS	INSPECTOR	DATE
FRAME: FIRE STOPS, BRACING, BOLTS	<u>5/1/50</u>	<u>3-9-50</u>
LATH. INT.		
LATH. EXT.		
PLASTER. INT.		
PLASTER. EXT.		
FINAL		<u>4-9-50</u>

ORIGINAL

78408A-3 7-49 \$ 500.00  
 VALUATION

P.C.B. \_\_\_\_\_  
 FEE \_\_\_\_\_  
 FEE 3.50

DEPARTMENT OF BUILDING AND SAFETY  
 COUNTY OF LOS ANGELES  
 Wm. J. FOX, CHIEF ENGINEER

APPLICATION FOR PERMIT  
**BUILDING**

1

NO. OF PLANS <input checked="" type="checkbox"/>		B.D.C. RETRACK LINE APPROVED BY DATE 2716		ORD. NO.	DISTRICT NO. 9	PLAN CK. NO.	PERMIT NO. A-1727
FIRE ZONE		APPROVED BY DATE			RECEIVED BY <i>M...</i>	DATE OF APPL. 5-13-42	DATE ISSUED
USE ZONE		APPROVED BY DATE		<b>APPLICANT FILL IN HEAVILY OUTLINED PORTION ONLY</b>			
ARCHITECT OR ENGINEER	NAME			BUILDING ADDRESS 9176-Sunset			
	ADDRESS			LOCALITY SW. Hill			
	CITY			NEAREST CROSS ST. 10th			
CONTRACTOR	STATE LICENSE NO.			OWNER NAME S. S. ...			
	NAME			MAIL ADDRESS P.O. Box 238			
	ADDRESS			CITY ...			
LEGAL DESCRIPTION	LOT NO. 1		SIZE OF LOT 44. x 50		I HEREBY ACKNOWLEDGE THAT I HAVE READ THIS APPLICATION AND STATE THAT THE ABOVE IS CORRECT AND AGREE TO COMPLY WITH ALL COUNTY ORDINANCES AND STATE LAWS REGULATING BUILDING CONSTRUCTION.		
	BLOCK		NO. OF BLDGS. NOW ON LOT 1				
	TRACT 7580						
USE OF BLDG. NOW ON LOT		DESCRIPTION OF WORK		SIGNATURE OF OWNER <i>A. D. ...</i>			
USE OF BUILDING		PARTITION & PART in door (inside)		AUTHORIZED AGY. <i>...</i>			
NEW		TYPE <input checked="" type="checkbox"/>		CORRECTIONS			
ALTERATION		NO. OF ROOMS		LOCKED - COULD NOT CHECK			
ADDITION		SIZE		...			
REPAIR		STORIES		...			
MOVING		WALL COVERING		...			
DEMOLISH		ROOF COVERING		...			
VALUATION \$ 75 <sup>00</sup>		P.C.C. <input checked="" type="checkbox"/>		<b>FINAL APPROVAL</b>			
		P.L. \$ 1.50					
		P.R. \$ 1.50		DATE		INSPECTOR'S NAME	

ORIGINAL

DEPARTMENT OF COUNTY ENGINEER  
 DIVISION OF BUILDING AND SAFETY  
 COUNTY OF LOS ANGELES  
 WILLIAM J. FOX, COUNTY ENGINEER  
 CASBATT D. GRIFFIN, SUPT OF BUILDING

# BUILDING

APPLICATION

1

FOR APPLICANT TO FILL IN				FOR OFFICE USE ONLY			
BUILDING ADDRESS	9176 SUNSET BLVD			DISTRICT NO.	PLAN OR REC. NO.	PERMIT NO. E135503	
LOCALITY	W. HOLLYWOOD			RECEIVED BY	DATE OF APPL.	DATE ISSUED	
NEAREST CROSS ST.	CARY			FIELD NO.	9176 Sunset Blvd		
OWNER	CHAS H. HOENBERG			LOCALITY	W. Hollywood		
MAIL ADDRESS	9176 SUNSET BLVD			NEAREST CROSS ST.	CARY		
CY. L.R.	TEL. NO.			FIRE ZONE	NO. OF FLOORS	TYPE	GROUP
ARC VECTOR ENDS	TEL. NO.			BLDG. SETBACK LINE	None		CRD. NO.
ADDRESS				USE ZONING	APPROVED BY	DATE	
CONTRACTOR	TEL. NO.			HOURS NUMBERING			
ADDRESS	OWNER			MAP NUMBER	9302 NO. ASSIGNED BY		
LEGAL DESCRIPTION	LOT NO.	BLOCK		CORRECTIONS			
TRACT	7980						
SIZE OF LOT	55X100	NO. OF BLDGS. NOW ON LOT	2	ORIGINAL			
USE OF EXISTING BLDG.	OFF & SHOW ROOM	NO. OF FAMILIES	-				
DESCRIPTION OF WORK							
NEW	ALTERATION	<input checked="" type="checkbox"/> ADDITION					
REPAIR	DEMOLITION						
SO. FT. ST.	80	NO. OF FLOORS	1				
EXT. WALL COVERING	STEEL	ROOF COVERING	CONCRETE				
USE OF STRUCTURE	ERECT PARTITION						
FOR KITCHEN. INSTALL WINDOWS.							
I HEREBY ACKNOWLEDGE THAT I HAVE READ THIS APPLICATION AND STATE THAT THE INFORMATION GIVEN IS CORRECT.							
I AGREE TO COMPLY WITH ALL COUNTY ORDINANCES AND STATE LAWS REGULATING BUILDING CONSTRUCTION.							
SIGNATURE OF PERMITTEE	[Signature]						
ADDRESS							
AUTHORIZED AGT.							
VALUATION	500.00	P. C. R. FEE	-				
		FEE	400				
APPROVALS							
INSPECTOR'S SIGNATURE DATE							
FOUNDATION: LOCATION FORMS, MATERIALS	[Signature]						
FRAMES: FIRE STOPS, BRACING, BOLTS	[Signature]						
FURNISH: LOCATION, CAS FEM, DUCTS	[Signature]						
LATH. INT.	[Signature]						
LATH. EXT.	[Signature]						
PLASTER. INT.	[Signature]						
PLASTER. EXT.	[Signature]						
HOUSE NUMBER CORRECT AND POSTED	[Signature]						
FINAL	[Signature]						



# APPLICATION FOR BUILDING PERMIT

COUNTY OF LOS ANGELES  
 DEPARTMENT OF COUNTY ENGINEER  
 BUILDING AND SAFETY DIVISION  
 JOHN A. LAMBIE, COUNTY ENGINEER  
 COLEMAN W. JENKINS, SUPT OF BUILDING

ASSESSOR MAP BOOK	PAGE	PARCEL
BUILDING ADDRESS	9176 Sunset Blvd	
LOCALITY	W. Hollywood	
NEAREST CROSS ST	City	
DISTRICT NO.	GROUP	TYPE CONSTR.
5	F-1	I
STATISTICAL CLASSIFICATION	CLASS NO.	SEWER MAP
	22 DOWELL UNITS	BK PG
USE ZONE	MAP NO.	SPECIAL CONDITIONS
CR	4305	

FOR APPLICANT TO FILL IN  
(Print or type only)

BUILDING ADDRESS **9176 SUNSET BLVD**

LOT NO. **1** BLOCK **-**

TRACT **7980**

SIZE OF LOT **55 x 100** NO. OF BLDGS. NOW ON LOT **2**

USE OF EXISTING BLDG. OFF. + SHOW ROOM

OWNER **CHARLES F. HARNBURGER** TEL. NO. **GR 6-6461**

ADDRESS **624 NINES ROAD**

CITY **LOS ANGELES**

ARCHITECT OR ENGINEER \_\_\_\_\_ TEL. NO. \_\_\_\_\_

ADDRESS \_\_\_\_\_

CONTRACTOR **KIRKMAN GRASS** TEL. NO. **EX 9-3257**

ADDRESS **2402 KIRKMAN BLVD** LIC. NO. \_\_\_\_\_

CITY **SANTA MONICA** LIC. CLASS \_\_\_\_\_

CONSTRUCTION LENDER NAME AND BRANCH **HOME**

ADDRESS \_\_\_\_\_

NO. OF STORIES **1 1/2** NO. OF FAMILIES \_\_\_\_\_ NEW

USE OF STRUCTURE **Replace 1012** ADD

**POWER ON BROKEN GLASS** ALTER

SIGNATURE OF APPLICANT \_\_\_\_\_ REPAIR

DEMOL

VALUATION \$ **100 -**

P.C. FEE \$ \_\_\_\_\_

PMT. FEES **4 00**

I HEREBY ACKNOWLEDGE THAT I HAVE READ THIS APPLICATION AND STATE THAT THE ABOVE IS CORRECT AND AGREE TO COMPLY WITH ALL ORDINANCES AND LAWS REGULATING BUILDING CONSTRUCTION. I CERTIFY THAT IN DOING THE WORK AUTHORIZED HEREBY I WILL NOT EMPLOY ANY PERSON IN VIOLATION OF THE LABOR CODE OF THE STATE OF CALIFORNIA IN RELATION TO WORKMEN'S COMPENSATION INSURANCE.

SIGNATURE OF PERMITTEE **[Signature]**

ADDRESS \_\_\_\_\_

BLDG. SETBACK FROM FRONT PROP. LINE OF \_\_\_\_\_ (STREET)

TYPE OF EXISTING HIGHWAY	WIDTH	SETRBACK FROM C.L.	HIGHWAY	YARD	TOTAL

BLDG. SETBACK FROM SIDE PROP. LINE OF \_\_\_\_\_ (STREET)

TYPE OF EXISTING HIGHWAY	WIDTH	SETRBACK FROM C.L.	HIGHWAY	YARD	TOTAL

CORNER CUTOFF YES  NO

SEE REVERSE SIDE FOR SPECIAL APPROVALS

**ok to replace 1/4 plate glass w/ same type as existing glass per Sec. int (e)**

APPROVALS	DATE	INSPECTOR'S SIGNATURE
FOUNDATION: LOCATION, FORMS, MATERIALS		
FRAME: FIRE STOPS, BRACING, JOISTS		
FURNACE: LOCATION, GAS VENT, DUCTS		
LATH, INT.		
LATH, EXT.		
HOUSE NUMBER CORRECT AND POSTED		
FINAL	<b>2/25/71</b>	<b>[Signature]</b>

JOHN F. LEWIS, PRINCIPAL STRUCTURAL ENGINEER  
 PERMIT VALIDATION

PLAN CHECK VALIDATION CA. NO. CASH

LACD 2588 FEB 19 1 400

**[Signature]**

INSPECTOR COPY



DEPARTMENT OF BUILDING  
COUNTY OF LOS ANGELES

APPLICATION FOR PERMIT  
BUILDING

1

PLANS FILED 726	BLDG. ZONE C2	FIRE ZONE -	DISTRICT NO. 9	PLAN CHG. FEE RECEIPT NO.	PERMIT NO. 32557
TYPE OF BLDG. I II III IV <b>V</b> *	GROUP F	DATE OF APPL. 8-15-36	RECEIVED BY Branlow	DATE ISSUED 8-15-36	
BLDG. SETBACK LINE - - - - -			ORD. NO.		

APPLICANT FILE IN HEAVILY OUTLINED PORTION ONLY

ARCHITECT OR ENGINEER	NAME <i>Overton</i>	BUILDING ADDRESS 9174 Overton Rd
	ADDRESS	LOCALITY West Hollywood
	CITY	NEAREST CROSS ST. Crosby
CONTRACTOR	STATE LICENSE NO.	TEL. NO.
	NAME <i>Overton</i>	NAME Arthur S. Overton
	ADDRESS	MAIL ADDRESS 19176 1/4 Sunset
CITY	STATE LICENSE NO.	TEL. NO.
LOCAL DESCRIP	LOT 1	SIZE OF LOT
	BLOCK 7920	NO. OF BLDGS. NOW ON LOT
	TRACT	USE OF BLDG. NOW ON LOT

**CLASS OF WORK**

NEW	ADDITION	DENOLISH
ALTERATION	REPAIR	MOVING
USE OF BLDG. <i>Common Store</i>	NO. OF ROOMS	NO. OF FAMILIES
SIZE OF BLDG.	STORIES	

**DESCRIPTION OF WORK**  
*2nd floor to 1st floor height*

**SPECIFICATIONS**

**FOUNDATION**

MATERIAL	EXTERIOR	PIERS
THICKNESS - TOP		
THICKNESS - BOTTOM		
DEPTH IN GROUND		

**SUPERSTRUCTURE**

R. W. PLATES (GILL)	FACE	SPACING	SPAN
GIRDERS			
JOISTS - FLOOR			
JOISTS - CEILING			
BEARING WALLS			
PARTITIONS			
ROOF RAFTERS			
WALL BOLTS			

**CORRECTIONS**

*[Handwritten signature]*

**COVERING**

WALL	ROOF
------	------

I HEREBY ACKNOWLEDGE THAT I HAVE READ THIS APPLICATION AND STATE THAT THE ABOVE IS CORRECT AND AGREE TO COMPLY WITH ALL COUNTY ORDINANCES AND STATE LAWS REGULATING BUILDING CONSTRUCTION.

SIGN: *A. D. Overton*  
OWNER OR AUTHORIZED AGENT

**FINAL APPROVAL**

*[Handwritten signature]*

VALUATION \$ <i>125.00</i>	FEE \$ <i>2.00</i>	DATE <i>8-15-36</i>	INSPECTOR'S NAME <i>[Signature]</i>
----------------------------	--------------------	---------------------	-------------------------------------

ORIGINAL



DEPARTMENT OF BUILDING  
COUNTY OF LOS ANGELES

APPLICATION FOR PERMIT  
BUILDING

1

PLANS FILED <input checked="" type="checkbox"/>	BLDG. ZONE C-2	FIRE ZONE -	DISTRICT NO. 9	PLAN CHG. FEE RECEIPT NO.	PERMIT NO. 17692
TYPE OF BLDG. I G III IV <input checked="" type="checkbox"/> V	GROUP F		DATE OF APPL. 7/2/35	RECEIVED BY Temple	DATE ISSUED 7/9/35
BLDG. SETBACK LINE					

APPLICANT FILL IN HEAVILY OUTLINED PORTION ONLY

ARCHITECT OR ENGINEER

NAME \_\_\_\_\_

ADDRESS \_\_\_\_\_

CITY \_\_\_\_\_

STATE LICENSE NO. \_\_\_\_\_ TEL. NO. \_\_\_\_\_

CONTRACTOR

NAME E. T. Lane

ADDRESS 8325 Inglewood Blvd

CITY L.A.

STATE LICENSE NO. 15963 TEL. NO. \_\_\_\_\_

BUILDING ADDRESS 8176 Sunset

LOCALITY Inglewood

NEAREST CROSS ST. Cedar

OWNER

NAME James S. Richter

MAIL ADDRESS 11540 Cedar Ave

CITY L.A. TEL. NO. \_\_\_\_\_

LEGAL DESCRIP.

LOT 1

SIZE OF LOT 88x45

BLOCK -

NO. OF BLDGS. NOW ON LOT 1

TRACT 7480

USE OF BLDG. NOW ON LOT Millmen

CLASS OF WORK

NEW	ADDITION	DENOLISH
ALTERATION	REPAIR	MOVING

DESCRIPTION OF WORK

Change location of two soundproof

USE OF BLDG. Retail store

SIZE OF BLDG. 40x55

STONIZE

NO. OF FAMILIES -

CORRECTIONS

SPECIFICATIONS FOUNDATION

MATERIAL	EXTERIOR	PIERS
THICKNESS TOP	/	
THICKNESS BOTTOM		
DEPTH IN GROUND		
SUPERSTRUCTURE		
2. W. PLATES (SILL)	SIZE	SPACING
GIRDERS	/	
JOISTS FLOOR		
JOISTS CEILING		
BEARING WALLS		
PARTITIONS		
ROOF RAFTERS		
SILL BOLTS		
COVERING		
WALL	ROOF	

I HEREBY ACKNOWLEDGE THAT I HAVE READ THIS APPLICATION AND STATE THAT THE ABOVE IS CORRECT AND AGREE TO COMPLY WITH ALL COUNTY ORDINANCES AND STATE LAWS REGULATING BUILDING CONSTRUCTION.

SIGN *E. T. Lane*  
OWNER OR AUTHORIZED AGENT

FINAL APPROVAL

*[Signature]*

INSPECTOR'S NAME

VALUATION \$ 0.00

FEES \$ 1.00

DATE 7/2/35

ORIGINAL

DEPARTMENT OF COUNTY ENGINEER  
 DIVISION OF BUILDING AND SAFETY  
 COUNTY OF LOS ANGELES  
 WILLIAM J. FOX, COUNTY ENGINEER  
 CAUSAT D. GIEFFIN, SUPT. OF BUILDING

# BUILDING

APPLICATION

1

FOR APPLICANT TO FILL IN

BUILDING ADDRESS 9176 Sunset Blvd.  
 LOCALITY W. Holly  
 NEAREST CROSS ST. Copy  
 OWNER Chas. H. Harbinger  
 MAIL ADDRESS 9176 Sunset Blvd.  
 CITY L.A. TEL. NO. \_\_\_\_\_  
 ARCHITECT OR ENGINEER \_\_\_\_\_ TEL. NO. \_\_\_\_\_  
 ADDRESS \_\_\_\_\_  
 CONTRACTOR Owner TEL. NO. \_\_\_\_\_  
 ADDRESS \_\_\_\_\_  
 LEGAL DESCRIPTION LOT NO. 1 BLOCK \_\_\_\_\_  
 TRACT 7980  
 SIZE OF LOT 55x100 NO. OF BLDGS. NOW ON LOT 2  
 USE OF EXISTING BLDG. OFF & STORAGE NO. OF FAMILIES \_\_\_\_\_

DESCRIPTION OF WORK

NEW \_\_\_\_\_ ALTERNATION  ADDITION \_\_\_\_\_  
 REPAIR \_\_\_\_\_ DEMOLITION \_\_\_\_\_  
 SQ. FT. SIZE \_\_\_\_\_ NO. OF ROOMS 1 STORIES 1  
 EXT. WALL COVERING Stucco ROOF COVERING Corrug  
 USE OF STRUCTURE \_\_\_\_\_

ALTERATION OF STEEL  
 ROOF & STORE FRONT

I HEREBY ACKNOWLEDGE THAT I HAVE READ THIS APPLICATION AND STATE THAT THE INFORMATION GIVEN IS CORRECT.

I AGREE TO COMPLY WITH ALL COUNTY ORDINANCES AND STATE LAWS REGULATING BUILDING CONSTRUCTION.

SIGNATURE OF PERMITTEE Chas. H. Harbinger

ADDRESS 9176 Sunset Blvd. L.A.

AUTHORIZED AGT. \_\_\_\_\_

VALUATION 1000.00

P.C. = NONE  
 P.E. = NONE  
 P.E. = 5.00

FOR OFFICE USE ONLY

DISTRICT NO. 9W PLAN OR REC. NO. NONE PERMIT NO. 18318  
 RECEIVED BY Chas DATE OF APPL. 5/4/53 DATE ISSUED 5/4/53  
 BUILDING ADDRESS 9176 Sunset Blvd.  
 LOCALITY W. Holly  
 NEAREST CROSS ST. Copy  
 FIRE ZONE \_\_\_\_\_ NO. OF PLANS \_\_\_\_\_ TYPE I GROUP F  
 BLDG. EXTRACUR. LINE None ORD. NO. \_\_\_\_\_  
 USE ZONE C-2 APPROVED BY \_\_\_\_\_ DATE \_\_\_\_\_  
 HOUSE NUMBERING \_\_\_\_\_  
 MAP NUMBER 4303 NO. ASSIGNED BY \_\_\_\_\_  
 CORRECTIONS \_\_\_\_\_

APPROVALS

INSPECTOR'S SIGNATURE DATE

FOUNDATION: LOCATION \_\_\_\_\_  
 FORMS, MATERIALS \_\_\_\_\_  
 FRAME: FIRE STOPP. \_\_\_\_\_  
 BRACING BOLTS \_\_\_\_\_  
 FURNACE: LOCATION \_\_\_\_\_  
 GAS VENT. DUCTS \_\_\_\_\_  
 LATH. INT. \_\_\_\_\_  
 LATH. EXT. \_\_\_\_\_  
 PLASTER INT. \_\_\_\_\_  
 PLASTER EXT. \_\_\_\_\_  
 HOUSE NUMBER CORRECT AND POSTED \_\_\_\_\_  
 FINAL 5/4/53





OFFICE OF THE ENGINEER  
DEPARTMENT OF BUILDING AND SAFETY  
ELECTRICAL DIVISION

Final Request

NOTICE FOR INSPECTION OF  
**ELECTRIC WIRING**

Permit No. \_\_\_\_\_

Electrical District \_\_\_\_\_

Contractor's Name  
*John J. ... Co.*

Contractor's Phone No. *7-2267*

Address  
*1176 ...*

City  
*San Francisco*

State  
*Calif.*

Number of Motors \_\_\_\_\_

Stores \_\_\_\_\_ Apts. \_\_\_\_\_

No. of Circuits	Name of Structure	No.	MOTORS		E.T.C.	
			H.P.	Volts	No.	H.P.

Plan Approved \_\_\_\_\_ Date Permits Granted \_\_\_\_\_

Inspector \_\_\_\_\_

City \_\_\_\_\_

Contract No. \_\_\_\_\_

Blkg. Per. No. \_\_\_\_\_

\_\_\_\_\_

\_\_\_\_\_

\_\_\_\_\_





DEPARTMENT OF BUILDING AND SAFETY  
 COUNTY OF LOS ANGELES  
 W. J. FOX, CHIEF ENGINEER

APPLICATION FOR PERMIT  
**ELECTRIC**

**ELECTRICIAN**

NAME: \_\_\_\_\_  
 ADDRESS: \_\_\_\_\_  
 CITY: \_\_\_\_\_  
 COUNTY LICENSE NO.: \_\_\_\_\_  
 EXPIRES: \_\_\_\_\_

DISTRICT NO. 911 GROUP F ZONE 02 PERMIT NO. 115326  
 RECEIVED BY [Signature] READY FOR FIRST INSPECTION DATE ISSUED 3-7-09

APPLICANT FILL IN HEAVILY OUTLINED PORTION ONLY

**DESCRIPTION OF WORK**

NUMBER OF OUTLETS ON CIRCUITS  
 LOCATION BY ROOMS

CIRCUIT	LIGHT OUTLETS					SW.	PLUGS	SPECIAL
	A	B	C	D	E			
1								
2								
3								
4								
5								
6								
7								
8								
9								
10								
11								
12								
13								
14								
15								
16								
17								
18								
19								
20								
21								
22								
23								
24								
25								
26								
27								
28								
29								
30								
31								
32								
33								
34								
35								
36								
37								
38								
39								
40								
41								
42								
43								
44								
45								
46								
47								
48								
49								
50								
51								
52								
53								
54								
55								
56								
57								
58								
59								
60								
61								
62								
63								
64								
65								
66								
67								
68								
69								
70								
71								
72								
73								
74								
75								
76								
77								
78								
79								
80								
81								
82								
83								
84								
85								
86								
87								
88								
89								
90								
91								
92								
93								
94								
95								
96								
97								
98								
99								
100								

JOB ADDRESS 9176 Laurel  
 LOCALITY Van Nuys  
 NEAREST CROSS ST. Van Nuys  
 OWNER'S NAME [Signature]  
 MAIL ADDRESS [Address]  
 CITY Van Nuys TEL. [Number]

I AM THE LEGAL POSSESSOR OF THE ABOVE FOR ANGELES COUNTY CERTIFICATE OF QUALIFICATION  
 I AM THE LEGAL OWNER OF THE PROPERTY DESCRIBED ABOVE

**CORRECTIONS**

[Handwritten corrections and notes]

NO. OF OUTLETS	5
NO. OF FIXTURES	5
NO. OF MOTORS - H.P.	0
NO. OF SIGNS - TRANS.	0
NO. OF FANES OR HEATERS	0
MISCELLANEOUS	0
PERMIT FEE	0
TOTAL FEE	0

**APPROVALS**

DATE	DISPATCHED BY
CONDUIT	WIRING
FIXTURES	POWER
UTILITY CO. NOTIFIED	FIRE



DEPARTMENT OF BUILDING AND SAFETY  
 COUNTY OF LOS ANGELES  
 WILLIAM L. ZUC, CHIEF ENGINEER

APPLICATION FOR PERMIT  
**ELECTRICAL**

FOR APPLICANT TO FILL IN		DISTRICT NO.	GROUP	ZONE	PERMIT NO.
ELECTRICIAN <u>Stetson Electric Co</u>		<u>900</u>	<u>F</u>	<u>C2</u>	<u>72512</u>
ADDRESS <u>945 Waimanua Blvd</u>		ISSUED BY	READY FOR FIRE INSPECTION		DATE ISSUED
CITY <u>Los Angeles</u> TEL. NO. <u>GL 3166</u>		<u>CM</u>			<u>5/12/53</u>
COUNTY LICENSE NO. <u>5234</u> EXPIRES <u>6-30-53</u>		BUILDING ADDRESS	<u>9176 Sunset Blvd</u>		
<b>PERMIT FEES</b>		LOCALITY	<u>Hollywood</u>		
LIGHT CIRCUITS		NEAREST CROSS ST.	<u>Van Ness</u>		
RECEPTACLES		OWNER	<u>6047 DE R. ROBERTS</u>		
WALL SWITCHES		MAIL ADDRESS	<u>Same</u>		
TOTAL CIRCUITS		CITY	<u>Hollywood</u>		
ELEC. PANELS		TEL. NO.			
ELEC. MOUNTS		I HEREBY CERTIFY THAT I HAVE READ THIS APPLICATION AND BELIEVE THAT THE ABOVE IS COMPLETE AND CORRECT IN ACCORDANCE WITH ALL COUNTY ORDINANCES AND STATE LAWS RELATING TO ELECTRICAL WORKING.			
INSURED		I CERTIFY THAT I AM THE LEGAL OWNER OF THE RESIDENTIAL PROPERTY DESCRIBED ABOVE.			
NEED		APPROVED BY			
NUMBER OF LIGHT CIRCUITS		IDENTITY			
NUMBER OF RECEPTACLE CIRCUITS		<b>INSPECTION RECORD</b>			
<b>MOTORS</b>					
NUMBER	HORSEPOWER	DATE			
NEW	OLD				
	1/2 & LBS				
	2				
	5				
	15				
	30				
	50				
	100				
	200				
	500				
	EVER 1000				
WAS ELECTRICAL CHANGER-HP					
WINDERS AC-EVA					
GENERATORS - CV					
TRANSFORMERS - EVA					
TEMP. METER 175% OF O.M.C.					
MOVING METER 175% OF O.M.C.					
MISC.					
SIGNS					
NO. NO. TRANS.					
NO. NO. CAMPS					
FOR EACH PERMIT					
WIRING					
ELECTRICAL					
SUPPLEMENTARY					
TOTAL FEE					
		<b>APPROVALS</b>			
		DATE			
		INSPECTOR'S SIGNATURE			
		CONDUIT			
		WIRING			
		FIXTURES			
		POWER			
		UTILITY CO. OBTAINED			
		FINAL			

TOTAL FEE

# APPLICATION FOR ELECTRICAL PERMIT

COUNTY OF LOS ANGELES  
 DEPARTMENT OF COUNTY ENGINEER  
 BUILDING AND SAFETY DIVISION  
 JOHN A. LAYRIE, COUNTY ENGINEER  
 WILLIAM A. JET, CH. SUPT. OF BUILDING

BUILDING ADDRESS: 9176 Hollywood Blvd  
 LOCALITY: HO. HOLLYWOOD  
 NEAREST CROSS ST.: POWERS  
 OWNER: CHAS. HOLLYWOOD CO.  
 MAIL ADDRESS: POWERS  
 CITY: HOLLYWOOD, CALIF.  
 ELECTRICIAN: INTERSTATE WIRE CO.  
 ADDRESS: POWERS  
 CITY: HOLLYWOOD, CALIF.  
 STATE LICENSE NO.: 78577

FOR APPLICANT TO FILL IN		NO. TRAC	FEE
RECEPT.	TOTAL OUTLETS	FIRST 20	2.00
		ADD. OVER 20	.10
LIGHT	TOTAL	FIRST 20	2.00
		ADD. OVER 20	.30
SWITCH			2.00
LIGHTING FIXTURES			2.00
RANGES	C.O. OUTLETS	WTR. MTR.	
WASH. DECK	STV. COOK		
DISHWASHER	AUTO. WASH.		50
SPACE HEAT.	ETA. APP. (10. H.P. MAX.)		50
FACTORY	OVER	NOT OVER	N.P.
	0	1	1.00
	1	2	1.50
	2	3	2.00
	3	4	2.50
	4	5	3.00
	5	6	3.50
	6	7	4.00
	7	8	4.50
	8	9	5.00
	9	10	5.50
	10	11	6.00
	11	12	6.50
	12	13	7.00
	13	14	7.50
	14	15	8.00
	15	16	8.50
	16	17	9.00
	17	18	9.50
	18	19	10.00
	19	20	10.50
	20	21	11.00
	21	22	11.50
	22	23	12.00
	23	24	12.50
	24	25	13.00
	25	26	13.50
	26	27	14.00
	27	28	14.50
	28	29	15.00
	29	30	15.50
	30	31	16.00
	31	32	16.50
	32	33	17.00
	33	34	17.50
	34	35	18.00
	35	36	18.50
	36	37	19.00
	37	38	19.50
	38	39	20.00
	39	40	20.50
	40	41	21.00
	41	42	21.50
	42	43	22.00
	43	44	22.50
	44	45	23.00
	45	46	23.50
	46	47	24.00
	47	48	24.50
	48	49	25.00
	49	50	25.50
	50	51	26.00
	51	52	26.50
	52	53	27.00
	53	54	27.50
	54	55	28.00
	55	56	28.50
	56	57	29.00
	57	58	29.50
	58	59	30.00
	59	60	30.50
	60	61	31.00
	61	62	31.50
	62	63	32.00
	63	64	32.50
	64	65	33.00
	65	66	33.50
	66	67	34.00
	67	68	34.50
	68	69	35.00
	69	70	35.50
	70	71	36.00
	71	72	36.50
	72	73	37.00
	73	74	37.50
	74	75	38.00
	75	76	38.50
	76	77	39.00
	77	78	39.50
	78	79	40.00
	79	80	40.50
	80	81	41.00
	81	82	41.50
	82	83	42.00
	83	84	42.50
	84	85	43.00
	85	86	43.50
	86	87	44.00
	87	88	44.50
	88	89	45.00
	89	90	45.50
	90	91	46.00
	91	92	46.50
	92	93	47.00
	93	94	47.50
	94	95	48.00
	95	96	48.50
	96	97	49.00
	97	98	49.50
	98	99	50.00
	99	100	50.50
	100		

DISTRICT NO. 7 GROUP 5 ZONE 1 PROCESSED BY [Signature]  
 INSPECTION RECORD

I HEREBY ACKNOWLEDGE THAT I HAVE READ THIS APPLICATION AND STATE THAT THE ABOVE IS CORRECT AND AGREE TO COMPLY WITH ALL COUNTY ORDINANCES AND STATE LAWS REGULATING ELECTRICAL WIRING.  
 I HEREBY CERTIFY THAT I AM PROPERLY REGISTERED AND/OR LICENSED AS REQUIRED BY LOS ANGELES COUNTY AND STATE OF CALIFORNIA OR THAT I AM THE LEGAL OWNER OF THE ABOVE DESCRIBED RESIDENTIAL PROPERTY.  
 SIGNATURE: [Signature]  
 DATE: [Date]

APPROVAL	DATE	INSPECTOR'S SIGNATURE
CONDUIT		
WIRING		
FIXTURES		
POWER		
UTILITY CO. NOTIFIED		
FINAL		

ARTHUR C. VEIT  
 SUPERVISING ELECTRICAL ENGINEER

NO. 1576-2

400-1







DEPARTMENT OF BUILDING AND SAFETY  
 COUNTY OF LOS ANGELES  
 Wm. J. FOX CHIEF ENGINEER

APPLICATION FOR PERMIT  
**PLUMBING**

**NATURE OF INSTALLATION**

ROUGH	FIXTURES	COMPLETE
HEATER	CESSPOOL	SEPTIC TANK
GAS	MISCELLANEOUS	

DISTRICT NO. 0 GROUP 1 ZONE 1 PERMIT NO. 130

RECEIVED BY [Signature] READY FOR FIRST INSPECTION DATE ISSUED 10-20-50

**APPLICANT FILL IN HEAVILY OUTLINED PORTION ONLY**

PLUMBER NAME H E BURT

ADDRESS 7524 Sunset Blvd

CITY Los Angeles TEL. NO. Gr 1-36

COUNTY 625 N OFFICE 12/31/50

JOB ADDRESS 9175 Sunset Blvd

LOCALITY [Blank]

NEAREST CROSS ST. [Blank]

PLUMBER NAME Mr. A E Saercher

MAIL ADDRESS 9175 1/2 Sunset Blvd

CITY Los Angeles TEL. NO. GR 10202

**LOCATION OF SEPTIC TANK, OR CESSPOOL**

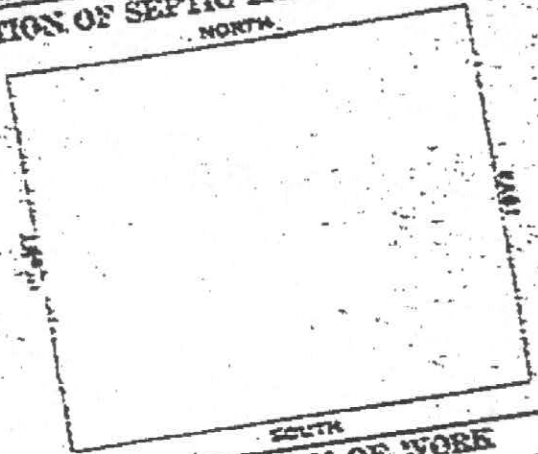

I AM THE LEGAL POSSESSOR OF THE ABOVE LOS ANGELES COUNTY CERTIFICATE OF QUALIFICATION

I AM THE LEGAL OWNER OF THE PROPERTY DESCRIBED ABOVE.

OWNER [Signature]

- DESCRIPTION OF WORK**
- |   |  |
|---|--|
| <input type="checkbox"/> BATH TUB         | <input type="checkbox"/> FURNACE           |
| <input type="checkbox"/> SHOWER           | <input type="checkbox"/> DISHWASHER        |
| <input type="checkbox"/> LAVATORY         | <input type="checkbox"/> REFRIGERATOR      |
| <input type="checkbox"/> KITCHEN SINK     | <input type="checkbox"/> WATER SOFTENER    |
| <input type="checkbox"/> FLOOR SINK       | <input type="checkbox"/> SAND TRAP         |
| <input type="checkbox"/> SLOP SINK        | <input type="checkbox"/> FLOOR DRAIN       |
| <input type="checkbox"/> WASH TRAY        | <input type="checkbox"/> URINAL            |
| <input type="checkbox"/> WATER CLOSET     | <input type="checkbox"/> DRINKING FOUNTAIN |
| <input type="checkbox"/> WATER HEATER     | <input type="checkbox"/> DENTAL LAVATORY   |
| <input type="checkbox"/> WATER GAS OUTLET | <input type="checkbox"/> SODA FOUNTAIN     |

TOTAL NUMBER OF FIXTURES 1

CESSPOOL 1 SEPTIC TANK 1

TOTAL FEE [Blank]

**CORRECTIONS**

1. Change to 1/2" pipe

2. Change to 1/2" pipe

3. Change to 1/2" pipe

4. Change to 1/2" pipe

5. Change to 1/2" pipe

**APPROVALS**

	DATE	INSPECTOR'S NAME
ROUGH PLUMBING		
GAS PIPING		
GAS LINE		
CESSPOOL		
SEPTIC TANK		
SEWER		
UTILITY CO. NOTIFIED		
FINAL		

ORIGINAL