

APPENDIX K

Alternative 2 Subterranean Floor Plans

LANDSCAPE ARCHITECT
 AHBE Landscape Architects
 617 West Seventh St, Suite 304
 Los Angeles, CA 90017
 P: 213 694 3801
 F: 213 694 3801
 E: cabei@ahbe.com

LIGHTING DESIGN
 Horton, Lees, Brogden Lighting Design
 6580 Washington Blvd.
 Culver City, CA 90232
 P: 310 837 0929
 F: 310 837 0902
 E: taghassian@hblighting.com

STRUCTURAL
 Englekirk
 888 S. Figueroa Street, 18th Floor
 Los Angeles, CA 90017
 P: 323.733.6673
 E: vladimk.volnyy@englekirk.com

ROBERTSON LANE
 645-681 N. Robertson Boulevard and 648-668 N. La Peer Drive.
 West Hollywood, CA 90069

Faring Capital // Jason Moulton, Managing Partner
 8899 Beverly Blvd., Suite 716 West Hollywood, CA 90048
 P: 310-995-7399 E: jason@faringcapital.com

HODGETTS + FUNG
 DESIGN AND ARCHITECTURE

hplusf
 5837 Adams Blvd.
 Culver City, CA 90232
 323.937.2150
 mailbox@hplusf.com



The designs, details and specifications contained in this drawing are confidential. The recipients of this drawing hereby acknowledge and agree that it is the sole property of Hodgetts + Fung and that they shall neither use nor reveal any of the designs, details and specifications contained in this drawing outside of the contractual agreement expressed within permission from Hodgetts + Fung.

Deviations from this drawing shall not be made without consulting Hodgetts + Fung. In case of discrepancies between drawings, specifications, and details included in contract documents, Hodgetts + Fung shall decide which instruction must be followed and their decision shall be final.

Copyright Hodgetts + Fung Design and Architecture.
 All rights reserved.

MARK	DATE	DESCRIPTION
	08.28.15	DEVELOPMENT REVISIONS
	08.12.16	DEVELOPMENT REVISIONS

PROJECT NO.	1330
SUBMISSION	DEVELOPMENT PERMIT
SUB. DATE	08.15.14
SCALE	1/16" = 1'-0"
DRAWN BY	DV
CHECKED BY	CHK
SHEET SIZE	30" x 40"
DRAWING TITLE	LEVEL P5 PLAN
DRAWING NO.	A-2.00

Copyright Hodgetts + Fung Design and Architecture. Deviations from this drawing will not be made without their expressed written permission.

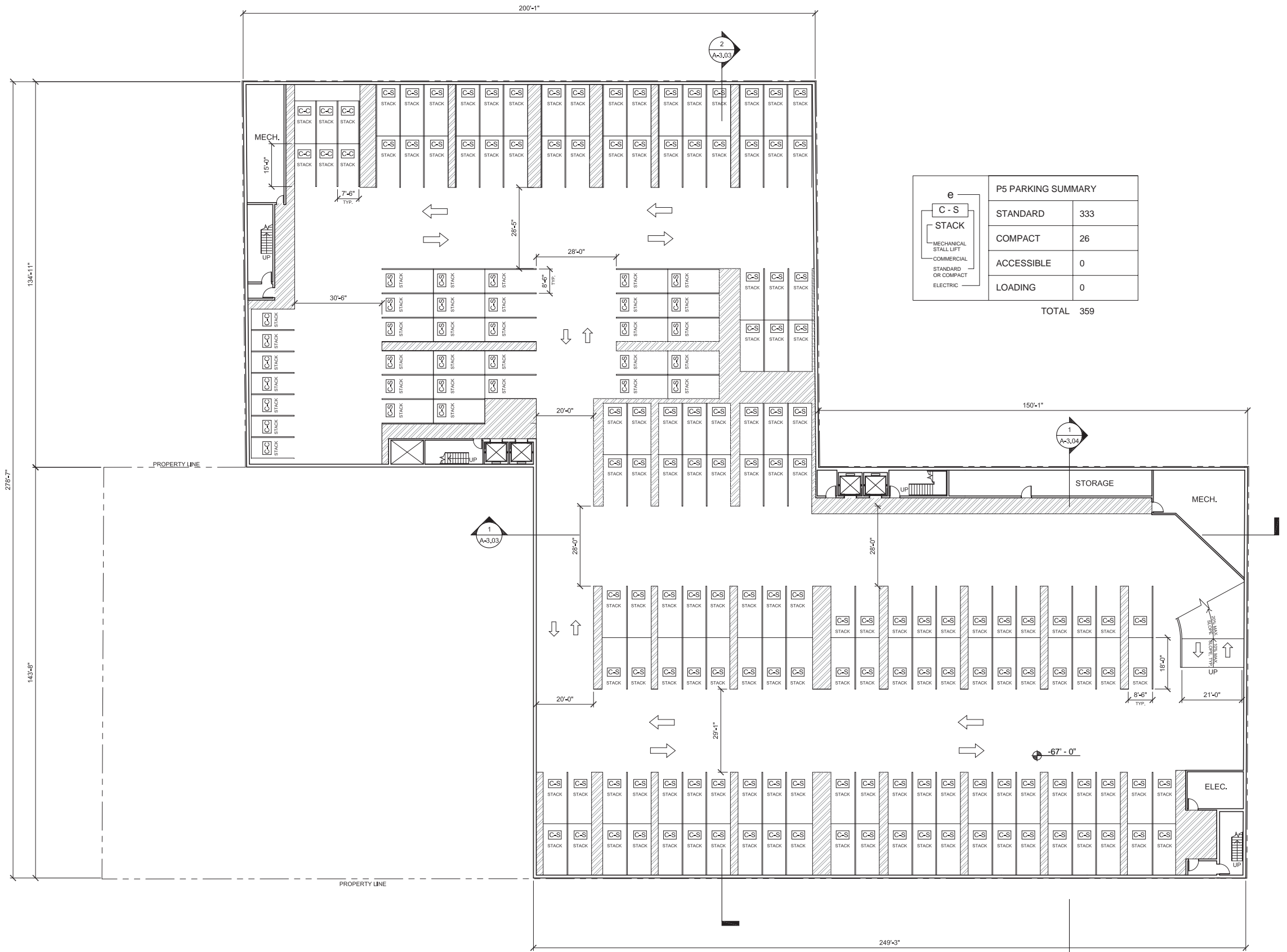

P5 PARKING SUMMARY	
STANDARD	333
COMPACT	26
ACCESSIBLE	0
LOADING	0
TOTAL	359



LANDSCAPE ARCHITECT
 AHBE Landscape Architects
 617 West Seventh St, Suite 304
 Los Angeles, CA 90017
 P: 213 694 3801
 F: 213 694 3801
 E: cabei@ahbe.com

LIGHTING DESIGN
 Horton, Lees, Brogden Lighting Design
 6580 Washington Blvd.
 Culver City, CA 90232
 P: 310 837 0929
 F: 310 837 0929
 E: taghassian@hblighting.com

STRUCTURAL
 Englekirk
 888 S. Flgueroa Street, 18th Floor
 Los Angeles, CA 90017
 P: 323.733.6673
 E: vladimk.volnyy@englekirk.com

ROBERTSON LANE
 645-681 N. Robertson Boulevard and 648-668 N. La Peer Drive.
 West Hollywood, CA 90069

Faring Capital // Jason Moulton, Managing Partner
 8899 Beverly Blvd., Suite 716 West Hollywood, CA 90048
 P: 310-995-7399 E: jason@faringcapital.com

HODGETTS + FUNG
 DESIGN AND ARCHITECTURE
hplusf
 5837 Adams Blvd.
 Culver City, CA 90232
 3 2 3 . 9 3 7 . 2 1 5 0
 mailbox@hplusf.com



The designs, details and specifications contained in this drawing are confidential. The recipients of this drawing hereby acknowledge and agree that it is the sole property of Hodgetts + Fung and that they shall neither use nor reveal any of the designs, details and specifications contained in this drawing, outside of the contractual agreement expressed without permission from Hodgetts + Fung.

Deviations from this drawing shall not be made without consulting Hodgetts + Fung. In case of discrepancies between drawings, specifications, and details included in contract documents, Hodgetts + Fung shall decide which deviation must be followed and their decision shall be final.

Copyright Hodgetts + Fung Design and Architecture.
 All rights reserved.

MARK	DATE	DESCRIPTION
	08.28.15	DEVELOPMENT REVISIONS
	08.12.16	DEVELOPMENT REVISIONS

PROJECT NO.	1330
SUBMISSION	DEVELOPMENT PERMIT
SUB. DATE	08.15.14
SCALE	1/16" = 1'-0"
DRAWN BY	DV
CHECKED BY	CHK
SHEET SIZE	30" x 40"
DRAWING TITLE	LEVEL P4 PLAN
DRAWING NO.	A-2.01

Copyright Hodgetts + Fung Design and Architecture. Deviations from this drawing will not be made without their expressed written permission.

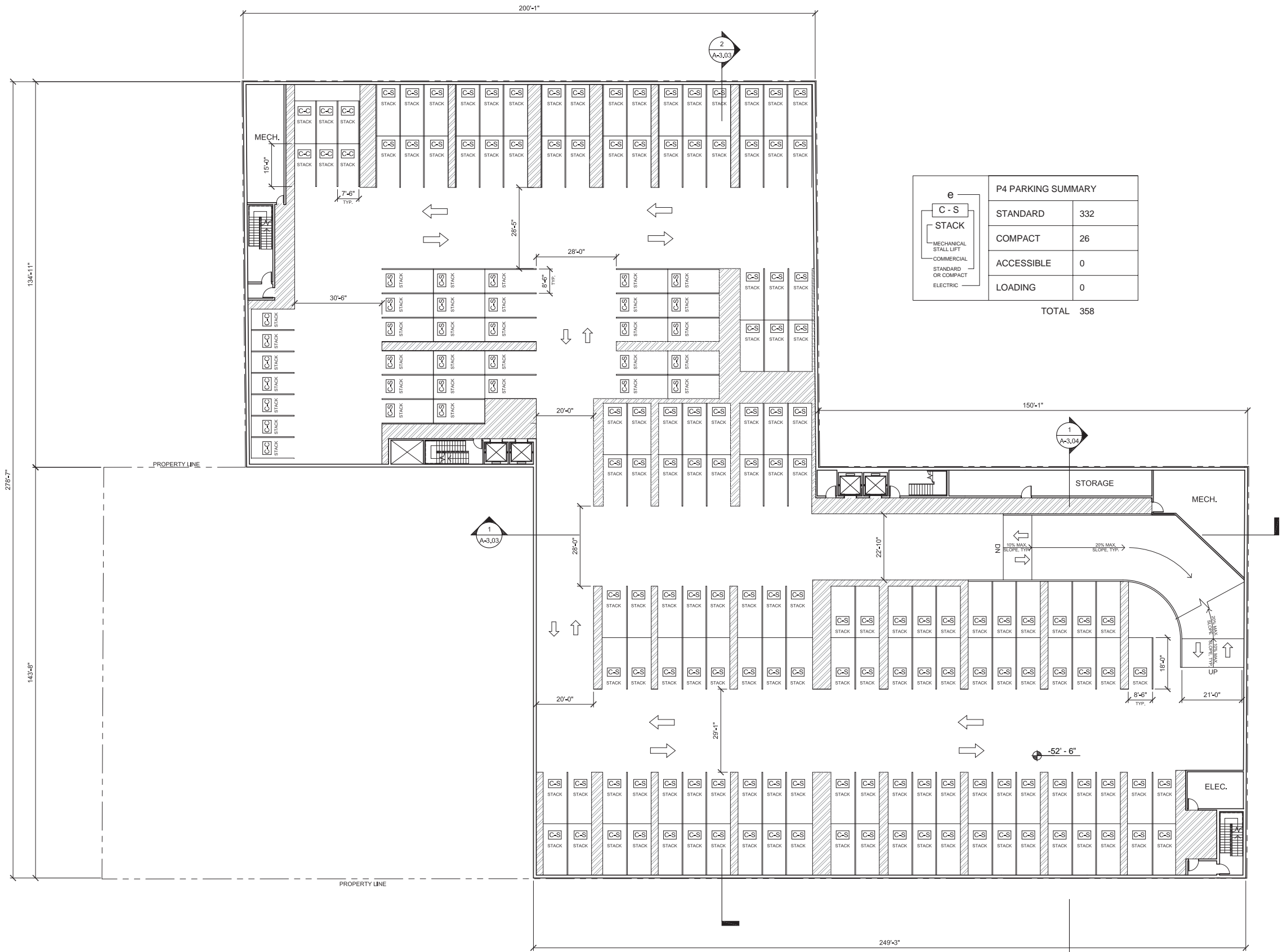

LANDSCAPE ARCHITECT
 AHBE Landscape Architects
 617 West Seventh St, Suite 304
 Los Angeles, CA 90017
 P: 213 694 3800
 F: 213 694 3801
 E: cabei@ahbe.com

LIGHTING DESIGN
 Horton, Lees, Brogden Lighting Design
 6580 Washington Blvd.
 Culver City, CA 90232
 P: 310 837 0929
 F: 310 837 0902
 E: taghassan@hblighting.com

STRUCTURAL
 Englekirk
 888 S. Figueroa Street, 18th Floor
 Los Angeles, CA 90017
 P: 323.733.6673
 E: vladimk.volnyy@englekirk.com

ROBERTSON LANE
 645-681 N. Robertson Boulevard and 648-668 N. La Peer Drive.
 West Hollywood, CA 90069

Faring Capital // Jason Moulton, Managing Partner
 8899 Beverly Blvd., Suite 716 West Hollywood, CA 90048
 P: 310-995-7399 E: jason@faringcapital.com

HODGETTS + FUNG
 DESIGN AND ARCHITECTURE
hplusf
 5837 Adams Blvd.
 Culver City, CA 90232
 3 2 3 . 9 3 7 . 2 1 5 0
 mailbox@hplusf.com



The designs, details and specifications contained in this drawing are confidential. The recipients of this drawing hereby acknowledge and agree that it is the sole property of Hodgetts + Fung and that they shall neither use nor reveal any of the designs, details and specifications contained in this drawing, outside of the contractual agreement expressed within permission from Hodgetts + Fung.

Deviations from this drawing shall not be made without consulting Hodgetts + Fung. In case of discrepancies between drawings, specifications, and details included in contract documents, Hodgetts + Fung shall decide which instruction must be followed and their decision shall be final.

Copyright Hodgetts + Fung Design and Architecture.
 All rights reserved.

MARK	DATE	DESCRIPTION
	08.20.15	DEVELOPMENT REVISIONS
	08.12.16	DEVELOPMENT REVISIONS

PROJECT NO.	1330
SUBMISSION	DEVELOPMENT PERMIT
SUB. DATE	08.16.14
SCALE	1/16" = 1'-0"
DRAWN BY	DV
CHECKED BY	CHK
SHEET SIZE	30" x 40"
DRAWING TITLE	LEVEL P3 PLAN
DRAWING NO.	A-2.02

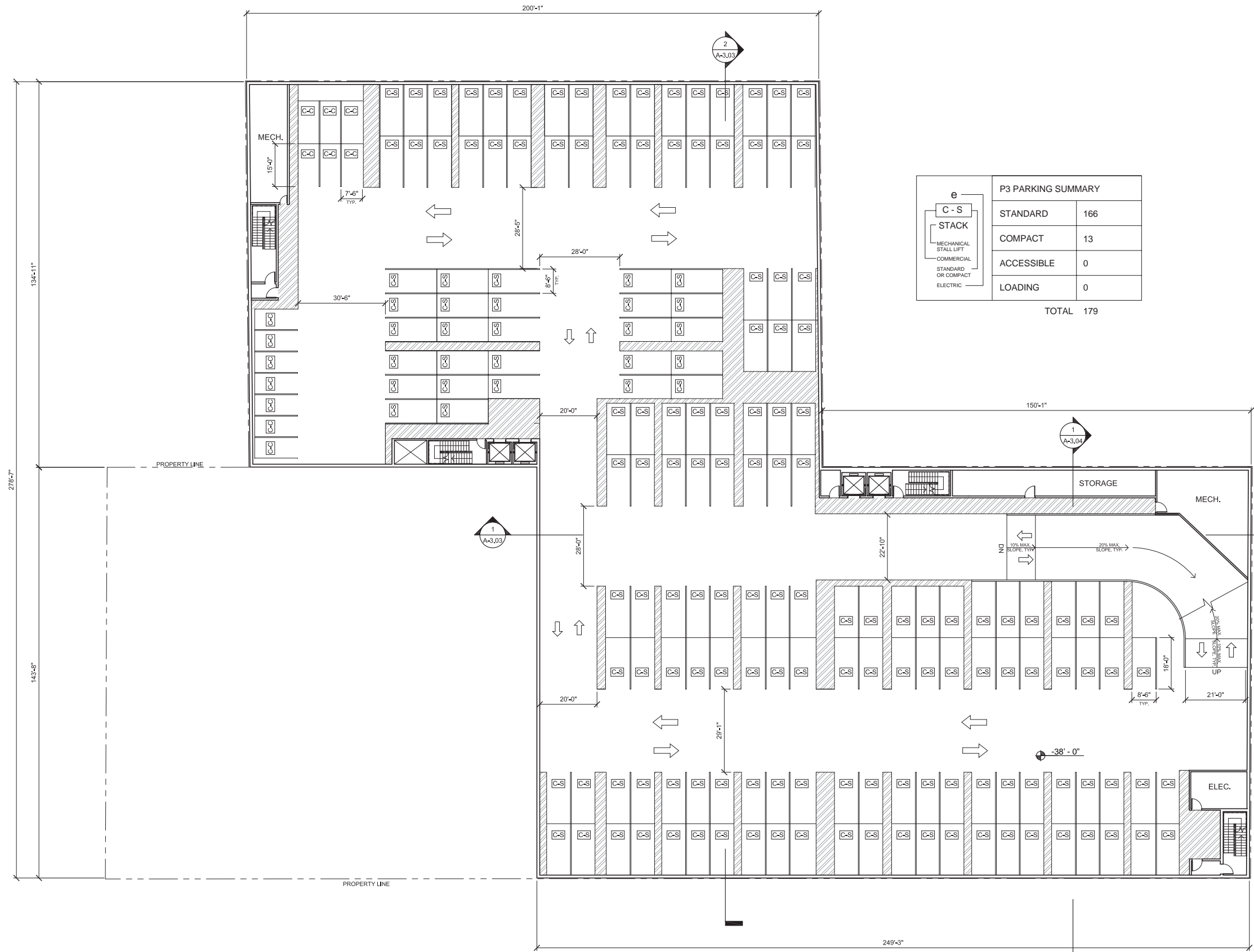

LANDSCAPE ARCHITECT
 AHBE Landscape Architects
 617 West Seventh St, Suite 304
 Los Angeles, CA 90017
 P: 213 694 3800
 F: 213 694 3801
 E: cabei@ahbe.com

LIGHTING DESIGN
 Horton, Lees, Brogden Lighting Design
 6580 Washington Blvd.
 Culver City, CA 90232
 P: 310 837 0929
 F: 310 837 0902
 E: taghassian@hblighting.com

STRUCTURAL
 Englekirk
 888 S. Figueroa Street, 18th Floor
 Los Angeles, CA 90017
 P: 323.733.6673
 E: vladimk.volnyy@englekirk.com

ROBERTSON LANE
 645-681 N. Robertson Boulevard and 648-668 N. La Peer Drive.
 West Hollywood, CA 90069

Faring Capital // Jason Illoulan, Managing Partner
 8899 Beverly Blvd., Suite 716 West Hollywood, CA 90048
 P: 310-995-7399 E: jason@faringcapital.com

HODGETTS + FUNG
 DESIGN AND ARCHITECTURE
hplusf
 5837 Adams Blvd.
 Culver City, CA 90232
 323.937.2150
 mailbox@hplusf.com



The designs, details and specifications contained in this drawing are confidential. The recipients of this drawing hereby acknowledge and agree that it is the sole property of Hodgetts + Fung and that they shall neither use nor reveal any of the designs, details and specifications contained in this drawing, outside of the contractual agreement expressed without permission from Hodgetts + Fung.

Deviations from this drawing shall not be made without consulting Hodgetts + Fung. In case of discrepancies between drawings, specifications, and details included in contract documents, Hodgetts + Fung shall decide which instruction must be followed and their decision shall be final.

Copyright Hodgetts + Fung Design and Architecture.
 All rights reserved.

MARK	DATE	DESCRIPTION
	08.28.15	DEVELOPMENT REVISIONS
	08.12.16	DEVELOPMENT REVISIONS

PROJECT NO.	1330
SUBMISSION	DEVELOPMENT PERMIT
ISS. DATE	08.15.14
SCALE	1/16" = 1'-0"
DRAWN BY	DV
CHECKED BY	CHK SHEET SIZE: 30" x 40"
DRAWING TITLE	LEVEL P2 PLAN
DRAWING NO.	A-2.03

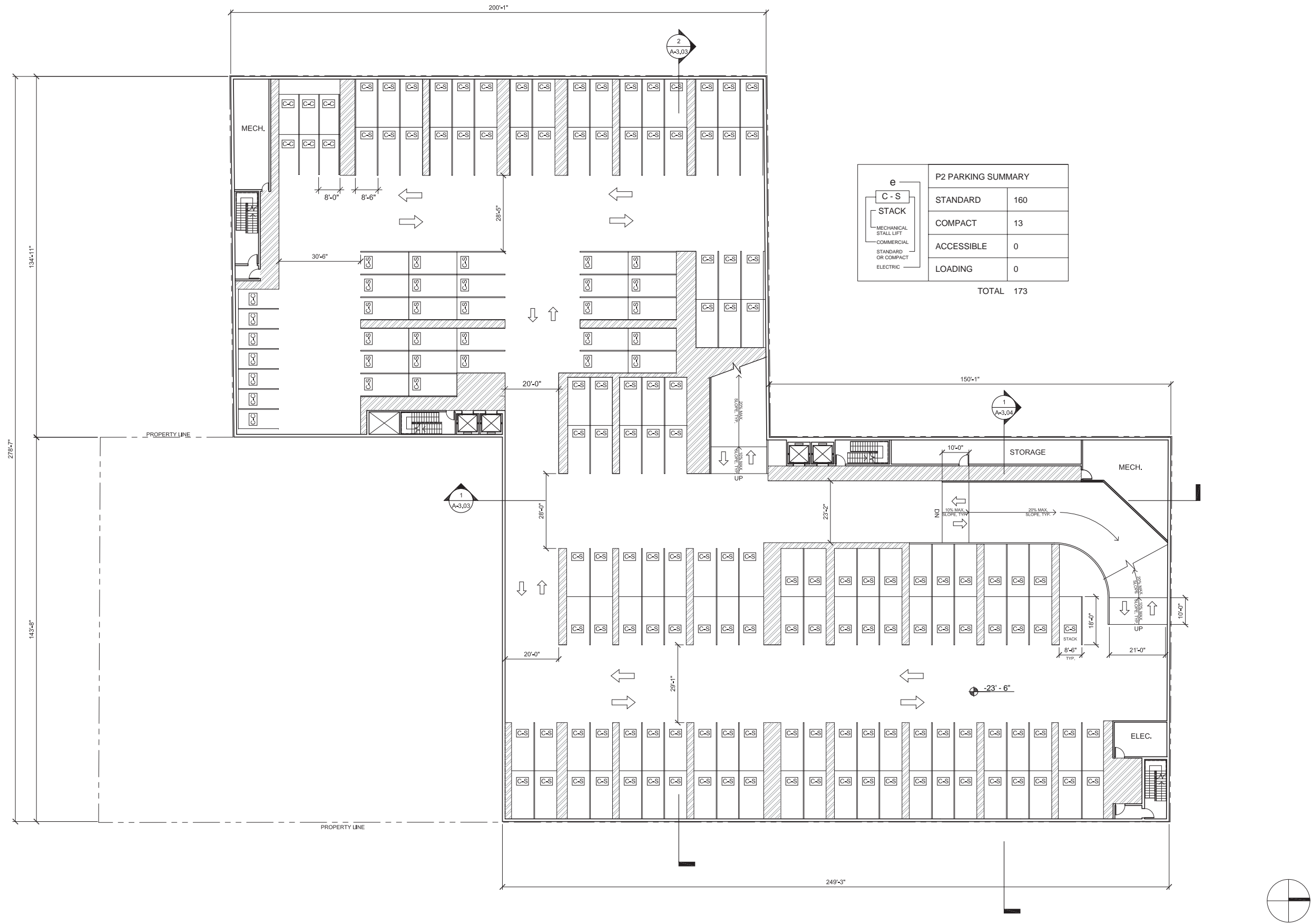

LANDSCAPE ARCHITECT
 AHBE Landscape Architects
 617 West Seventh St, Suite 304
 Los Angeles, CA 90017
 P: 213 694 3800
 F: 213 694 3801
 E: cabei@ahbe.com

LIGHTING DESIGN
 Horton, Lees, Brogden Lighting Design
 6580 Washington Blvd.
 Culver City, CA 90232
 P: 310 837 0929
 F: 310 837 0902
 E: taghassan@hblighting.com

STRUCTURAL
 Englekirk
 888 S. Figueroa Street, 18th Floor
 Los Angeles, CA 90017
 P: 323.733.6673
 E: vladimk.volnyy@englekirk.com

ROBERTSON LANE
 645-681 N. Robertson Boulevard and 648-668 N. La Peer Drive.
 West Hollywood, CA 90069

Faring Capital // Jason Illioulan, Managing Partner
 8899 Beverly Blvd., Suite 716 West Hollywood, CA 90048
 P: 310-995-7399 E: jason@faringcapital.com

HODGETTS + FUNG
 DESIGN AND ARCHITECTURE

hplusf
 5837 Adams Blvd.
 Culver City, CA 90232
 3 2 3 . 9 3 7 . 2 1 5 0
 mailbox@hplusf.com



The designs, details and specifications contained in this drawing are confidential. The recipients of this drawing hereby acknowledge and agree that it is the sole property of Hodgetts + Fung and that they shall neither use nor reveal any of the designs, details and specifications contained in this drawing, outside of the contractual agreement expressed within permission from Hodgetts + Fung.

Deviations from this drawing shall not be made without consulting Hodgetts + Fung. In case of discrepancies between drawings, specifications, and details included in contract documents, Hodgetts + Fung shall decide which instruction must be followed and their decision shall be final.

Copyright Hodgetts + Fung Design and Architecture.
 All rights reserved.

MARK	DATE	DESCRIPTION
	08.29.15	DEVELOPMENT REVISIONS
	08.12.16	DEVELOPMENT REVISIONS

PROJECT NO.	1330
SUBMISSION	DEVELOPMENT PERMIT
ISSUE DATE	08.15.14
SCALE	1/16" = 1'-0"
DRAWN BY	DV
CHECKED BY	CHK
SHEET SIZE	30" x 40"
DRAWING TITLE	LEVEL P1 PLAN
DRAWING NO.	A-2.04

