

The Park and Open Space

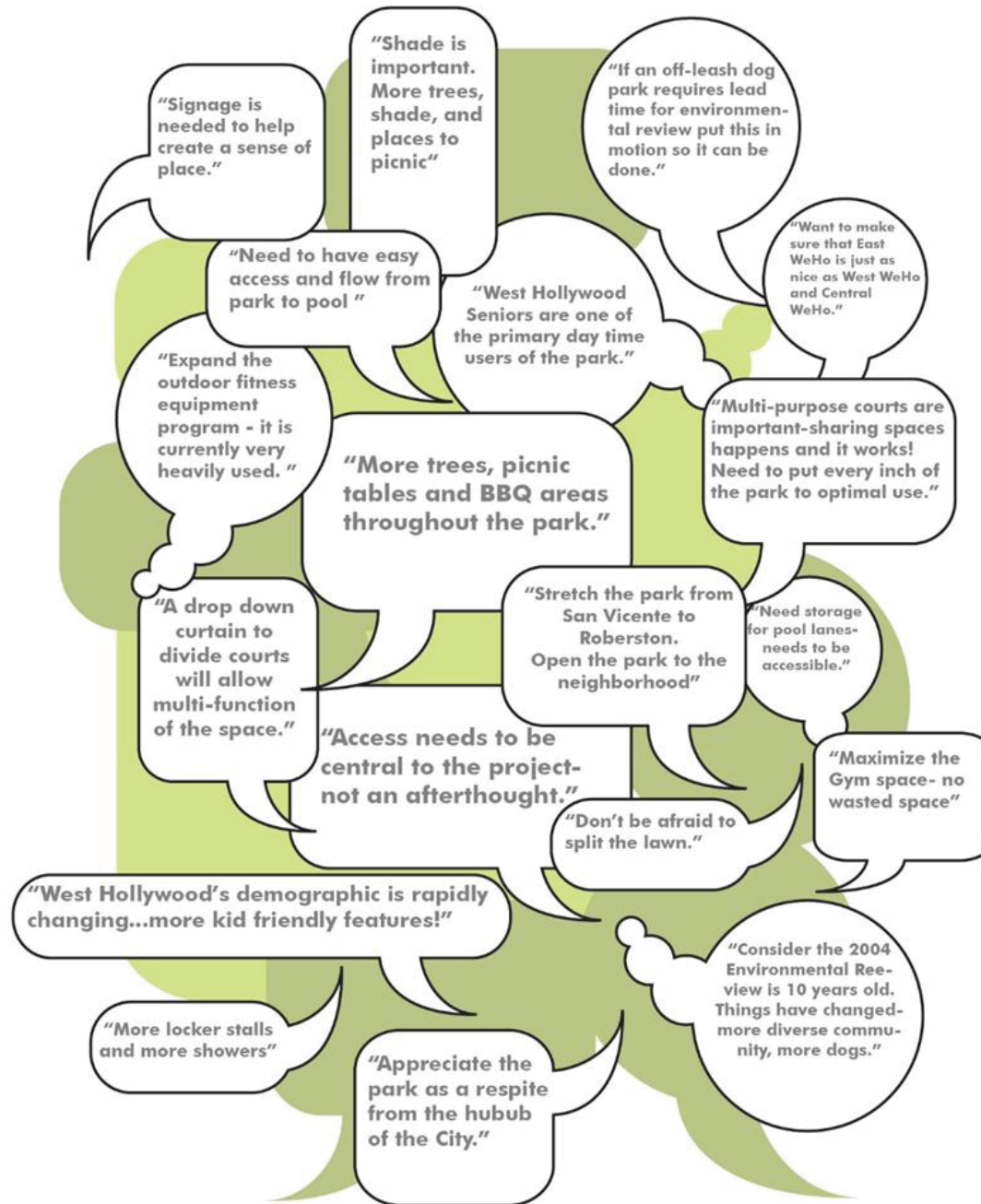

KEY ISSUES

- Access
- Demographics of Park Use
- Urban Connections
- Multi-function / Flexibility
- Storage
- Balance of Park as Respite vs. Urban Park
- Balance of Open Lawn vs. Trees

FEEDBACK

THE PARK



EXISTING CONDITIONS

THE PARK



LEGEND- 06/04/2014

- | | |
|---|---|
|  BAUHINIA BLAKEANA
Hong Kong Orchid Tree |  GINKGO BILOBA
Maidenhair Tree |
|  BRACHYCITON ACERFOLIUS
Illawara Flame Tree |  JACARANDA MIMOSIFOLIA
Jacaranda |
|  BRACHYCITON POPULNEUS
Kurrajong Tree |  KOELRETERIA BIPINNATA
Chinese Flame Tree |
|  CALLIANDRA HAEMATOCEPHALA
Red Powder Puff Tree |  LAGERSTROEMIA INDICA
Crape Myrtle |
|  CALLISTEMON VIMINALIS
Weeping Bottle Brush |  OLEA EUROPAEA
Olive Tree |
|  CASSIA FISTULA
Golden Shower Tree |  PINUS CANARIENSIS
Canary Island Pine |
|  CINNAMOMUM CAMPHORA
Camphor Tree |  PLATANUS MEXICANA 'ALAMO'
Mexican Sycamore |
|  CUPRESSUS LUSITANICA
Mexican Cedar |  PLATANUS RACEMOSA
California Sycamore |
|  ERYTHRINA CRISTA-GALI
Coral Tree |  ULMUS PARVIFOLIA
Chinese Elm |
|  EUCALYPTUS SIDEROXYLON
Red Ironbark |  WASHINGTONIA FILIFERA
California Fan Palm |
|  FICUS ELASTICA
Rubber Tree |  QUERCUS |
|  FICUS MACROCARPA NITIDA
Indian Laurel Fig | |

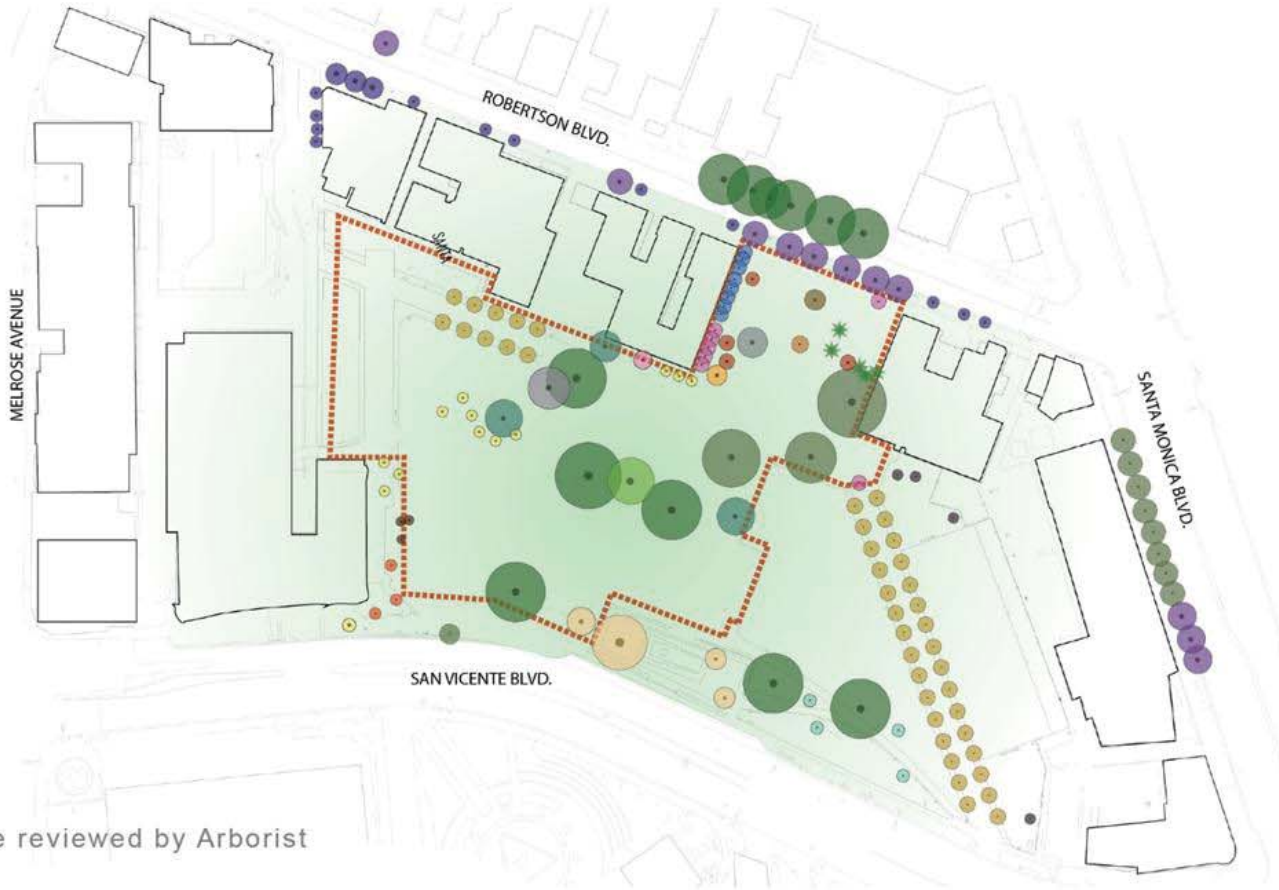

NOTE: Existing Tree health to be reviewed by Arborist

EXISTING TREES & SHADE

THE PARK



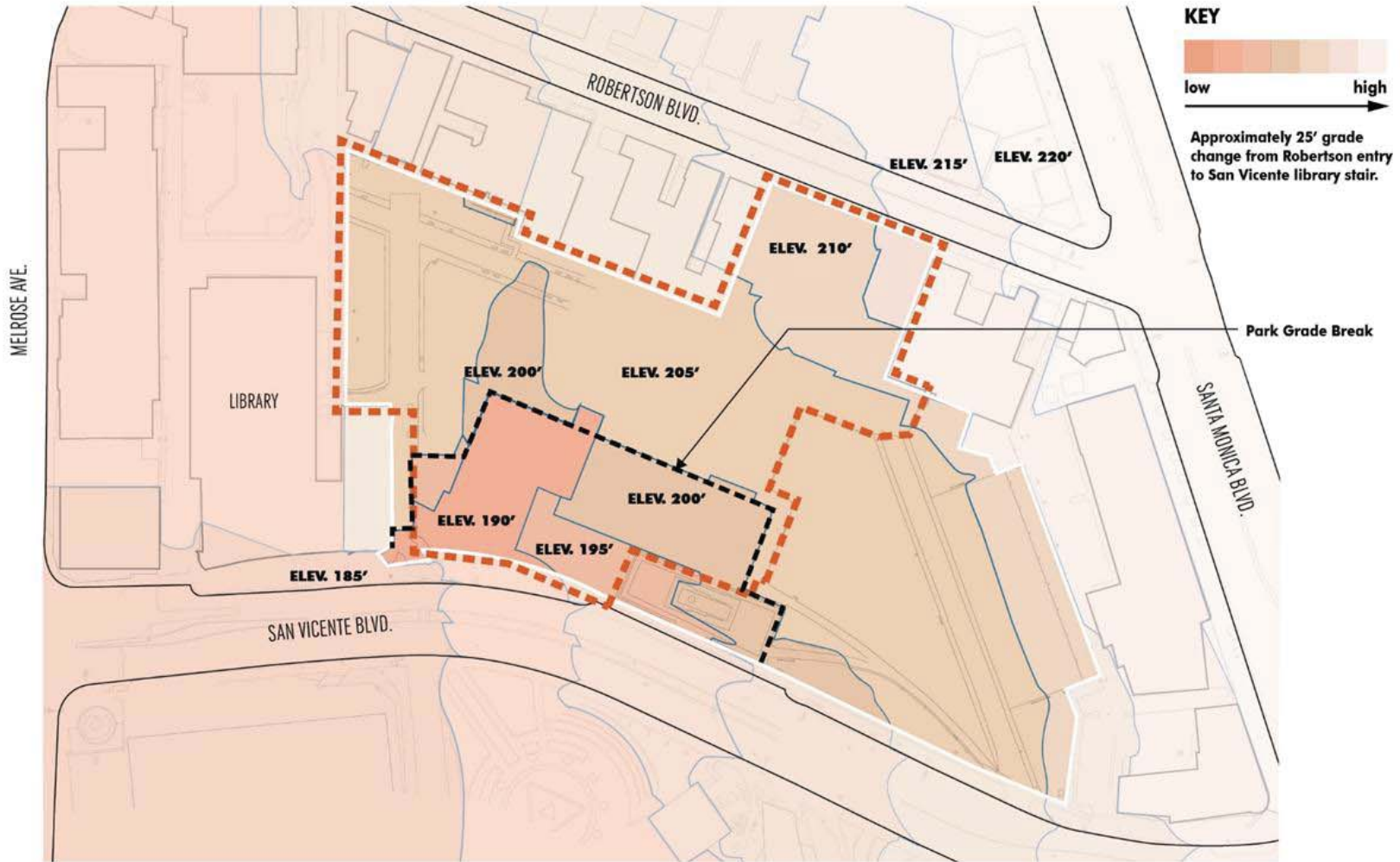

EXISTING TOPOGRAPHY

THE PARK



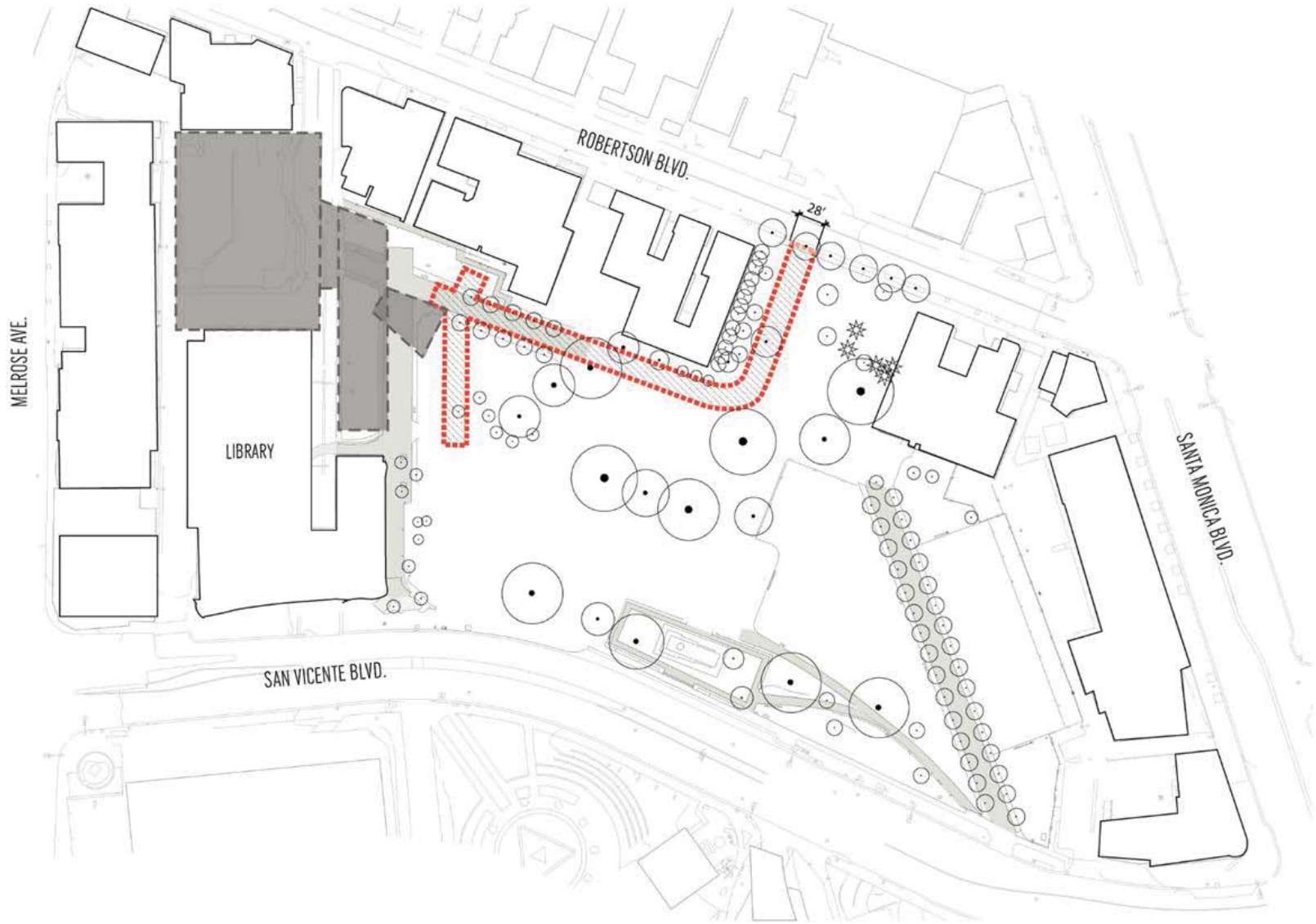

FIRE LANE REQUIREMENTS

THE PARK



KEY ADJACENCIES

Buffer from Quiet Zones at Library

AREA / SIZE

Size to allow pick-up play, accommodate existing events. Existing Phase 1 Lawn is 28,350 sf

PROGRAM OBJECTIVE

Space for large gatherings and for flexible, impromptu "pick-up" sports.

PROGRAM ELEMENTS



Pick-up Sports



Passive Recreation



Flexible Use



Large Gatherings



Tented Events

MATERIALS



Turf



Canopy Trees



Turf Alternatives

FLEXIBLE MEADOW(S)

THE PARK

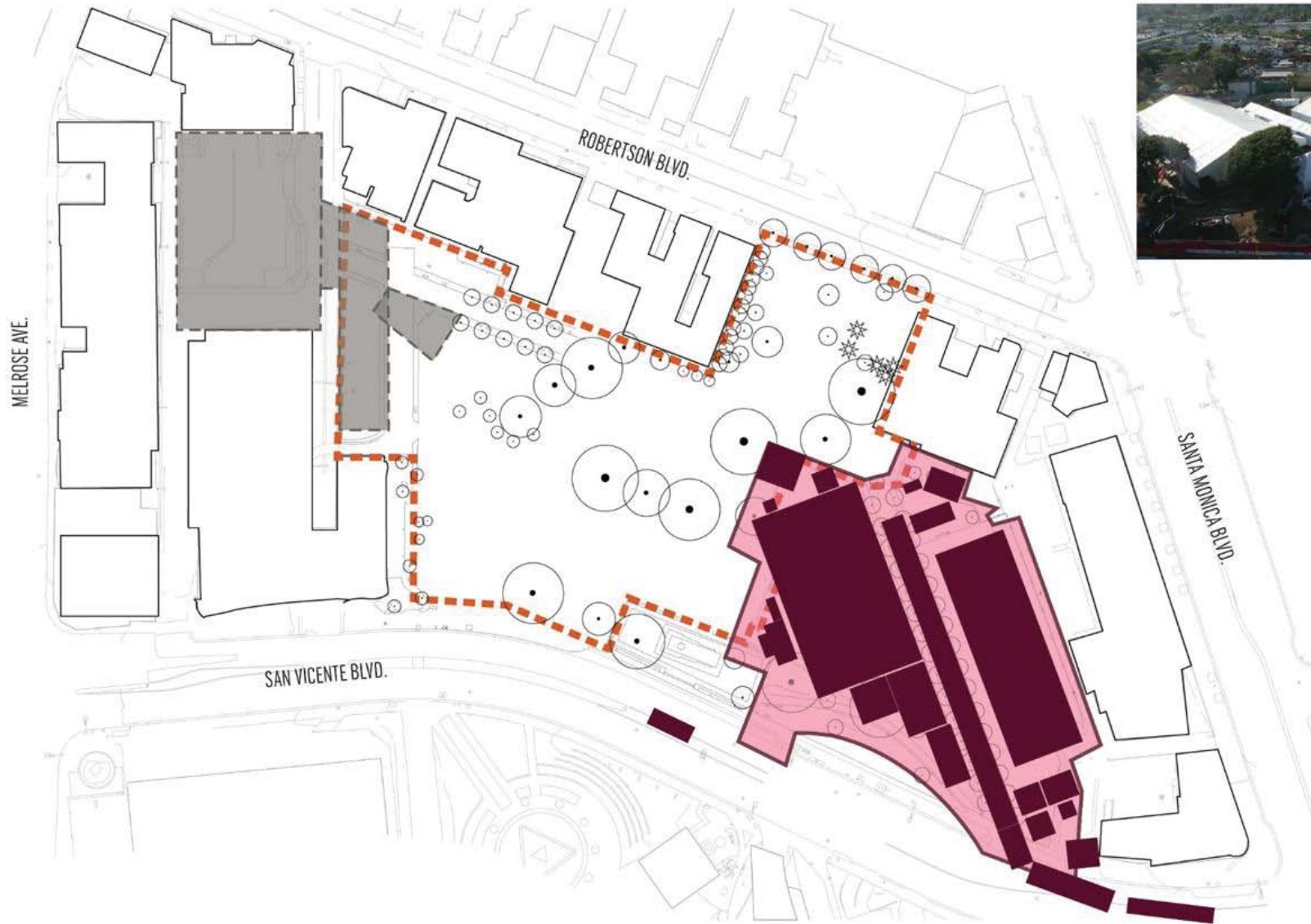

FLEXIBLE MEADOW(S) Elton John AIDS Foundation 2013 Tent Layout

LPA RIOS CLEMENTI HALE STUDIOS

THE PARK



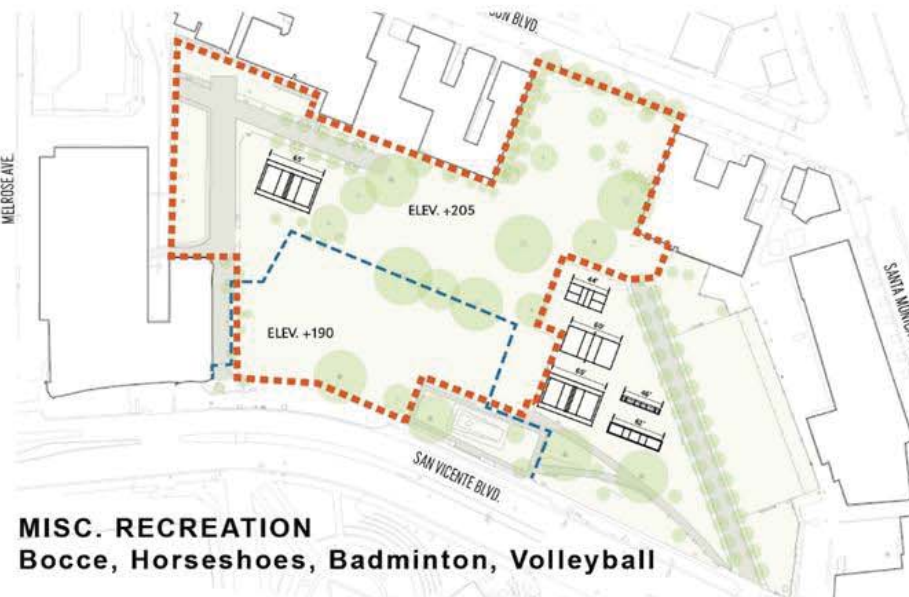
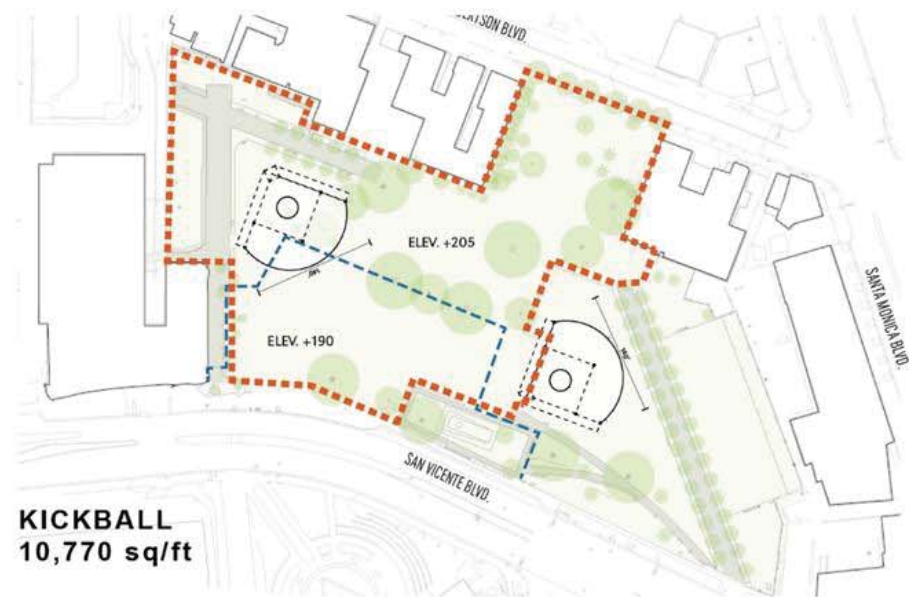

FLEXIBLE MEADOW(S) PICK-UP SPORTS - WHAT FITS

THE PARK



LPA RIOS CLEMENTI HALE STUDIOS

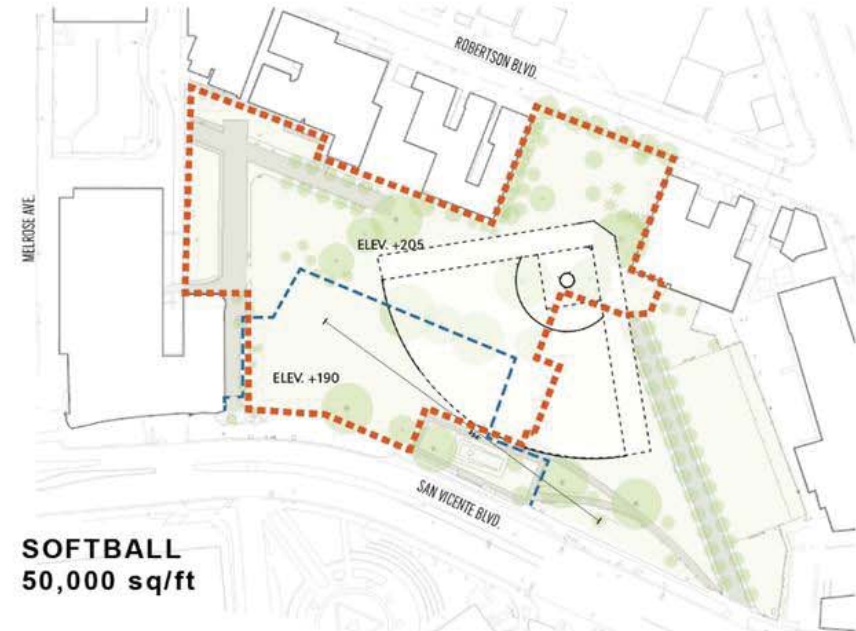
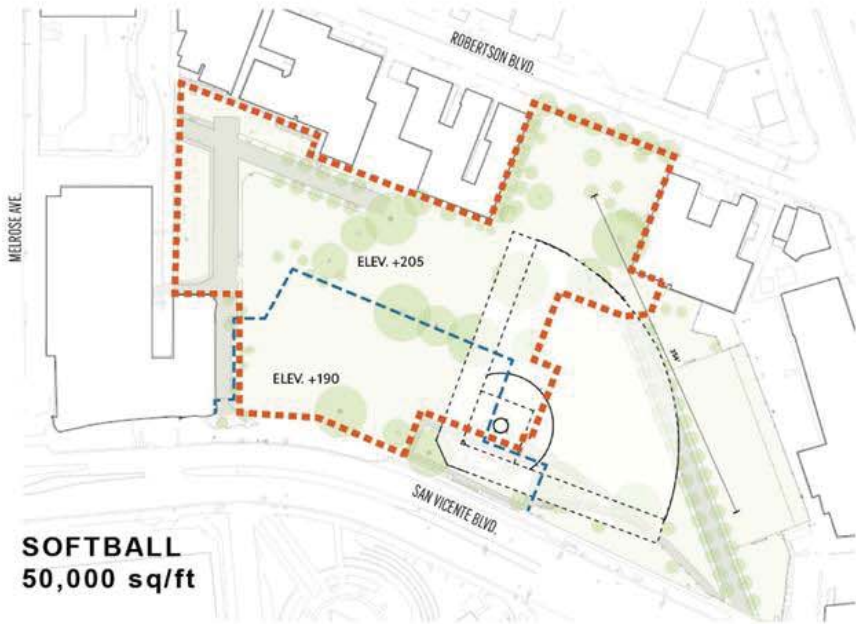

Park doesn't preclude a game of pick-up soccer or softball.

FLEXIBLE MEADOW(S) PICK-UP SPORTS - WHAT DOESN'T FIT

THE PARK



LPA RIOS CLEMENTI HALE STUDIOS

KEY ADJACENCIES

Restrooms, Recreation Center, Picnic Areas

AREA / SIZE

2,000-5,000 sf (2-5 ages) & 5,000 sf - 10,000 sf min. (5-12 ages)

PROGRAM OBJECTIVE

- Shady, outdoor area for active & passive play for kids
- Universally accessible for parents and kids to use and play
- Fence enclosure
- Maintain good sight lines throughout play areas

PROGRAM ELEMENTS



Nature/Adventure Play



Sliding



Swinging



Climbing



Dramatic Play

MATERIALS



Picnic Tables



Resilient Surface



Seating



Drought-Tolerant Gardens

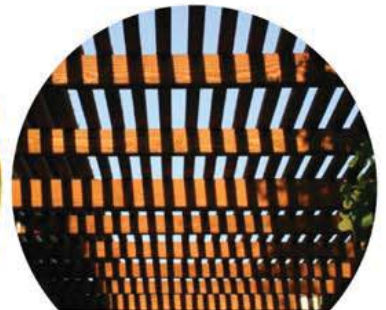

Shade

CHILDREN'S PLAY AREAS - Ages 2-5 & 5-12

THE PARK

LPA RIOS CLEMENTI HALE STUDIOS

KEY ADJACENCIES

Recreation Center: Tiny Tot Program Room, Restrooms

AREA / SIZE

900-1,500 sf

PROGRAM OBJECTIVE

- Securable, exclusive to Tiny Tot program
- Accommodate max. 30 kids
- Provide easy access from Tiny Tot room

PROGRAM ELEMENTS



Water Table



Sand Table



Nature/Science Ctr.



Messy Play



Arts & Crafts

MATERIALS



Resilient Surface



Child-sized Seating



Garden Beds



Shade



6-8' Enclosure

CHILDREN'S PLAY AREAS - Tiny Tot Yard

THE PARK

LPA RIOS CLEMENTI HALE STUDIOS

KEY ADJACENCIES

Open, urban connection to Neighborhood

AREA / SIZE

TBD

PROGRAM OBJECTIVE

- Shaded seating for play, picnics and intimate gatherings
- Space for adventure and discovery w/ meandering paths
- Sense of enclosure w/ views to the park
- Retention of existing shade trees & increasing tree canopy (where possible)

PROGRAM ELEMENTS



Art Opportunity



Discovery Zone



Picnic Areas



Urban Respite



Meandering Paths

MATERIALS



Turf



Permeable Paths



**Drought-Tolerant
Gardens**



Shade Trees

THE HEART OF THE PARK

THE PARK

KEY ADJACENCIES

Robertson Blvd., Neighboring Commercial

AREA / SIZE

Existing Size - 9,100 sf

PROGRAM OBJECTIVE

- Primary Entry Point
- Intimate-scale spaces w/ seating
- Shady urban garden / Pocket Park
- Connect to Robertson Blvd. & Streetscape Improvements
- Incorporate fire lane & emergency access
- Activate walls of adjacent buildings w/ programming
- Provide focal to space (i.e. art, ornamental garden, water)
- Platform for performances / events
- Accommodate Pop-up Events (i.e. food trucks)
- Bring Park out to Street

PROGRAM ELEMENTS



Platform for Events



Pocket Park



Focal Point



Urban Respite



Pop-up Events

MATERIALS



Site Furnishings



Drought-Tolerant Gardens



Grove



Permeable Paving



Bike Parking

CITY COUNCIL COMMENT

ROBERTSON COMMONS

THE PARK

LPA RIOS CLEMENTI HALE STUDIOS

KEY ADJACENCIES

San Vicente Blvd., Library, Flexible Meadow, National AIDS Monument

AREA / SIZE

TBD

PROGRAM OBJECTIVE

- Primary Park Entry
- Gracious, **universally accessible transition** between park and San Vicente Blvd.
- Traversable, occupiable public gardens
- Views into park & connections
- Views to San Vicente
- Bring Park out to Street**

PROGRAM ELEMENTS



Overlook



Accessible Paths



Seating Areas



Garden Transitions

MATERIALS



Amphitheater



Ornamental Planting



Benches



Trees

*** NOTE:
EXTENT OF PROGRAM
INCLUDED IN PHASE 2
SCOPE TO BE DETERMINED
BY COUNCIL DIRECTION.

CITY COUNCIL COMMENT

SAN VICENTE GARDENS

THE PARK

LPA RIOS CLEMENTI HALE STUDIOS

KEY ADJACENCIES

Connections to all program areas

AREA / SIZE

12' - 20' wide

PROGRAM OBJECTIVE

- Interconnected, primary circulation system
- Linear rooms for strolling, sitting and activity
- Sufficient width to accommodate people walking, kiosks, and kids w/ tricycles
- Emergency vehicle access

PROGRAM ELEMENTS



Linear Rooms



Activated Edges



Permeable Edges



Tree-lined & Shaded

MATERIALS



Concrete



Shade Trees



Seating



Permeable Paving

PARK PROMENADES

THE PARK

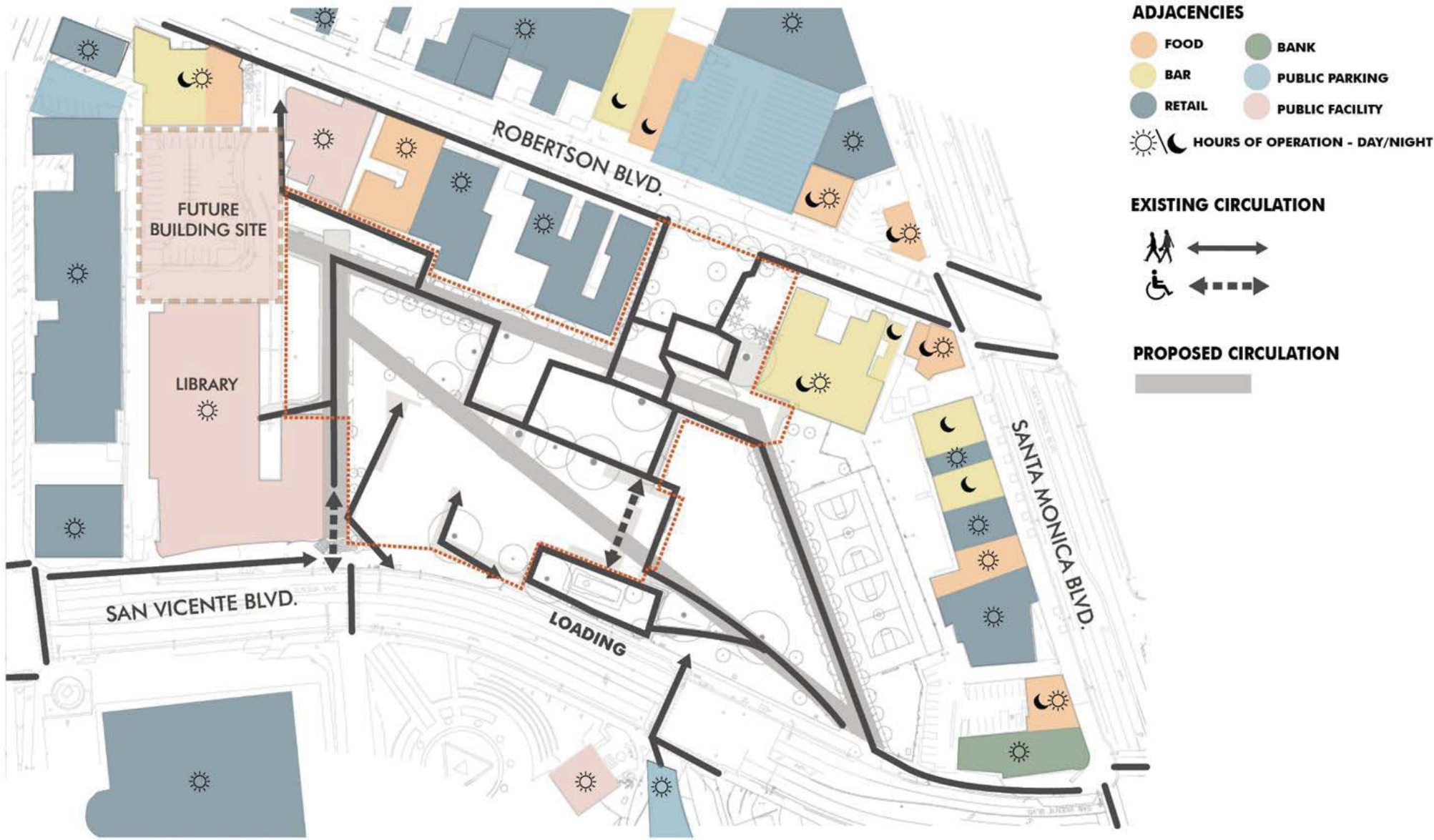

ADJACENCIES

- FOOD
- BAR
- RETAIL
- BANK
- PUBLIC PARKING
- PUBLIC FACILITY

HOURS OF OPERATION - DAY/NIGHT

EXISTING CIRCULATION

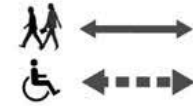

PROPOSED CIRCULATION



ADJACENCY & CIRCULATION

THE PARK



KEY ADJACENCIES

Library, San Vicente Blvd. & San Vicente Gardens, Buffer from Children's Play areas & Flexible Meadows as needed

AREA / SIZE

TBD

PROGRAM OBJECTIVE

- Memorialize
- Tribute
- Inform

PROGRAM PRECEDENT



San Francisco AIDS National Memorial Grove

NATIONAL AIDS MONUMENT

THE PARK

LPA RIOS CLEMENTI HALE STUDIOS

1. LIGHTING

- Pedestrian-scale lighting for enhanced security and aesthetics of park

2. SIGNAGE

- Wayfinding and educational signage

3. BICYCLES

- Bicycle Parking in multiple locations throughout Park

4. PUBLIC TRANSPORTATION

- Facilitate connections to bus drop-off locations

5. SUSTAINABILITY

- Permeable paving where possible
- Native and drought tolerant plantings
- High efficiency irrigation and lighting

6. UNIVERSAL ACCESSIBILITY

- San Vicente Gardens
- Playgrounds
- Connections from Neighborhood, through park to Recreation Building

CITY COUNCIL COMMENT



Lighting



Signage



Bicycle Station



Drought-Tolerant
Planting



Access

GENERAL PROGRAM ELEMENTS

THE PARK

MELROSE AVE.



CONCEPT PLAN - OPTION A

THE PARK



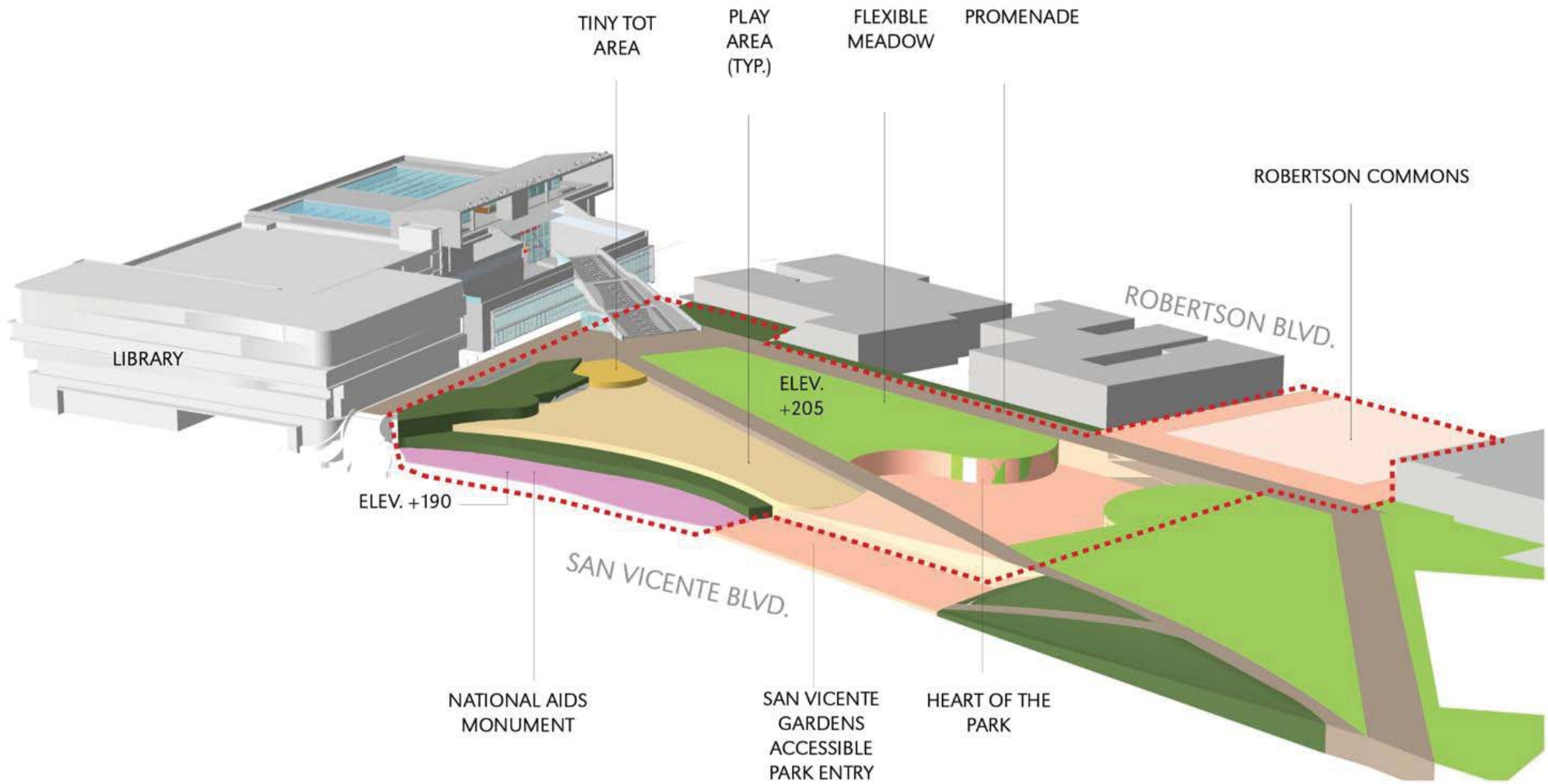

1,400 sq/ft	16,000 sq/ft	9,100 sq/ft	7,500 sq/ft	36,960 sq/ft	28,350 sq/ft	19,370 sq/ft	18,150 sq/ft	7,700 sq/ft
TINY TOTS	CHILDREN'S PLAY AREA	ROBERTSON COMMONS	SAN VICENTE GARDENS ACCESSIBLE ENTRY	HEART OF THE PARK	FLEXIBLE MEADOW NORTH	FLEXIBLE MEADOW SOUTH	GARDEN BUFFER	NATIONAL AIDS MONUMENT

LPA RIOS CLEMENTI HALE STUDIOS

THE PARK



1. SECURITY
 - “Blue” Emergency stations / Lighting
2. RECREATION
 - Sand Volleyball Court
 - Circuit Training / Fitness Equipment
3. PUBLIC RESTROOM IN PARK
 - Building near Basketball Courts (Single use only)
4. BBQ GRILLS
5. SITE FURNISHINGS
 - Moveable, Lockable or Fixed?
6. BIKE SHARING STATION
7. DOG PARK
 - Needs to be evaluated against the EIR

 CITY COUNCIL COMMENT

8. CONNECTION TO ADJACENT CONTEXT:

- El Tovar Landscape - Extension of "Park landscape language" out onto Robertson
- Connection to 'pedestrian alley' north of basketball courts.
- Possibility for opening up adjacent businesses onto the park.
- Possibility to better connect to local parking spaces such as at PDC
- Connection to the proposed Roberston Streetscape improvements

9. EXISTING SAN VICENTE PLATFORM

- Investigate improving safety and ADA accessibility at the existing entry platform.
- Options:
 - a) Existing entry sequence remains in place
 - b) Modify existing design to incorporate into a new solution
 - c) Remove existing design to create a new entry sequence

10. STORAGE CONTAINERS IN PARK

- Red Cross Emergency Container?
- City Facilities / Maintenance?
- Recreation Storage Needs?

11. WATER FEATURES

- Focal Point in Park
- Kids Play Fountain in Playground

12. MULTI PURPOSE PLAYING FIELD FOR ALL SPORTS

- The proposed park does not accommodate regulation size softball or soccer. What capacity for pick-up sports do we want the meadows to accommodate? Can we have approval to proceed with flexible meadows intended for smaller pick-up sports?

CITY COUNCIL COMMENT