

**SEWER SYSTEM MANAGEMENT
PLAN
2013 BI-ANNUAL AUDIT
FOR THE
CITY OF WEST HOLLYWOOD
COVERING YEARS 2011 AND 2012**



City of West Hollywood
Sewer System Management Plan 2013 Bi-Annual Audit
Covering Years 2011 and 2012

Introduction

On May 2, 2006, the State Water Resources Control Board (SWRCB) adopted Statewide General Waste Discharge Requirements for Sanitary Sewer Systems (General WDRs). The General WDRs apply to all public agencies that own or operate a sanitary sewer system that is comprised of more than one mile of sewer pipes or lines which convey wastewater to a publicly owned treatment facility. The General WDRs refer to these public agencies as “enrollees.”

The City of West Hollywood Public Works Department (City) applied for coverage under the General WDRs by submitting a Notice of Intent to comply with the terms of the WDRs along with the required fees to the State Water board in October 2006, and commenced development of the required Sewer System Management Plan (SSMP).

Through a contract, the City Council has delegated the majority of the City’s sewer maintenance and industrial waste activities to the County of Los Angeles. The County’s adopted SSMP governs these activities in West Hollywood and the forty other cities the County services, and provides the details on the majority of the sewer programs implemented throughout the City. The City has also prepared an addendum to the County’s SSMP to cover the portions of programs handled directly by the City. Where necessary, the City’s addendum references the County’s SSMP for the programs that have been delegated to the County by contract. This document was updated in 2012 and adopted by the City Council on February 21, 2012.

The General WDRs and resulting SSMP outline the requirements for periodic internal audits at least once every two years after adoption of the SSMP. The audit focuses on evaluating the effectiveness of the SSMP and the City’s compliance with the SSMP requirements. This audit serves as the second evaluation of the effectiveness of the SSMP.

System Description

The City of West Hollywood Department of Public Works provides sanitary sewer services to all parcels citywide. The City’s sanitary sewer system is comprised of 39.4 miles of gravity flow sewer mainlines. Appendix A includes maps of the citywide sewer system. The oldest sewer mains in the City were installed in the 1920’s. This is the majority of the system, with approximately 24% of the system installed after 1960 when the City experienced significant growth. During the past 10 years, the City has embarked on an aggressive rehabilitation program to

inspect and repair deteriorated sewer lines. This rehabilitation work has included installation of vinyl liners. The following table shows the distribution of the sewer mainlines by age. Pipes listed with an age of 2000 – Present include sewer mainlines which have been structurally rejuvenated with vinyl liners.

SEWER MAINS BY AGE

Year	Mainlines (%)
2000 - Present	30
1980 - 1999	0
1960 - 1979	24
1940 - 1959	6
1920 - 1939	40
Before 1920	0
Unknown Age	0
Total =	100%

The City’s sewer mainlines are vitrified clay pipe (VCP). Pipes range in size from 8 inches to 18 inches in diameter. The following table shows the distribution of sewer mainlines by size.

SEWER MAIN SIZE BY DIAMETER

Size (inches)	Mainlines (%)
8 inches	83
9 - 18 inches	17
>19 inches	0
Total =	100%

The Elements of the SSMP include:

1. Goals – description of the City’s SSMP goals.
2. Organization – description of the City’s organizational structure.
3. Legal Authority – description of the City’s legal rights, including codes and ordinances, to enforce the requirements of the WDRs.
4. Operation and Maintenance Program – outlines the City’s maintenance schedule and methodology to ensure proper management and maintenance of sewer facilities are properly designed and installed.
5. Design and Performance Provisions – description of methods by which the City ensures that new and rehabilitated sewer facilities are properly designed and installed.

6. Overflow Emergency Response Plan – describes how the City responds to, reports, and documents SSO events within the Consolidated Sewer Maintenance District.
7. Fat, Oil, and Grease (FOG) Control Program – describes how the City prevents or minimizes the discharge of fats, oils, and grease into the sewer lines, which is known to contribute to SSOs.
8. System Evaluation and Capacity Assurance – how we ensure adequate capacity is available for new and existing developments.
9. Monitoring, Measurement, and Program Modifications – details the City’s plan to continually monitor and assess the performance of each element of the SSMP in achieving the goals and objectives of the SSMP and updating them as necessary.
10. SSMP Program Audit and Certification – describes the City’s plan to periodically assess the effectiveness of the SSMP based mainly on the plan’s ability in reducing SSOs.
11. Communication Program – summarizes the City’s plan to ensure that stakeholders are aware of the City’s SSMP.

Evaluation of Section 1 – Goals

Following are goals established in the SSMP along with an evaluation of how each has been furthered through SSMP implementation.

- A. To properly manage, operate, and maintain all portions of the City’s sanitary sewer system.
The City contracts with the County of Los Angeles Department of Public Works for operation and maintenance of the City owned sewer system. Section 4 of the SSMP describes the preventative maintenance program. The evaluation of Section 4 discusses the City’s effectiveness of managing, operating, and maintaining the system.
- B. To provide adequate capacity to convey the City’s peak wastewater flows.
The City maintains records of the cause of all overflows. Since adoption of the SSMP, no overflows were related to a shortage of capacity. Of the five overflows that have occurred in 2011 and 2012, two were related to root intrusion, one was related to grease deposition, one was related to debris, and one was a structural collapse of a deteriorated pipe. The absence of overflows due to insufficient capacity indicates that the City has met its goal of providing adequate capacity to convey peak wastewater flows. In addition, proposed development projects are required to evaluate the downstream sewer capacity as part of the CEQA review process, incorporating necessary sewer capacity mitigations into the project design.

- C. To minimize Sanitary Sewer Overflows (SSOs).
 Historical SSOs reached their peak in 2008, with 10 SSOs in one calendar year. Since then, the number of overflows has steadily dropped as a result of implementation of the SSMP. For 2011 and 2012, the City has reduced the frequency of overflows to the industry standard of six overflows per year per 100 miles of pipe. The table below shows the historical frequency of overflows from 2007 to 2012.

HISTORICAL FREQUENCY OF OVERFLOWS

Year	Number of SSOs
2007	9
2008	10
2009	3
2010	9
2011	3
2012	2

- D. To mitigate the impacts that are associated with any sewer overflows that may occur.
 Appendix B includes information on the overflows that occurred in 2011 and 2012. The total volume of all overflows was approximately 1,150 gallons, with approximately 700 gallons recovered. This is a substantial improvement compared to overflows that occurred prior to 2011. The improvement is the result of quick response time, which meets the goal of mitigating the impacts of sewer overflows that do occur. Additionally, reducing the total number of overflows significantly reduces the potential impact of wastewater discharges to the environment.
- E. To meet all applicable regulatory notification and reporting requirements.
 In 2011 and 2012, the City had three overflows that qualified as Category 1 spills and two that qualified as Category 2 spills, requiring notification to regulatory agencies. The City coordinates with Los Angeles County Sewer Maintenance staff to ensure that notifications are made, and that processes have been implemented appropriately.

Evaluation of Section 2 – Organization

The City Manager serves as the Chief Executive Officer of the City. The City Manager appoints the City’s department heads and is responsible for ensuring that City services are performed to the highest standard in accordance with City Council policies. The City Manager is responsible for the submission of the City’s budget and implementation in support of the City Council’s goals. The City Manager has delegated to the City Engineer to serve as signatory and certification authority for all applications, reports, or information required by the

Order. The City's organizational system included in Section 2 of the SSMP continues to represent the organization of the City and County for the management of the SSMP. Contact information will be kept updated to reflect any changes in personnel or means of communication.

Evaluation of Section 3 – Legal Authority

The City has the legal authority to carry out activities to protect the wastewater collections system against SSOs. A discussion of each of the categories of activities follows.

- A. Prevent illicit discharges into the sanitary sewer system. The City's Engineering Division and Facilities Division Staff work closely with the City's Code Compliance Division to address issues associated with illicit discharges, storm water violations, and unauthorized debris. Code Compliance Officers have also assisted County Industrial Waste Inspectors with enforcement of compliance with the Fats, Oils, and Grease (FOG) regulations.
- B. Require proper design and construction of sewers and connections. The City has adopted the Standard Plans and Specifications for Public Works Construction (Greenbook) prepared and promulgated by the Southern California Chapter of the American Public Works Association and the Southern California Districts of the Associated General Contractors of California. These design and construction standards are sufficient to ensure adequate construction of sewer mains and laterals. The Engineering Division staff along with contract inspectors as needed verify that the design and construction standards are followed during construction.
- C. Ensure access for maintenance, inspection, and repairs to publicly owned portions of laterals. As part of the concurrent plan check process for development review, the Engineering Division staff makes sure that sewer mains and laterals are built in a manner that facilitates access for maintenance and repair. The Engineering Division staff review drawings of public improvement plans before the infrastructure is finalized. This enables facility locations to be adjusted to meet the long-term collections system maintenance needs.
- D. Limit the discharge of FOG and other debris that may cause blockages. The City has adequate legal authority to address FOG and other debris discharges that may cause blockages. County's Industrial Waste Inspection staff along with the City's Code Compliance staff has actively addressed violations to FOG regulations. This is evidenced by a steady reduction in FOG related overflows in 2011 and 2012.

- E. Enforce violations of its sewer ordinance. The County's Industrial Waste Inspection staff along with the City's Code Compliance staff enforces the City's Municipal Code, which includes by reference pertinent sections of the County Code. Enforcement has significantly reduced the number of facilities out of compliance with the City's FOG regulations as well as the number of overflows from residential and large rental properties. For 2011 and 2012, the code enforcement was based on the 1990 LA County Industrial Waste Ordinance and the 2010 Municipal Code/LA County Plumbing Code and 2010 Municipal Code/LA County Building Code.

Evaluation of Section 4 – Operations and Maintenance Program

The City contracts with the Los Angeles County Department of Public Works (LACDPW), Sewer Maintenance Division for day to day operation and maintenance of the sewer system. In addition the City manages Chemical Root Control, Rehabilitation & Replacement Program, and Condition Assessment Program. An evaluation of each element of the Operations and Maintenance Program is provided below:

- A. Preventive Maintenance Program. Appendix C shows a summary of the sewer maintenance work completed by LACDPW for 2011 and 2012. The LACDPW met its goals for cleaning and inspecting the citywide sewer system. There are a number of sewer locations in the vicinity of Sunset Blvd, Santa Monica Blvd, Melrose Avenue, and Beverly Blvd where the County's Sewer Maintenance Crews conduct "Periodic" cleaning on a schedule of 30, 60, 90 or 120 days. The majority of these locations are chronic "hot spots" for grease in the sewers. Appendix C provides a Periodics Report with details and a map of this recurring work for 2011 and 2012. On a monthly basis the City Engineer communicates with the County's Sewer Maintenance Superintendent to review the County's performance standards, schedules for planned work, as well as evaluate actual work performed by County crews. Through these reviews, the City has taken a more active role in the administration of the County's contract for sewer maintenance services.

Training for Field Operations Personnel and Contractors. The LACDPW staff responsible for the operation and maintenance of the City's sewer collection system attend formalized collection system training classes or seminars given by other agencies including California Occupational, Safety and Health Administration (CALOSHA), California Water Environment Association, International Brotherhood of Electrical Workers, etc. In addition the City's Street Maintenance Supervisor, Maintenance Workers and Environmental Programs Coordinator attended a training hosted by LACDPW on September 20, 2012 on Overflow Containment Procedures for First Responders. On November 8, 2012, the City

Engineer attended a five hour training on Sewer Collection Systems hosted by the California Water Environment Association (CWEA). These training programs help to ensure the proper day to day management of the sewer collection system as well as preparation for staff who may respond to a SSO.

Chemical Root Control is managed by the City separate from the maintenance services provided by LACDPW. The City contracts annually with Dukes Root Control, Inc. to treat the sewer lines with foaming herbicide to retard root growth. Considering the community is very densely planted with mature street trees, the root control effort has been successful in reducing mainline blockages. Appendix D shows a summary of the root control work completed for 2011 and 2012. Each calendar year, approximately 1/3 of the sewer mainlines, located within root intrusion areas are scheduled for the chemical root control. The City's chemical root control program addresses roots in the mainline system; however roots from private laterals have been the source of some SSOs in the past. The City uses CCTV data to identify root issues in private laterals, and follows up with notification to property owners regarding private laterals in possible need of replacement.

- B. Rehabilitation and Replacement Plan. Following is a summary of sewer rehabilitation and replacement work done in 2011 and 2012:

CIP 1104 East Side Sewer Rehabilitation, was built in 2011. The project addressed sewer deficiencies identified on the eastern side of the City, between Fairfax Avenue and the City Boundary at La Brea Avenue. The work included CIPP lining of 24,664 LF of pipe, point repairs at 4 locations, replacement of 48 LF of deteriorated pipe, and manhole rehabilitation at 165 locations. Total cost of the construction project was \$1,806,513.

CIP 1307 Emergency Sewer Repairs at Melrose Ave/San Vicente Blvd was built in 2012. This work was to remedy a collapsed 8-inch diameter sewer mainline, which was originally installed in 1926. The work included replacement of 9 linear feet of sewer mainline, reconnection of house connections, and restoration of the concrete pavement. Total cost of the construction project was \$39,000.

- C. Condition Assessment Program. As the sewer collection system ages, the risk of failure increases. Issues of concern include deterioration, collapse, blockage, excessive inflow and infiltration, overflow, and other potential service interruptions. Following is a summary of condition assessment work done in 2011 and 2012:

In 2012, the City hired the private engineering firm of Brown & Caldwell to conduct CCTV inspection and design rehabilitation for sewer lines located in the mid-city area of the City. The study area includes all sewer lines located between La Cienega Blvd and Fairfax Avenue. The work included inspection of 45,000 linear feet of sewer mainline and 185 manholes. The investigation identified approximately 18,157 linear feet of 8-inch diameter pipe in need of lining, approximately 249 linear feet of 15-inch diameter pipe in need of replacement, and five locations needing dig and replace point repairs. No full manhole rehabilitation was recommended, although manhole rungs are in need of replacement at 185 locations. Construction documents have been prepared for the rehabilitation work. Due to the size of the project, the work has been split into three phases, to be budgeted in the upcoming years. The first phase is scheduled for construction in 2013.

Evaluation of Section 5 – Design and Performance Standards

Design of City facilities has not been identified as a cause for any overflows that have occurred since the adoption of the SSMP. The City's existing design and performance standards included in the SSMP are adequate and effective. No changes were made in 2011 and 2012.

Evaluation of Section 6 – Overflow Emergency Response Plan

In coordination with LACDPW, the City has defined an effective overflow emergency response plan that has been implemented in each of the overflows that occurred in 2011 and 2012. The Overflow Emergency Response Plan contains several elements, each of which is evaluated below:

- A. Proper notification procedures so that primary responders and regulatory agencies are informed of all sanitary sewer overflows in a timely manner. LACDPW staff responsible for responding to overflows is dispatched in a timely manner. Appendix B shows the response time for each overflow that occurred in 2011 and 2012. The average response time after notification is 45 minutes, with a maximum response time of 1 hour 36 minutes. The longest portion of the response time is typically the travel time to arrive to the overflow location. The LACDPW goal is to have response times of 2 hours or less. All of the response times met this goal.
- B. A program to ensure an appropriate response to all overflows. LACDPW sewer maintenance crews responded to all clogs and overflows that occurred within the City, an average of 32 calls per year. These service calls include overflows on City mains, overflows on private property, and sewer clogs that did not become overflows. All were addressed in a timely manner to the satisfaction of the customers. Each overflow was

discussed to determine cause and to identify if operational or other changes could be made to reduce the likelihood of an overflow in the future.

- C. Procedures to ensure prompt notification to appropriate regulatory agencies and other potentially affected entities. LACDPW provides 24-hour emergency services to investigate and/or correct complaints from citizens. The LACDPW's 24-hour emergency telephone number is 1-800-675-HELP (4357). During business hours, emergency calls are received by the Public Works Dispatch Operator. The Operator will call and dispatch the nearest Sewer Maintenance crew to the problem site. For after-hour emergencies, the Operator will call the Regional Sewer Maintenance Superintendent or Supervisor in the order listed on the Emergency Contact Telephone List. The Superintendent or Supervisor who receives the emergency call will investigate the complaint and take appropriate action including immediate dispatch of a standby crew with necessary equipment to take care of the problem, or refer the call to other agencies if the problem is found not to be in our jurisdiction.

The crew responding to an overflow emergency is required to stop the overflow, contain it if possible, and ensure that the facility or area is cleaned up and returned to normal operation. Residents in the immediate vicinity of the overflow are informed of the cause of the problem and the remedial action taken. The County of Los Angeles Health Department, the Regional Water Quality Control Board, and the California Emergency Management Agency are notified of all sanitary sewer overflows. The DPW Flood Maintenance Division (FMD) is notified of all overflows that discharge into the storm drain system. The role of FMD is to assist in tracing and capturing the spill as much as possible before it reaches the waters of the United States. The agencies to be notified, method, and time frame for notification are presented in Appendix E. The relevant data about the overflow such as location, volume, and agencies notified, etc., is recorded in field report forms and later stored in the computer. All LACDPW field personnel are trained to be conversant with these procedures and to accurately report SSO incidents. The procedures have been used successfully for all SSO incidents.

- D. Procedures to ensure that appropriate staff and contractor personnel are aware of and follow the Plan and are appropriately trained. The Overflow Emergency Response Plan is available to key personnel who are responsible for managing or responding to SSOs. Copies of the County's instruction manuals are available to field crews and engineers at the office who manage or have the role of preparing SSO reports to regulatory agencies. All contractors working on the sewer system are required to comply with Employee and Public Safety, and SSO Notification and

Reporting Provisions. In addition the City's Street Maintenance Supervisor, Maintenance Workers and Environmental Programs Coordinator attended a training hosted by LACDPW on September 20, 2012 on Overflow Containment Procedures for First Responders.

- E. Procedures to address emergency operations such as traffic, crowd control, and other necessary response activities. For 2011 and 2012, no overflows have required extensive traffic or crowd control. The City's street maintenance vehicles are equipped with spill kits and barricades so that field staff responding to incident sites can install measures to contain flow and control traffic until LACDPW sewer maintenance crews arrive.
- F. Program to eliminate or minimize the discharge of SSOs into the waters of the United States. The LACDPW's sewer maintenance crews and emergency contractors' crews are properly trained on methods and procedures to prevent or limit the amount of SSO into waters of the United States and how to mitigate their impacts. Some of the methods include the use of sand bags to contain SSOs, absorbent socks to prevent SSO discharge into storm drain catch basins, and the use of vacuum trucks to suck up contained spills and dump the effluent back into the collection system at other safe locations. In 2011 and 2012, five SSOs occurred. Records show over 60% of the spill volume from these SSOs was recovered. For two SSOs, 100% of the spillage was recovered.

Evaluation of Section 7 – Fats, Oils, and Grease Control Program

The City has very dense concentration of restaurants within commercial districts on Sunset Blvd, Santa Monica Blvd, Robertson Blvd, and Beverly Blvd. In coordination with the LACDPW Industrial Waste Program, the City has implemented a comprehensive Fats, Oils, and Grease (FOG) Control Program that includes point source control, inspection of industrial waste and grease generating facilities, and investigation of illicit discharge of chemicals, debris, etc., into the public sewer, as well as educational information on the City website and hand-outs. The City Engineer is working with LACDPW Industrial Waste Inspection staff to proactively schedule inspections of all restaurants citywide. Restaurants are given Correction Notices requiring compliance with the industrial waste code, including retrofit of sub-standard plumbing equipment to bring kitchens into compliance for FOG control. This comprehensive program has been effective at reducing the number of overflows associated with FOG. Historical SSOs related to grease reached their peak in 2010; with five grease related SSOs in one calendar year. Since then, the number of grease related overflows has steadily dropped as a result of implementation of the SSMP. As noted in Appendix B, there was only one grease related SSO in 2011, and none in 2012.

Evaluation of Section 8 – System Evaluation and Capacity Assurance Plan

The City has a capital improvement plan to address repairs, replacements, and upgrades to sewer mainlines to provide sufficient capacity. Recent overflows have not been related to capacity limitations. In addition, proposed development projects are required to evaluate the downstream sewer capacity as part of the CEQA review process, incorporating necessary sewer capacity mitigations into the project design. Until additional growth occurs, the City's existing infrastructure is sufficient to provide the necessary capacity.

Evaluation of Section 9 – Monitoring, Measurement, and Program Modifications.

A. SSMP Program Effectiveness Evaluation. The City has multiple tools available for monitoring and measuring SSMP effectiveness, all of which have been used to provide the information for this audit. The following chart uses performance measures of key activities to assess the City's achievement in minimizing sewer overflows for 2011 and 2012.

Performance Measure	2011	2012
Total Number of SSOs	3	2
Total Number of SSOs with 1,000 gallons or more of sewage reaching the waters of the United States.	0	0
Average Response Time for SSOs (hours)	0.77	0.79
Repeated incidents of overflow at the same location.	0	0
Number of overflows caused by flows exceeding the capacity of the collection system.	0	0

Based on the monitoring and performance evaluations contained in this audit, the City has been very effective in keeping the number and total volume of SSOs in the City consistently low during 2011 and 2012. The response times to SSO events that did occur also met the City's targeted goal of responding to a SSO within two hours or less.

B. Program Modifications. Although the data for 2011 and 2012 shows the City's SSMP to be effective, the City Engineer recommends implementation of the following enhancements to the program:

- a. Additional Staff Training for Response to SSOs. The last training for City staff was in 2012. A refresher class needs to be scheduled for field staff on containment procedures for first responders. This will provide improved response and help to contain and mitigate SSOs until County sewer maintenance staff arrives to an incident location.

- b. Enhance efforts to eliminate chronic FOG problems in the sewer mainline. The work over the past two years to collaborate with LACDPW Industrial Waste Inspection staff to proactively schedule inspections of all restaurants citywide has been a good start in resolving chronic FOG problems. Although restaurants have been given Correction Notices requiring compliance with the industrial waste code, including retrofit of sub-standard plumbing equipment to bring kitchens into compliance for FOG control, there is continued follow up work needed. The Inspection and Code Compliance staff must make sure the restaurants install the required kitchen plumbing retrofits and the FOG equipment must be properly operated and maintained on an ongoing basis by the restaurants.

CERTIFICATION

I, the undersigned, do hereby certify that information contained in this audit report is to the best of my knowledge true.

Name (s)	Position	Signature	Date
Sharon Perlstein,	City Engineer	<i>Sharon Perlstein</i>	11/22/13

APPENDIX A

Maps of City Sewers

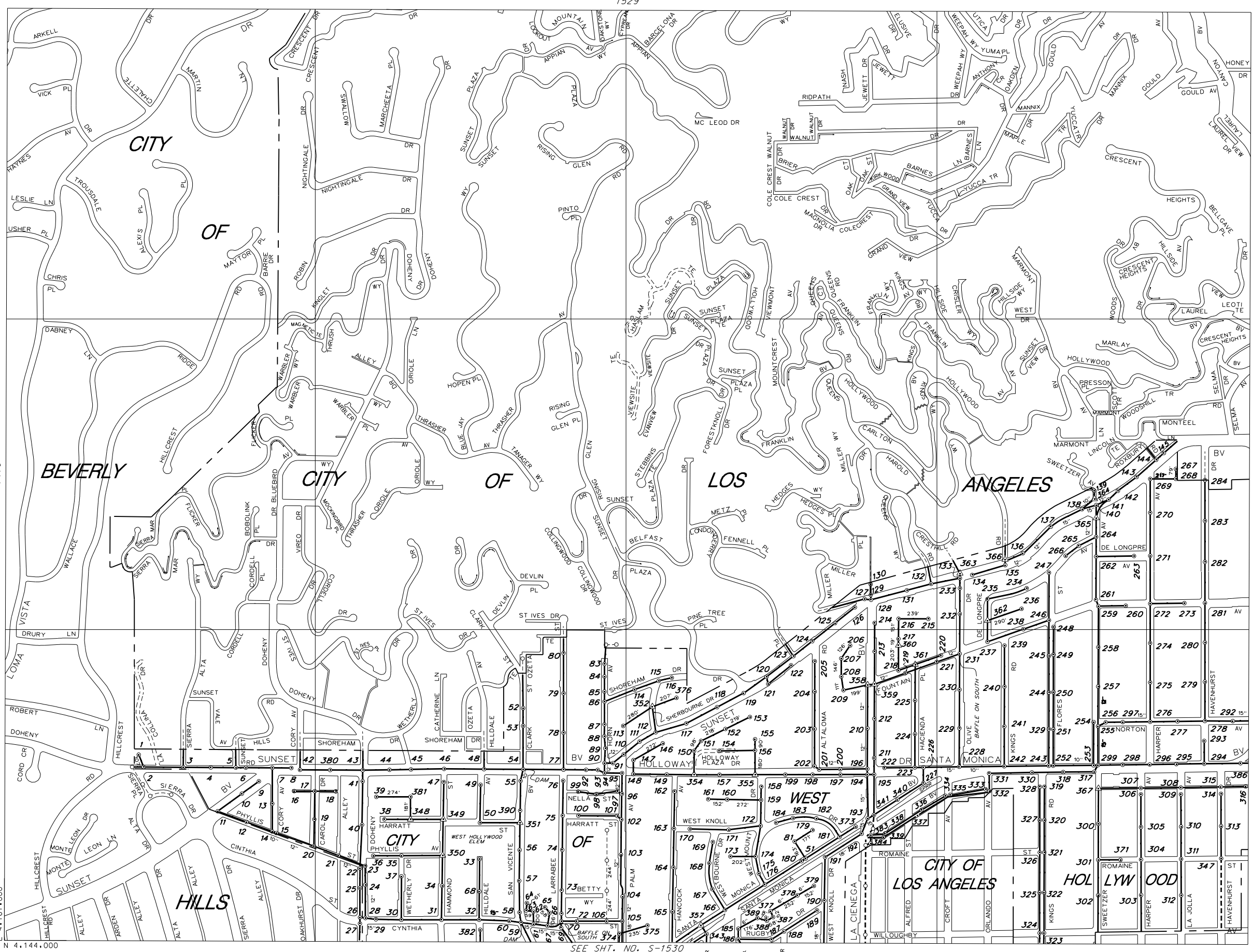

THIS MAP IS INTENDED FOR USE ONLY AS OPERATIONS MAP BY LOS ANGELES COUNTY SEWER MAINTENANCE DISTRICTS. LOS ANGELES COUNTY EXPRESSLY DISCLAIMS ANY LIABILITY FOR ANY INACCURACIES WHICH MAY BE PRESENT IN THIS MAP.

SEE SH. NO. S-1583

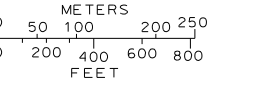
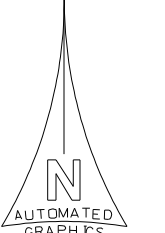

LEGEND

- CLAY SEWERS MAINTAINED BY SMD, 8" UNLESS OTHERWISE NOTED
- PLASTIC SEWERS
- CONCRETE SEWERS
- CLAY SEWERS, LINED
- CEMENT SEWERS, LINED
- FORCE MAINS
- - - SEWERS NOT MAINTAINED BY SMD
- TRUNK SEWERS
- CITY BOUNDARY
- STANDARD MANHOLE
- △ DROP MANHOLE
- SHALLOW MANHOLE
- ◇ TRAP MANHOLE
- ⊕ WEIR MANHOLE
- C.O. CLEANOUT
- L.H. LAMP HOLE
- PUMP STATION

TOTAL MH'S THIS MAP: 366

MAP REV 01-24-95
DATA BASE REV 01-24-95

SEE SH. NO. S-1530

SEE SHT. NO. S-1529



THIS MAP IS INTENDED FOR USE ONLY AS OPERATIONS MAP BY LOS ANGELES COUNTY SEWER MAINTENANCE DISTRICTS. LOS ANGELES COUNTY EXPRESSLY DISCLAIMS ANY LIABILITY FOR ANY INACCURACIES WHICH MAY BE PRESENT IN THIS MAP.

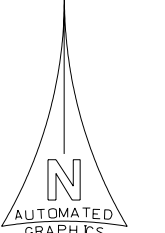

AUTOMATED GRAPHICS
METERS
0 50 100 200 250
FEET
0 200 400 600 800

LEGEND

- ○ ○ ○ ○ CLAY SEWERS MAINTAINED BY SMD, 8" UNLESS OTHERWISE NOTED
- ● ● ● ● PLASTIC SEWERS
- ○ ○ ○ ○ CONCRETE SEWERS
- ○ ○ ○ ○ CLAY SEWERS, LINED
- ○ ○ ○ ○ CEMENT SEWERS, LINED
- — — — — FORCE MAINS
- - - - - SEWERS NOT MAINTAINED BY SMD
- - - - - TRUNK SEWERS
- - - - - CITY BOUNDARY
- STANDARD MANHOLE
- △ DROP MANHOLE
- SHALLOW MANHOLE
- ◇ TRAP MANHOLE
- ⊕ WEIR MANHOLE
- C.D. ● CLEANOUT
- L.H. ● LAMP HOLE
- PUMP STATION

TOTAL MH'S THIS MAP: 314

MAP REV 11-01-05
DATA BASE REV 02-28-95

THIS MAP IS INTENDED FOR USE ONLY AS OPERATIONS MAP BY LOS ANGELES COUNTY SEWER MAINTENANCE DISTRICTS. LOS ANGELES COUNTY EXPRESSLY DISCLAIMS ANY LIABILITY FOR ANY INACCURACIES WHICH MAY BE PRESENT IN THIS MAP.

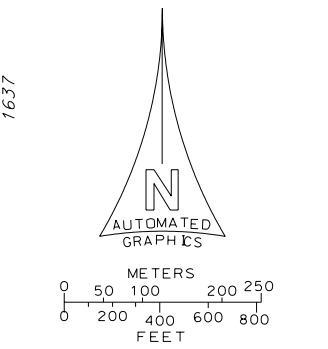

- LEGEND**
- ○ ○ ○ ○ CLAY SEWERS MAINTAINED BY SMD, 8" UNLESS OTHERWISE NOTED
 - ⋯⋯⋯ PLASTIC SEWERS
 - CONCRETE SEWERS
 - CLAY SEWERS, LINED
 - ⋯○⋯○⋯ CEMENT SEWERS, LINED
 - FORCE MAINS
 - - - SEWERS NOT MAINTAINED BY SMD
 - - - TRUNK SEWERS
 - - - CITY BOUNDARY
 - STANDARD MANHOLE
 - △ DROP MANHOLE
 - SHALLOW MANHOLE
 - ◇ TRAP MANHOLE
 - ⊕ WEIR MANHOLE
 - C.O. ● CLEANOUT
 - L.H. ● LAMP HOLE
 - PUMP STATION
- TOTAL MH'S THIS MAP: 201

SEE SHT. NO. S-1529

E 4.177.000
N 4.144.000

MAP REV
04-19-06
DATA BASE REV
04-19-06

APPENDIX B

Sanitary Sewer Overflow Reports

Sanitary Sewer Overflow (SSO) Summary

January 1, 2011 through December 31, 2012

SSO Event ID	Date	Location	Spill Volume (Gallons)	Spill Volume Recovered (Gallons)	Spill Volume to Reach Storm Drain/ Surface Waters (Gallons)	Spill Cause	Response Time by Sewer Maintenance Crew (Hours)	Corrective Action
763044	02/13/11	Robertson Blvd at Beverly Blvd	200.0	100.0	100.0	Root intrusion in sewer mainline	1.60	Cleaned pipe, added location to list for herbicide root control.
770821	09/01/11	Beverly Blvd at San Vicente Blvd	50.0	0.0	50.0	Grease blockage in sewer mainline	0.36	Cleaned pipe, added sewer to preventive maintenance program, referral to Industrial Waste for enforcement action against FOG source.
770824	09/01/11	8919 Beverly Blvd	200.0	200.0	0.0	Construction debris in sewer mainline	0.25	Cleaned pipe, had Public Works Inspector follow up with adjacent construction site to ensure proper construction debris disposal.
785758	08/28/12	8749 Sherbourne Drive	300.0	300.0	0.0	Root intrusion in sewer mainline	0.58	Cleaned pipe, added location to list for herbicide root control.
786192	09/10/12	Melrose Ave at San Vicente Blvd	400.0	100.0	300.0	Collapsed sewer mainline	1.00	Constructed point repair to replace broken mainline pipe.
Totals =			1150.0	700.0	450.0			



[Menu](#) | [Help](#) | [Log out](#)

Navigate to:

You are logged-in as: gtsolakyan west hollywood. If this account does not belong to you, please log out.

SSO - General Information ? | [SSO Menu](#)

SSO Event ID: 763044 Regional Water Board: Region 4 - Los Angeles
 Spill Location Name: 1530 - 0115 Agency: West Hollywood City
 WDID: 4SSO11368 Sanitary Sewer System: West Hollywood CS

[General Info](#) | [Spill Related Parties](#) | [Attachments](#)

Certified by Nicholas A. Agbobu (Senior Civil Engineer) on 02/17/2011 at Alhambra
 (Certification ID 430167)

[Amend](#)

Note: Questions with "*" are required to be answered to certify this report. You have minutes to save your report before your session expires. Questions with prefix 1. do not exist in Category 2.

Submit Draft On: 02/17/2011
 Last Updated By: Nicholas Agbobu West Hollywood
 1 - Spill Type: SSO Category 1
 2 - Version: 1

Physical Location Details

*3 - Spill location name:
 *4 - Latitude of spill location: deg. min. sec. OR decimal degrees [\[Show Map \]](#)
 *5 - Longitude of spill location: deg. min. sec. OR decimal degrees [\[Show Map \]](#)
 6 - Street number: 7 - Street direction:
 8 - Street name: 9 - Street type: 10 - Suite/Apt:
 11 - Cross street:
 12 - City: 13 - State: 14 - Zip:
 *15 - County:
 16 - Spill location description:
 (Use attachment if location description is more than 2000 charaters)
 *17 - Regional Water Quality Control Board:

Spill Details

*18 - Spill appearance point:
 (Hold Ctrl key to Select Multiple answers from the list)
 19 - Spill appearance point explanation:
 (Required if spill appearance point is "Other")
 *20 - Did the spill discharge to a drainage channel and/or surface water? [\(View History\)](#)
 *21 - Did the spill reach a separate (i.e.,not combined) storm drainpipe? [\(View History\)](#)
 *22 - If spill reached a separate storm drainpipe, was all of the wastewater fully captured from the separate storm drain and returned to the sanitary sewer system? [\(View History\)](#) [View](#)
 *23 - Private lateral spill? [\(View History\)](#)
 24 - Name of responsible party (for private lateral spill only, if known):
 *25 - Final spill destination:
 (Hold Ctrl key to Select Multiple answers from the list) [\(View History\)](#)
 26 - Explanation of final spill destination:
 (Required if final spill destination is "Other")
 *27 - Estimated spill volume: gallons [\(View History\)](#)
 *28 - Estimated volume of spill recovered: gallons [\(View History\)](#)

29 - Estimated current spill rate (if applicable): gallons per minute

*30 - Estimated spill start date/time: : Date Format: MM/DD/YYYY

*31 - Date and time sanitary sewer system agency was notified of or discovered spill: : Date Format: MM/DD/YYYY

*32 - Estimated Operator arrival date/time: : Date Format: MM/DD/YYYY

*33 - Estimated spill end date/time: : Date Format: MM/DD/YYYY

*34 - Spill cause:

35 - Spill cause explanation:
(Required if spill Cause is "Other")

*36 - Where did failure occur?

37 - Explanation of Where Failure Occurred:
(Required if Where Failure Occurred is "Other")

38 - If spill caused by wet weather, choose size of storm:

39 - Diameter of sewer pipe at the point of blockage or spill cause (if applicable): inches

40 - Material of sewer pipe at the point of blockage or spill cause (if applicable):

41 - Estimated age of sewer pipe at the point of blockage or spill cause (if applicable):

42 - Description of terrain surrounding the point of blockage or spill cause (if applicable):

*43 - Spill response activities:
(Hold Ctrl key to Select Multiple answers from the list)
 Cleaned-up (mitigated effects of spill)
 Contained all or portion of spill
 Inspected sewer using CCTV to determine cause

44 - Explanation of spill response activities:
(Required if spill response activities is "Other", use attachment if the text is more than 1700 characters)

*1.2 Spill response completion date: : Date Format: MM/DD/YYYY

45 - Visual inspection results from impacted receiving water:

*1.3 - Health warnings posted?

46a - Name of impacted beach(es) :

*46b - Name of impacted surface water(s):

*1.6 - Is there an ongoing investigation?

*1.7 - Water quality samples analyzed for:
(Hold Ctrl key to Select Multiple answers from the list)
 Dissolved oxygen
 Other chemical indicator(s) - specify below
 Biological indicator(s) - specify below

1.8 - Explanation of water quality samples analyzed for:
(Required if water quality samples analyzed for is "Other chemical indicator(s)", "Biological indicator(s)", or "Other")

*1.9 - Water quality sample results reported To:
(Hold Ctrl key to Select Multiple answers)
 County Health Agency
 Regional Water Quality Control Board
 None of the above

1.10 - Explanation of water quality sample results reported to:
(Required if water quality sample results reported to is "Other")

*1.11 - Spill corrective action taken:
(Hold Ctrl key to Select Multiple answers from the list)
 Added sewer to preventive maintenance program
 Adjusted schedule/method of preventive maintenance
 Enforcement action against FOG source

1.12 - Explanation of spill corrective action taken:
(Required if spill corrective action is "Other")

Notification Details

47 - OES Control Number
(Required for Category 1 - see SSO Monitoring and Reporting Program Requirements):

48 - OES Called Date/Time
(Required for Category 1 - see SSO Monitoring and Reporting Program Requirements): : Date Format: MM/DD/YYYY

*1.13 - County health agency notified:	<input checked="" type="checkbox"/> Yes
1.14 - Agency Name	<input type="text" value="Department of Public Health"/>
1.15 - Method Notification	<input type="text"/>
1.16 - Name of Staff Contacted	<input type="text"/>
1.17 - Phone Number of Staff Contacted	<input type="text"/>
1.18 - County health agency notified date/time: (required if County health agency notified is "Yes")	<input type="text" value="02/13/2011"/> <input type="text" value="10"/> : <input type="text" value="13"/> Date Format: MM/DD/YYYY
49 - Regional Water Quality Control Board notified date/time:	<input type="text" value="02/13/2011"/> <input type="text" value="10"/> : <input type="text" value="15"/> Date Format: MM/DD/YYYY
50 - Method Notification	<input type="text"/>
51 - Name of Staff Contacted	<input type="text"/>
52 - Phone Number of Staff Contacted	<input type="text"/>
53 - Other Agency Notified:	<input type="text"/>
54 - Was any of this spill report information submitted via fax (or electronically) to the Regional Water Quality Control Board?	<input checked="" type="checkbox"/> Yes
55 - Date and time spill report information was submitted via fax (or electronically) to the Regional Water quality Control Board: (required if spill report information submitted via fax to Regional Water Board is "Yes")	<input type="text" value="02/13/2011"/> <input type="text" value="13"/> : <input type="text" value="15"/> Date Format: MM/DD/YYYY
<input type="button" value="Amend"/>	

Note: Questions with "*" are required to be answered to certify this report.



[Menu](#) | [Help](#) | [Log out](#)

Navigate to:

You are logged-in as: gtsolakyan west hollywood. If this account does not belong to you, please log out.

SSO - General Information [SSO Menu](#)

SSO Event ID: 770821 Regional Water Board: Region 4 - Los Angeles
 Spill Location Name: 1530-0226 Agency: West Hollywood City
 WDID: 4SSO11368 Sanitary Sewer System: West Hollywood CS

[General Info](#) [Spill Related Parties](#) [Attachments](#)

Certified by Nicholas A. Agbobu (Senior Civil Engineer) on 09/07/2011 at Alhambra
 (Certification ID 626907)

[Amend](#)

Note: Questions with ** are required to be answered to certify this report. You have minutes to save your report before your session expires.
 Questions with prefix 1. do not exist in Category 2.

Submit Draft On: 09/07/2011
 Last Updated By: [Nicholas Agbobu](#)
 1 - Spill Type: SSO Category 1
 2 - Version: 1

Physical Location Details

*3 - Spill location name:
 *4 - Latitude of spill location: deg. min. sec. OR decimal degrees [\[Show Map \]](#)
 *5 - Longitude of spill location: deg. min. sec. OR decimal degrees [\[Show Map \]](#)
 6 - Street number: 7 - Street direction:
 8 - Street name: 9 - Street type: 10 - Suite/Apt:
 11 - Cross street:
 12 - City: 13 - State: 14 - Zip:
 *15 - County:

16 - Spill location description:
 (Use attachment if location description is more than 2000 characters)

*17 - Regional Water Quality Control Board:

Spill Details

*18 - Spill appearance point:
 (Hold Ctrl key to Select Multiple answers from the list)

19 - Spill appearance point explanation:
 (Required if spill appearance point is "Other")

*20 - Did the spill discharge to a drainage channel and/or surface water? Yes [\(View History\)](#)

*21 - Did the spill reach a separate (i.e., not combined) storm drainpipe? Yes [\(View History\)](#)

*22 - If spill reached a separate storm drainpipe, was all of the wastewater fully captured from the separate storm drain and returned to the sanitary sewer system? [\(View History\)](#) [View](#)

*23 - Private lateral spill? [\(View History\)](#)

24 - Name of responsible party (for private lateral spill only, if known):

*25 - Final spill destination:
 (Hold Ctrl key to Select Multiple answers from the list)

 [\(View History\)](#)

26 - Explanation of final spill destination:
 (Required if final spill destination is "Other")

*27 - Estimated spill volume: gallons (View History)

*28 - Estimated volume of spill recovered: gallons (View History)

*1.1 - Estimated volume (greater than 0) of spill that reached surface water, drainage channel, or not recovered from a separate storm drain: gallons (View History)

29 - Estimated current spill rate (if applicable): gallons per minute

*30 - Estimated spill start date/time: : Date Format: MM/DD/YYYY

*31 - Date and time sanitary sewer system agency was notified of or discovered spill: : Date Format: MM/DD/YYYY

*32 - Estimated Operator arrival date/time: : Date Format: MM/DD/YYYY

*33 - Estimated spill end date/time: : Date Format: MM/DD/YYYY

*34 - Spill cause:

35 - Spill cause explanation: (Required if spill Cause is "Other")

*36 - Where did failure occur?

37 - Explanation of Where Failure Occurred: (Required if Where Failure Occurred is "Other")

38 - If spill caused by wet weather, choose size of storm:

39 - Diameter of sewer pipe at the point of blockage or spill cause (if applicable): inches

40 - Material of sewer pipe at the point of blockage or spill cause (if applicable):

41 - Estimated age of sewer pipe at the point of blockage or spill cause (if applicable):

42 - Description of terrain surrounding the point of blockage or spill cause (if applicable):

*43 - Spill response activities: (Hold Ctrl key to Select Multiple answers from the list)
 Cleaned-up (mitigated effects of spill)
 Contained all or portion of spill
 Inspected sewer using CCTV to determine cause

44 - Explanation of spill response activities: (Required if spill response activities is "Other", use attachment if the text is more than 1700 characters)

*1.2 Spill response completion date: : Date Format: MM/DD/YYYY

45 - Visual inspection results from impacted receiving water:

*1.3 - Health warnings posted?

46a - Name of impacted beach(es) :

*46b - Name of impacted surface water(s):

*1.6 - Is there an ongoing investigation?

*1.7 - Water quality samples analyzed for: (Hold Ctrl key to Select Multiple answers from the list)
 Dissolved oxygen
 Other chemical indicator(s) - specify below
 Biological indicator(s) - specify below

1.8 - Explanation of water quality samples analyzed for: (Required if water quality samples analyzed for is "Other chemical indicator(s)", "Biological indicator(s)", or "Other")

*1.9 - Water quality sample results reported To: (Hold Ctrl key to Select Multiple answers)
 County Health Agency
 Regional Water Quality Control Board
 None of the above

1.10 - Explanation of water quality sample results reported to: (Required if water quality sample results reported to is "Other")

*1.11 - Spill corrective action taken:
(Hold Ctrl key to Select Multiple answers from the list)

Added sewer to preventive maintenance program
Adjusted schedule/method of preventive maintenance
Enforcement action against FOG source

1.12 - Explanation of spill corrective action taken:
(Required if spill corrective action is "Other")

Mainline will be televised to determine if further action is needed.

Notification Details

47 - OES Control Number
(Required for Category 1 - see SSO Monitoring and Reporting Program Requirements):

115206

48 - OES Called Date/Time
(Required for Category 1 - see SSO Monitoring and Reporting Program Requirements):

09/01/2011 10:00 Date Format: MM/DD/YYYY

*1.13 - County health agency notified:

Yes

1.14 - Agency Name

Department of Public Health

1.15 - Method Notification

1.16 - Name of Staff Contacted

1.17 - Phone Number of Staff Contacted

1.18 - County health agency notified date/time:
(required if County health agency notified is "Yes")

09/01/2011 10:04 Date Format: MM/DD/YYYY

49 - Regional Water Quality Control Board notified date/time:

09/01/2011 10:09 Date Format: MM/DD/YYYY

50 - Method Notification

51 - Name of Staff Contacted

52 - Phone Number of Staff Contacted

53 - Other Agency Notified:

LA County Flood Control

54 - Was any of this spill report information submitted via fax (or electronically) to the Regional Water Quality Control Board?

Yes

55 - Date and time spill report information was submitted via fax (or electronically) to the Regional Water quality Control Board:
(required if spill report information submitted via fax to Regional Water Board is "Yes")

09/02/2011 07:40 Date Format: MM/DD/YYYY

Amend

Note: Questions with * are required to be answered to certify this report.



[Menu](#) | [Help](#) | [Log out](#)

Navigate to:

You are logged-in as: gtsolakyan west hollywood. If this account does not belong to you, please log out.

SSO - General Information [SSO Menu](#)

SSO Event ID:	770824	Regional Water Board:	Region 4 - Los Angeles
Spill Location Name:	1530-0131 (8919 & 8899 Beverly Blvd.)	Agency:	West Hollywood City
WDID:	4SSO11368	Sanitary Sewer System:	West Hollywood CS

[General Info](#) [Spill Related Parties](#) [Attachments](#)

Certified by Nicholas A. Agbobu (Senior Civil Engineer) on 09/07/2011 at Alhambra
(Certification ID 818836)

Note: Questions with ** are required to be answered to certify this report. You have minutes to save your report before your session expires. Questions with prefix 1. do not exist in Category 2.

Submit Draft On: 09/07/2011
 Last Updated By: [Nicholas Agbobu](#)
 1 - Spill Type: SSO Category 2
 2 - Version: 1

Physical Location Details

*3 - Spill location name:
 *4 - Latitude of spill location: deg. min. sec. OR decimal degrees [\[Show Map \]](#)
 *5 - Longitude of spill location: deg. min. sec. OR decimal degrees [\[Show Map \]](#)
 6 - Street number: 7 - Street direction:
 8 - Street name: 9 - Street type: 10 - Suite/Apt:
 11 - Cross street:
 12 - City: 13 - State: 14 - Zip:
 *15 - County:
 16 - Spill location description:
(Use attachment if location description is more than 2000 charaters)
 *17 - Regional Water Quality Control Board:

Spill Details

*18 - Spill appearance point:
(Hold Ctrl key to Select Multiple answers from the list)

 19 - Spill appearance point explanation:
(Required if spill appearance point is "Other")
 *20 - Did the spill discharge to a drainage channel and/or surface water? [\(View History\)](#)
 *21 - Did the spill reach a separate (i.e.,not combined) storm drainpipe? [\(View History\)](#)
 *22 - If spill reached a separate storm drainpipe, was all of the wastewater fully captured from the separate storm drain and returned to the sanitary sewer system? [\(View History\)](#) [\(View\)](#)
 *23 - Private lateral spill? [\(View History\)](#)
 24 - Name of responsible party (for private lateral spill only, if known):
 *25 - Final spill destination:
(Hold Ctrl key to Select Multiple answers from the list)

 [\(View History\)](#)
 26 - Explanation of final spill destination:
(Required if final spill destination is "Other")

*27 - Estimated spill volume: gallons (View History)

28 - Estimated volume of spill recovered: gallons (View History)

29 - Estimated current spill rate (if applicable): gallons per minute

*30 - Estimated spill start date/time: : Date Format: MM/DD/YYYY

*31 - Date and time sanitary sewer system agency was notified of or discovered spill: : Date Format: MM/DD/YYYY

*32 - Estimated Operator arrival date/time: : Date Format: MM/DD/YYYY

*33 - Estimated spill end date/time: : Date Format: MM/DD/YYYY

*34 - Spill cause:

35 - Spill cause explanation:
(Required if spill Cause is "Other")

*36 - Where did failure occur?

37 - Explanation of Where Failure Occurred:
(Required if Where Failure Occurred is "Other")

38 - If spill caused by wet weather, choose size of storm:

39 - Diameter of sewer pipe at the point of blockage or spill cause (if applicable): inches

40 - Material of sewer pipe at the point of blockage or spill cause (if applicable):

41 - Estimated age of sewer pipe at the point of blockage or spill cause (if applicable):

42 - Description of terrain surrounding the point of blockage or spill cause (if applicable):

*43 - Spill response activities:
(Hold Ctrl key to Select Multiple answers from the list) Cleaned-up (mitigated effects of spill)
 Contained all or portion of spill
 Inspected sewer using CCTV to determine cause

44 - Explanation of spill response activities:
(Required if spill response activities is "Other", use attachment if the text is more than 1700 characters)

45 - Visual inspection results from impacted receiving water:

46a - Name of impacted beach(es) :

*46b - Name of impacted surface water(s):

Notification Details

47 - OES Control Number
(Required for Category 1 - see SSO Monitoring and Reporting Program Requirements):

48 - OES Called Date/Time
(Required for Category 1 - see SSO Monitoring and Reporting Program Requirements): : Date Format: MM/DD/YYYY

49 - Regional Water Quality Control Board notified date/time: : Date Format: MM/DD/YYYY

50 - Method Notification

51 - Name of Staff Contacted

52 - Phone Number of Staff Contacted

53 - Other Agency Notified:

54 - Was any of this spill report information submitted via fax (or electronically) to the Regional Water Quality Control Board? Yes

55 - Date and time spill report information was submitted via fax (or electronically) to the Regional Water quality Control Board:
(required if spill report information submitted via fax to Regional Water Board is "Yes") : Date Format: MM/DD/YYYY

Amend

*Note: Questions with ** are required to be answered to certify this report.*

© 2010 State of California. [Conditions of Use](#) [Privacy Policy](#)



[Menu](#) | [Help](#) | [Log out](#)

Navigate to:

You are logged-in as: gtsolakyan. If this account does not belong to you, please log out.

SSO - General Information [SSO Menu](#)

SSO Event ID:	785758	Regional Water Board:	Region 4 - Los Angeles
Spill Location Name:	1529 - 8749 Sherbourne Drive	Agency:	West Hollywood City
WDID:	4SSO11368	Sanitary Sewer System:	West Hollywood CS

[General Info](#) | [Spill Related Parties](#) | [Attachments](#)

Certified by Nicholas A. Agbobu (Senior Civil Engineer) on 10/11/2012 at Alhambra
(Certification ID 471117)

Note: Questions with "*" are required to be answered to certify this report. You have minutes to save your report before your session expires. Questions with prefix 1. do not exist in Category 2.

Submit Draft On: 08/30/2012
 Last Updated By: [Nicholas Agbobu](#)
 1 - Spill Type: SSO Category 2
 2 - Version: 2.1

Physical Location Details

* 3 - Spill location name:

* 4 - Latitude of spill location: deg. min. sec. OR decimal degrees [\[Show Map \]](#)

* 5 - Longitude of spill location: deg. min. sec. OR decimal degrees [\[Show Map \]](#)

6 - Street number: 7 - Street direction:

8 - Street name: 9 - Street type: 10 - Suite/Apt:

11 - Cross street:

12 - City: 13 - State: 14 - Zip:

* 15 - County:

16 - Spill location description:
(Use attachment if location description is more than 2000 characters)

* 17 - Regional Water Quality Control Board:

Spill Details

* 18 - Spill appearance point:
(Hold Ctrl key to Select Multiple answers from the list)

19 - Spill appearance point explanation:
(Required if spill appearance point is "Other")

* 20 - Did the spill discharge to a drainage channel and/or surface water? [\(View History\)](#)

* 21 - Did the spill reach a separate (i.e., not combined) storm drainpipe? [\(View History\)](#)

* 22 - If spill reached a separate storm drainpipe, was all of the wastewater fully captured from the separate storm drain and returned to the sanitary sewer system? [\(View History\)](#) [View](#)

* 23 - Private lateral spill? [\(View History\)](#)

24 - Name of responsible party (for private lateral spill only, if known):

* 25 - Final spill destination:
(Hold Ctrl key to Select Multiple answers from the list)

 [\(View History\)](#)

26 - Explanation of final spill destination:
(Required if final spill destination is "Other")

*27 - Estimated spill volume: gallons ([View History](#))

28 - Estimated volume of spill recovered: gallons ([View History](#))

*1.1 - Estimated volume (greater than 0) of spill that reached surface water, drainage channel, or not recovered from a separate storm drain: gallons ([View History](#))

29 - Estimated current spill rate (if applicable): gallons per minute

*30 - Estimated spill start date/time: : Date Format: MM/DD/YYYY

*31 - Date and time sanitary sewer system agency was notified of or discovered spill: : Date Format: MM/DD/YYYY

*32 - Estimated Operator arrival date/time: : Date Format: MM/DD/YYYY

*33 - Estimated spill end date/time: : Date Format: MM/DD/YYYY

*34 - Spill cause:

35 - Spill cause explanation:
(Required if spill Cause is "Other")

*36 - Where did failure occur?

37 - Explanation of Where Failure Occurred:
(Required if Where Failure Occurred is "Other")

38 - If spill caused by wet weather, choose size of storm:

39 - Diameter of sewer pipe at the point of blockage or spill cause (if applicable): inches

40 - Material of sewer pipe at the point of blockage or spill cause (if applicable):

41 - Estimated age of sewer pipe at the point of blockage or spill cause (if applicable):

42 - Description of terrain surrounding the point of blockage or spill cause (if applicable):

*43 - Spill response activities:
(Hold Ctrl key to Select Multiple answers from the list) Cleaned-up (mitigated effects of spill) Contained all or portion of spill Inspected sewer using CCTV to determine cause

44 - Explanation of spill response activities:
(Required if spill response activities is "Other", use attachment if the text is more than 1700 characters)

45 - Visual inspection results from impacted receiving water:

46a - Name of impacted beach(es):

*46b - Name of impacted surface water(s):

Notification Details

47 - OES Control Number
(Required for Category 1 - see SSO Monitoring and Reporting Program Requirements):

48 - OES Called Date/Time : Date Format: MM/DD/YYYY
(Required for Category 1 - see SSO Monitoring and Reporting Program Requirements):

49 - Regional Water Quality Control Board notified date/time: : Date Format: MM/DD/YYYY

50 - Method Notification

51 - Name of Staff Contacted

52 - Phone Number of Staff Contacted

53 - Other Agency Notified:

54 - Was any of this spill report information submitted via fax (or electronically) to the Regional Water Quality Control Board?

55 - Date and time spill report information was submitted via fax (or electronically) to the Regional Water quality Control Board: (required if spill report information submitted via fax to Regional Water Board is "Yes")

08/29/2012



13

45

Date Format: MM/DD/YYYY

Amend

Note: Questions with "*" are required to be answered to certify this report.

© 2012 State of California. [Conditions of Use](#) [Privacy Policy](#)



[Menu](#) | [Help](#) | [Log out](#)

Navigate to:

You are logged-in as: gtsolakyen. If this account does not belong to you, please log out.

SSO - General Information

[SSO Menu](#)

SSO Event ID:	786192	Regional Water Board:	Region 4 - Los Angeles
Spill Location Name:	1530 - 8710 Melrose Avenue	Agency:	West Hollywood City
WDID:	4SSO11368	Sanitary Sewer System:	West Hollywood CS

[General Info](#) | [Spill Related Parties](#) | [Attachments](#)

Certified by Nicholas A. Agbobu (Senior Civil Engineer) on 09/13/2012 at Alhambra
(Certification ID 526812)

Note: Questions with "*" are required to be answered to certify this report. You have minutes to save your report before your session expires. Questions with prefix 1. do not exist in Category 2.

Submit Draft On: 09/13/2012
 Last Updated By: [Nicholas Agbobu](#)
 1 - Spill Type: SSO Category 1
 2 - Version: 1.1

Physical Location Details

*3 - Spill location name:

*4 - Latitude of spill location: deg. min. sec. OR decimal degrees [\[Show Map \]](#)

*5 - Longitude of spill location: deg. min. sec. OR decimal degrees [\[Show Map \]](#)

6 - Street number: 7 - Street direction:

8 - Street name: 9 - Street type: 10 - Suite/Apt:

11 - Cross street:

12 - City: 13 - State: 14 - Zip:

*15 - County:

16 - Spill location description:
(Use attachment if location description is more than 2000 characters)

*17 - Regional Water Quality Control Board:

Spill Details

*18 - Spill appearance point:
(Hold Ctrl key to Select Multiple answers from the list)

19 - Spill appearance point explanation:
(Required if spill appearance point is "Other")

*20 - Did the spill discharge to a drainage channel and/or surface water? [\(View History\)](#)

*21 - Did the spill reach a separate (i.e.,not combined) storm drainpipe? [\(View History\)](#)

*22 - If spill reached a separate storm drainpipe, was all of the wastewater fully captured from the separate storm drain and returned to the sanitary sewer system? [\(View History\)](#) [\(View\)](#)

*23 - Private lateral spill? [\(View History\)](#)

24 - Name of responsible party (for private lateral spill only, if known):

*25 - Final spill destination:
(Hold Ctrl key to Select Multiple answers from the list)
 [\(View History\)](#)

26 - Explanation of final spill destination:
(Required if final spill destination is "Other")

*27 - Estimated spill volume: gallons [View History](#)

*28 - Estimated volume of spill recovered: gallons [View History](#)

*1.1 - Estimated volume (greater than 0) of spill that reached surface water, drainage channel, or not recovered from a separate storm drain: gallons [View History](#)

29 - Estimated current spill rate (if applicable): gallons per minute

*30 - Estimated spill start date/time: : Date Format: MM/DD/YYYY

*31 - Date and time sanitary sewer system agency was notified of or discovered spill: : Date Format: MM/DD/YYYY

*32 - Estimated Operator arrival date/time: : Date Format: MM/DD/YYYY

*33 - Estimated spill end date/time: : Date Format: MM/DD/YYYY

*34 - Spill cause:

35 - Spill cause explanation:
(Required if spill Cause is "Other")

*36 - Where did failure occur?

37 - Explanation of Where Failure Occurred:
(Required if Where Failure Occurred is "Other")

38 - If spill caused by wet weather, choose size of storm:

39 - Diameter of sewer pipe at the point of blockage or spill cause (if applicable): inches

40 - Material of sewer pipe at the point of blockage or spill cause (if applicable):

41 - Estimated age of sewer pipe at the point of blockage or spill cause (if applicable):

42 - Description of terrain surrounding the point of blockage or spill cause (if applicable):

*43 - Spill response activities:
(Hold Ctrl key to Select Multiple answers from the list)

44 - Explanation of spill response activities:
(Required if spill response activities is "Other", use attachment if the text is more than 1700 characters)

*1.2 Spill response completion date: : Date Format: MM/DD/YYYY

45 - Visual inspection results from impacted receiving water:

*1.3 - Health warnings posted?

46a - Name of impacted beach(es) :

*46b - Name of impacted surface water(s):

*1.6 - Is there an ongoing investigation?

*1.7 - Water quality samples analyzed for:
(Hold Ctrl key to Select Multiple answers from the list)

1.8 - Explanation of water quality samples analyzed for:
(Required if water quality samples analyzed for is "Other chemical indicator(s)", "Biological indicator(s)", or "Other")

*1.9 - Water quality sample results reported To:
(Hold Ctrl key to Select Multiple answers)

1.10 - Explanation of water quality sample results reported to:
(Required if water quality sample results reported to is "Other")

***1.11 - Spill corrective action taken:**
 (Hold Ctrl key to Select Multiple answers from the list)

Added sewer to preventive maintenance program
 Adjusted schedule/method of preventive maintenance
 Enforcement action against FOG source

1.12 - Explanation of spill corrective action taken:
 (Required if spill corrective action is "Other")

Mainline will be televised to determine if further actions are needed.

Notification Details

47 - OES Control Number
 (Required for Category 1 - see SSO Monitoring and Reporting Program Requirements):

125445

48 - OES Called Date/Time
 (Required for Category 1 - see SSO Monitoring and Reporting Program Requirements):

09/10/2012 15:25 Date Format: MM/DD/YYYY

***1.13 - County health agency notified:**

Yes

1.14 - Agency Name

Department of Public Health

1.15 - Method Notification

1.16 - Name of Staff Contacted

1.17 - Phone Number of Staff Contacted

1.18 - County health agency notified date/time:
 (required if County health agency notified is "Yes")

09/10/2012 15:20 Date Format: MM/DD/YYYY

49 - Regional Water Quality Control Board notified date/time:

09/10/2012 15:26 Date Format: MM/DD/YYYY

50 - Method Notification

51 - Name of Staff Contacted

52 - Phone Number of Staff Contacted

53 - Other Agency Notified:

L.A. County Flood Mainte

54 - Was any of this spill report information submitted via fax (or electronically) to the Regional Water Quality Control Board?

Yes

55 - Date and time spill report information was submitted via fax (or electronically) to the Regional Water quality Control Board:
 (required if spill report information submitted via fax to Regional Water Board is "Yes")

09/11/2012 07:18 Date Format: MM/DD/YYYY

Amend

Note: Questions with "*" are required to be answered to certify this report.

APPENDIX C

LACDPW Sewer Maintenance Productivity Reports and Periodics Reports Preventive Maintenance History

**SEWER MAINTENANCE PRODUCTIVITY REPORT
COLLECTION SYSTEM - DIVISION LEVEL
FIELD WORK COMPLETED: January 1, 2011 to December 31, 2011
City of West Hollywood**

Total Pipe Length (feet) as of December 31, 2011: 208,302

Total Manholes as of December 31, 2011: 885

PREVENTIVE MAINTENANCE ACTIVITIES

Sewer Pipe

- Hydro Cleaned (feet): 162,213
 - Periodic Cleaning (feet): 128,399
- Mechanically Rodded (feet): 74,787
 - Periodic Cleaning (feet): 68,456

Manholes

- Inspected: 1,770
- Adjusted: 4

SERVICE REQUESTS

Responded to:

- Service Requests Responded to: 30
- False Alarms: 13
- Stoppages: 0
- Overflows: 8
- Floodouts: 0
- Roach Complaints: 0
- Misc.: 9
- Others: 0

TELEVISIONING

Feet Televised: 1,119

ROOT CONTROL

Sewer Pipe Treated for Roots (feet): 0

CONSTRUCTION

Saddle Installation(s): 0

PUMP STATIONS

Total Number of Pump Stations: 0

Total Routine Maintenance/Repair: 0

Total Major Repairs: 0

Total Emergency Response: 0

ANNEXATIONS

Parcel(s) Annexed to the District: 0

ACCUMULATIVE CAPITAL OUTLAY PROJECTS

Sewer Projects Reconstructed/Rehabilitated: 0

**SEWER MAINTENANCE PRODUCTIVITY REPORT
COLLECTION SYSTEM - DIVISION LEVEL
FIELD WORK COMPLETED: January 1, 2012 to December 31, 2012
City of West Hollywood**

Total Pipe Length (feet) as of December 31, 2012: 208,302

Total Manholes as of December 31, 2012: 885

PREVENTIVE MAINTENANCE ACTIVITIES

Sewer Pipe

- Hydro Cleaned (feet): 150,863
 - Periodic Cleaning (feet): 121,273
- Mechanically Rodded (feet): 60,069
 - Periodic Cleaning (feet): 53,398

Manholes

- Inspected: 1,770
- Adjusted: 38

SERVICE REQUESTS

Responded to:

- Service Requests Responded to: 35
- False Alarms: 19
- Stoppages: 1
- Overflows: 2
- Floodouts: 0
- Roach Complaints: 0
- Misc.: 1
- Others: 10

TELEVISIONING

Feet Televised: 3,052

ROOT CONTROL

Sewer Pipe Treated for Roots (feet): 0

CONSTRUCTION

Saddle Installation(s): 0

PUMP STATIONS

Total Number of Pump Stations: 0

Total Routine Maintenance/Repair: 0

Total Major Repairs: 0

Total Emergency Response: 0

ANNEXATIONS

Parcel(s) Annexed to the District: 0

ACCUMULATIVE CAPITAL OUTLAY PROJECTS

Sewer Projects Reconstructed/Rehabilitated: 0

MAINTENANCE MAP PERIODICS

CITY OF
West Hollywood
SUPERVISORIAL DISTRICT 1

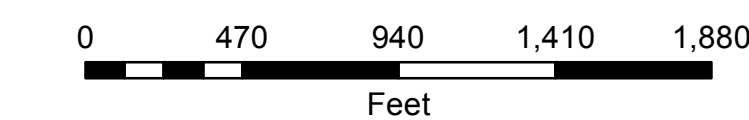
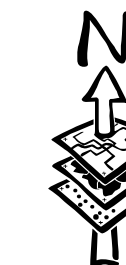
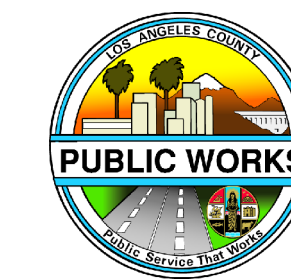

Legend

Periodics

- 30 DAYS
- 60 DAYS
- 90 DAYS
- 120 DAYS
- 150 DAYS
- 180 DAYS
- 12 MONTHS
- 15 MONTHS
- 18 MONTHS

SMD Manholes

- Standard
- ▲ DROP
- Shallow
- ◆ Trap
- Siphon
- P SMD Pump Stations

SMD Sewers

- Gravity Sewers
- Force Mains
- Siphons
- SMD Trunk MH
- SMD Trunks
- SMD Operations Maps

Cities

- Beverly Hills
- Los Angeles
- West Hollywood
- Unincorporated
- SMD Operations Maps

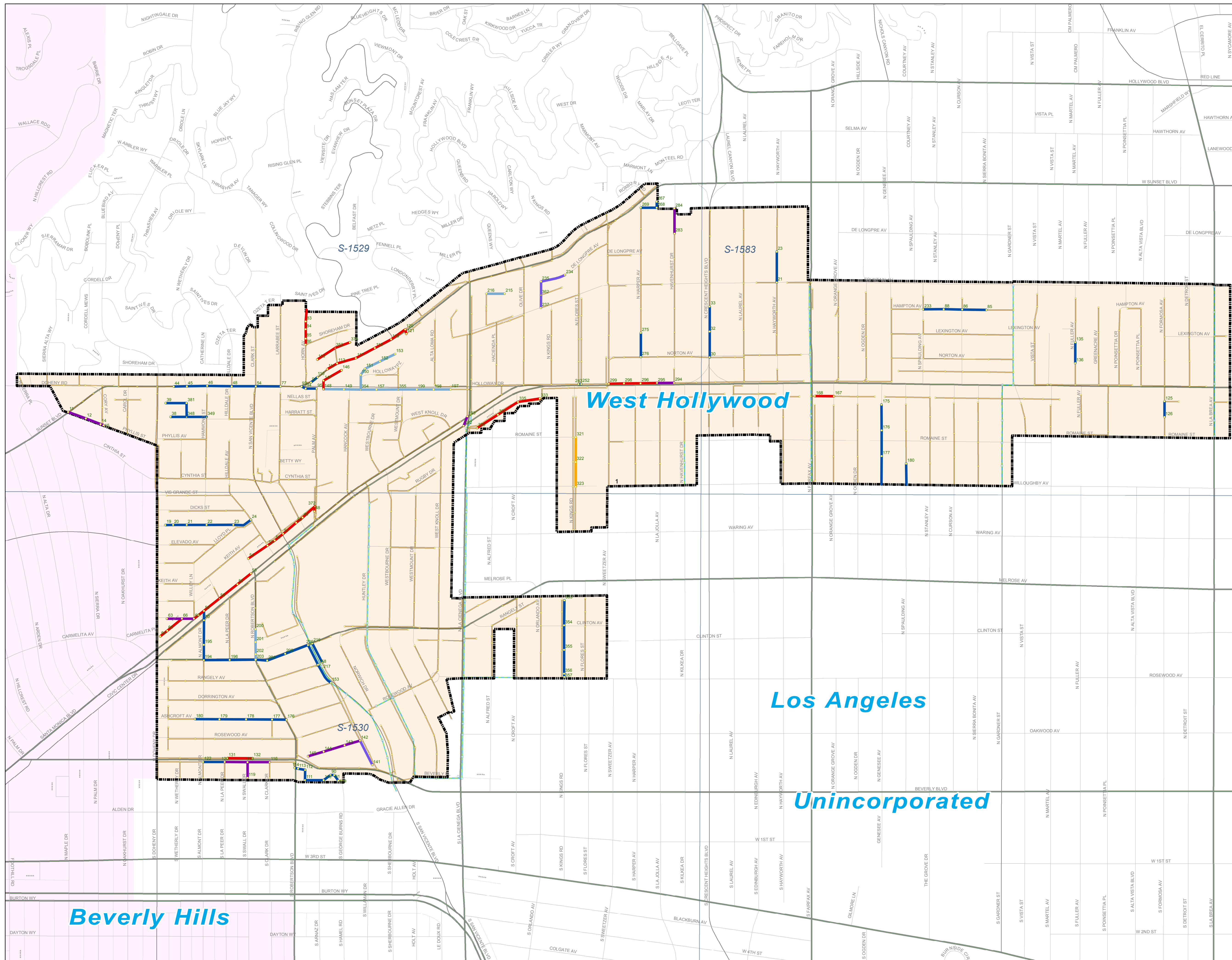

Beverly Hills

West Hollywood

Los Angeles

Unincorporated

Periodics Report for City of West Hollywood

Year 2011 - Year 2012

DESCRIPTION	PIPE_LOCN	DAYS MONTHS	START YEAR	PIPE LENGTH	Y2011	Y2012
PM S09C0629						
H: Mapsheet No. 1529 Santa Monica Blvd From Mh 294 To Mh 295	0294/1529-0295/1529	120 DAYS	6/4/2005	224	672	672
Summary for 'PM' = S09C0629				224	672	672
PM S09C0635						
H: Mapsheet No. 1529 Santa Monica Bl From Mh 243 To Mh 252	0243/1529-0252/1529	90 DAYS	2/18/2006	35	140	140
Summary for 'PM' = S09C0635				35	140	140
PM S09S00035						
H: Mapsheet No. 1529 -Phyllis Avenue: Mh 11 to 15	0014/1529-0015/1529	120 DAYS	9/22/2001	36	108	108
H: Mapsheet No. 1529 -Phyllis Avenue: Mh 11 to 15	0011/1529-0012/1529	120 DAYS	9/22/2001	173	519	519
H: Mapsheet No. 1529 -Phyllis Avenue: Mh 11 to 15	0012/1529-0014/1529	120 DAYS	9/22/2001	327	981	981
Summary for 'PM' = S09S00035				536	1,608	1,608
PM S09S00037						
H: Mapsheet No. 1529 - R/W N/O Holloway Drive: Mh 354D to 153	0150/1529-0151/1529	30 DAYS	8/4/2001	98	1,176	1,176
H: Mapsheet No. 1529 - R/W N/O Holloway Drive: Mh 354D to 153	0152/1529-0153/1529	30 DAYS	8/4/2001	219	2,628	2,628
H: Mapsheet No. 1529 - R/W N/O Holloway Drive: Mh 354D to 153	0151/1529-0152/1529	30 DAYS	8/4/2001	218	2,616	2,616
H: Mapsheet No. 1529 - R/W N/O Holloway Drive: Mh 354D to 153	0150/1529-0354/1529	30 DAYS	8/4/2001	192	2,304	2,304
Summary for 'PM' = S09S00037				727	8,724	8,724
PM S09S00038						
H: Mapsheet No. 1529 - R/W N/O Holloway Drive: Mh 148 to 146	0147/1529-0148/1529	60 DAYS	9/26/2001	112	672	672
H: Mapsheet No. 1529 - R/W N/O Holloway Drive: Mh 148 to 146	0146/1529-0147/1529	60 DAYS	9/26/2001	272	1,632	1,632
Summary for 'PM' = S09S00038				384	2,304	2,304
PM S09S00039						
H: Mapsheet No. 1529 -Sunset Blvd: Mh 121 to 91	0120/1529-0121/1529	60 DAYS	9/22/2001	59	354	354
H: Mapsheet No. 1529 -Sunset Blvd: Mh 121 to 91	0118/1529-0119/1529	60 DAYS	9/22/2001	242	1,452	1,452
H: Mapsheet No. 1529 -Sunset Blvd: Mh 121 to 91	0112/1529-0117/1529	60 DAYS	9/22/2001	256	1,536	1,536
H: Mapsheet No. 1529 -Sunset Blvd: Mh 121 to 91	0117/1529-0118/1529	60 DAYS	9/22/2001	281	1,686	1,686
H: Mapsheet No. 1529 -Sunset Blvd: Mh 121 to 91	0111/1529-0112/1529	60 DAYS	9/22/2001	149	894	894
H: Mapsheet No. 1529 -Sunset Blvd: Mh 121 to 91	0119/1529-0120/1529	60 DAYS	9/22/2001	226	1,356	1,356
Summary for 'PM' = S09S00039				1,213	7,278	7,278

Periodics Report for City of West Hollywood

Year 2011 - Year 2012

DESCRIPTION	PIPE_LOCN	DAYS MONTHS	START YEAR	PIPE LENGTH	Y2011	Y2012
PM S09S00041						
H: Mapsheet No. 1529 -R/W E/O Harper : MH #269 to #267	0268/1529-0269/1529	90 DAYS	3/14/2001	217	868	868
H: Mapsheet No. 1529 -R/W E/O Harper : MH #269 to #267	0267/1529-0268/1529	90 DAYS	3/14/2001	79	316	316
Summary for 'PM' = S09S00041				296	1,184	1,184
PM S09S00043						
H: Mapsheet No. 1529 - Alley S/O Santa Monica Blvd: Mh 339 to 333	0337/1529-0339/1529	60 DAYS	3/7/2001	324	1,944	1,944
H: Mapsheet No. 1529 - Alley S/O Santa Monica Blvd: Mh 339 to 333	0333/1529-0335/1529	60 DAYS	3/7/2001	289	1,734	1,734
H: Mapsheet No. 1529 - Alley S/O Santa Monica Blvd: Mh 339 to 333	0335/1529-0337/1529	60 DAYS	3/7/2001	310	1,860	1,860
Summary for 'PM' = S09S00043				923	5,538	5,538
PM S09S00046						
H: Mapsheet No. 1529 -De Longpre : MH #234 to #237 , WU=3	0235/1529-0362/1529	150 DAYS	3/7/2001	174	348	348
H: Mapsheet No. 1529 -De Longpre : MH #234 to #237 , WU=3	0237/1529-0362/1529	150 DAYS	3/7/2001	170	340	340
H: Mapsheet No. 1529 -De Longpre : MH #234 to #237 , WU=3	0234/1529-0235/1529	150 DAYS	3/7/2001	332	664	664
Summary for 'PM' = S09S00046				676	1,352	1,352
PM S09S00048						
H: Mapsheet No. 1529 -Santa Monica : MH #299 to #298 (FLOOD OUT)	0298/1529-0299/1529	60 DAYS	6/8/2010	199	1,194	1,194
H: Mapsheet No. 1529 -Santa Monica : MH #299 to #298 (FLOOD OUT)	0296/1529-0298/1529	60 DAYS	6/8/2010	218	1,308	1,308
H: Mapsheet No. 1529 -Santa Monica : MH #299 to #298 (FLOOD OUT)	0295/1529-0296/1529	60 DAYS	6/8/2010	214	1,284	1,284
Summary for 'PM' = S09S00048				631	3,786	3,786
PM S09S00050						
H: Mapsheet No. 1530 -Alley S/O Nemo St. : MH #66 to #64	0064/1530-0065/1530	60 DAYS	8/27/2001	118	708	708
H: Mapsheet No. 1530 -Alley S/O Nemo St. : MH #66 to #64	0065/1530-0066/1530	60 DAYS	8/27/2001	249	1,494	1,494
Summary for 'PM' = S09S00050				367	2,202	2,202
PM S09S00051						
H: Mapsheet No. 1530 - Nemo Street: Mh 67 to 63	0066/1530-0067/1530	120 DAYS	9/16/2008	157	471	471
H: Mapsheet No. 1530 - Nemo Street: Mh 67 to 63	0063/1530-0066/1530	120 DAYS	9/16/2008	196	588	588
Summary for 'PM' = S09S00051				353	1,059	1,059

Periodics Report for City of West Hollywood

Year 2011 - Year 2012

DESCRIPTION	PIPE_LOCN	DAYS MONTHS	START YEAR	PIPE LENGTH	Y2011	Y2012
PM S09S00052						
H: Mapsheet No. 1530 -N/S Santa Monica Blvd. : MH #67 to #55	0056/1530-0058/1530	60 DAYS	8/27/2001	299	1,794	1,794
H: Mapsheet No. 1530 -N/S Santa Monica Blvd. : MH #67 to #55	0060/1530-0067/1530	60 DAYS	8/27/2001	74	444	444
H: Mapsheet No. 1530 -N/S Santa Monica Blvd. : MH #67 to #55	0058/1530-0059/1530	60 DAYS	8/27/2001	261	1,566	1,566
H: Mapsheet No. 1530 -N/S Santa Monica Blvd. : MH #67 to #55	0059/1530-0060/1530	60 DAYS	8/27/2001	92	552	552
H: Mapsheet No. 1530 -N/S Santa Monica Blvd. : MH #67 to #55	0055/1530-0056/1530	60 DAYS	8/27/2001	226	1,356	1,356
Summary for 'PM' = S09S00052				952	5,712	5,712
PM S09S00053						
H: Mapsheet No. 1530 -Alley N/O Santa Monica : MH #54 to #48	0052/1530-0053/1530	60 DAYS	3/1/2001	114	684	684
H: Mapsheet No. 1530 -Alley N/O Santa Monica : MH #54 to #48	0053/1530-0054/1530	60 DAYS	3/1/2001	305	1,830	1,830
H: Mapsheet No. 1530 -Alley N/O Santa Monica : MH #54 to #48	0051/1530-0052/1530	60 DAYS	3/1/2001	138	828	828
H: Mapsheet No. 1530 -Alley N/O Santa Monica : MH #54 to #48	0050/1530-0051/1530	60 DAYS	3/1/2001	226	1,356	1,356
H: Mapsheet No. 1530 -Alley N/O Santa Monica : MH #54 to #48	0049/1530-0372/1530	60 DAYS	3/1/2001	218	1,308	1,308
H: Mapsheet No. 1530 -Alley N/O Santa Monica : MH #54 to #48	0048/1530-0372/1530	60 DAYS	3/1/2001	64	384	384
H: Mapsheet No. 1530 -Alley N/O Santa Monica : MH #54 to #48	0049/1530-0050/1530	60 DAYS	3/1/2001	107	642	642
Summary for 'PM' = S09S00053				1,172	7,032	7,032
PM S09S00054						
H: Mapsheet No. 1530 -Robertson Blvd. : MH #200 to #203 (Flood out)	0201/1530-0202/1530	30 DAYS	9/27/2001	158	1,896	1,896
H: Mapsheet No. 1530 -Robertson Blvd. : MH #200 to #203 (Flood out)	0202/1530-0203/1530	30 DAYS	9/27/2001	74	888	888
H: Mapsheet No. 1530 -Robertson Blvd. : MH #200 to #203 (Flood out)	0200/1530-0201/1530	30 DAYS	9/27/2001	169	2,028	2,028
Summary for 'PM' = S09S00054				401	4,812	4,812
PM S09S00055						
H: Mapsheet No. 1530 -R/W S/O Beverly Blvd. : MH #114 to #92	0090/1530-0110/1530	90 DAYS	3/14/2001	149	596	596
H: Mapsheet No. 1530 -R/W S/O Beverly Blvd. : MH #114 to #92	0091/1530-0109/1530	90 DAYS	3/14/2001	112	448	448
H: Mapsheet No. 1530 -R/W S/O Beverly Blvd. : MH #114 to #92	0111/1530-0112/1530	90 DAYS	3/14/2001	81	324	324
H: Mapsheet No. 1530 -R/W S/O Beverly Blvd. : MH #114 to #92	0113/1530-0114/1530	90 DAYS	3/14/2001	47	188	188
H: Mapsheet No. 1530 -R/W S/O Beverly Blvd. : MH #114 to #92	0112/1530-0113/1530	90 DAYS	3/14/2001	94	376	376
H: Mapsheet No. 1530 -R/W S/O Beverly Blvd. : MH #114 to #92	0110/1530-0111/1530	90 DAYS	3/14/2001	243	972	972
H: Mapsheet No. 1530 -R/W S/O Beverly Blvd. : MH #114 to #92	0090/1530-0091/1530	90 DAYS	3/14/2001	48	192	192
Summary for 'PM' = S09S00055				774	3,096	3,096

Periodics Report for City of West Hollywood

Year 2011 - Year 2012

DESCRIPTION	PIPE_LOCN	DAYS MONTHS	START YEAR	PIPE LENGTH	Y2011	Y2012
PM S09S00056						
H: Mapsheet No. 1530 -Bonner Dr. : MH #145 to #142	0142/1530-0143/1530	120 DAYS	9/16/2008	210	630	630
H: Mapsheet No. 1530 -Bonner Dr. : MH #145 to #142	0143/1530-0144/1530	120 DAYS	9/16/2008	288	864	864
H: Mapsheet No. 1530 -Bonner Dr. : MH #145 to #142	0144/1530-0145/1530	120 DAYS	9/16/2008	211	633	633
Summary for 'PM' = S09S00056				709	2,127	2,127
PM S09S000652						
H: Mapsheet No. 1583-Formosa Ave From Mh 126 To Mh 125	0125/1583-0126/1583	90 DAYS	1/26/2006	222	888	888
Summary for 'PM' = S09S000652				222	888	888
PM S09S00066						
H: Mapsheet No. 1583 - Alley s/o Santa Monica Blvd : MH #168 to #167	0167/1583-0168/1583	60 DAYS	8/20/2001	329	1,974	1,974
Summary for 'PM' = S09S00066				329	1,974	1,974
PM S09S00336						
H: Mapsheet No. 1529 - Holloway Dr. : MH #148 to #194	0198/1529-0199/1529	60 DAYS	5/4/2001	219	1,314	1,314
H: Mapsheet No. 1529 - Holloway Dr. : MH #148 to #194	0199/1529-0355/1529	60 DAYS	5/4/2001	243	1,458	1,458
H: Mapsheet No. 1529 - Holloway Dr. : MH #148 to #194	0157/1529-0354/1529	60 DAYS	5/4/2001	205	1,230	1,230
H: Mapsheet No. 1529 - Holloway Dr. : MH #148 to #194	0148/1529-0149/1529	60 DAYS	5/4/2001	269	1,614	1,614
H: Mapsheet No. 1529 - Holloway Dr. : MH #148 to #194	0149/1529-0354/1529	60 DAYS	5/4/2001	220	1,320	1,320
H: Mapsheet No. 1529 - Holloway Dr. : MH #148 to #194	0197/1529-0198/1529	60 DAYS	5/4/2001	224	1,344	1,344
H: Mapsheet No. 1529 - Holloway Dr. : MH #148 to #194	0157/1529-0355/1529	60 DAYS	5/4/2001	286	1,716	1,716
Summary for 'PM' = S09S00336				1,666	9,996	9,996
PM S09S0043						
H: Mapsheet No. 1583-Hampton Ave. From MH #86 to MH #233 (Flood O	0085/1583-0086/1583	90 DAYS	5/1/2009	317	1,268	1,268
H: Mapsheet No. 1583-Hampton Ave. From MH #86 to MH #233 (Flood O	0088/1583-0233/1583	90 DAYS	5/1/2009	271	1,084	1,084
H: Mapsheet No. 1583-Hampton Ave. From MH #86 to MH #233 (Flood O	0086/1583-0088/1583	90 DAYS	5/1/2009	258	1,032	1,032
Summary for 'PM' = S09S0043				846	3,384	3,384

Periodics Report for City of West Hollywood

Year 2011 - Year 2012

DESCRIPTION	PIPE_LOCN	DAYS MONTHS	START YEAR	PIPE LENGTH	Y2011	Y2012
PM S09S00634						
H: Mapsheet No 1529-Sunset From Mh 44 to Mh 77	0046/1529-0048/1529	90 DAYS	9/22/2001	321	1,284	1,284
H: Mapsheet No 1529-Sunset From Mh 44 to Mh 77	0044/1529-0045/1529	90 DAYS	9/22/2001	173	692	692
H: Mapsheet No 1529-Sunset From Mh 44 to Mh 77	0048/1529-0054/1529	90 DAYS	9/22/2001	315	1,260	1,260
H: Mapsheet No 1529-Sunset From Mh 44 to Mh 77	0045/1529-0046/1529	90 DAYS	9/22/2001	266	1,064	1,064
H: Mapsheet No 1529-Sunset From Mh 44 to Mh 77	0054/1529-0077/1529	90 DAYS	9/22/2001	325	1,300	1,300
Summary for 'PM' = S09S00634				1,400	5,600	5,600
PM S09S00659						
H: Mapsheet No.1530-Sherbourne From MH 141 to MH 142	0141/1530-0142/1530	150 DAYS	11/29/2008	359	359	359
Summary for 'PM' = S09S00659				359	359	359
PM S09S00666						
H: Mapsheet No.1530 - San Vicente Blvd From MH 216 to MH 217	0216/1530-0217/1530	90 DAYS	3/14/2001	286	1,144	1,144
Summary for 'PM' = S09S00666				286	1,144	1,144
PM S09S00701						
H: Mapsheet No. 1530 - San Vicente : Mh #206 to #153	0153/1530-0158/1530	90 DAYS	9/27/2001	300	1,200	1,200
H: Mapsheet No. 1530 - San Vicente : Mh #206 to #153	0158/1530-0206/1530	90 DAYS	9/27/2001	291	1,164	1,164
Summary for 'PM' = S09S00701				591	2,364	2,364
PM S09S00702						
H: Mapsheet No. 1530 - Melrose Ave. : Mh 206 to 194	0203/1530-0204/1530	90 DAYS	9/26/2001	153	612	612
H: Mapsheet No. 1530 - Melrose Ave. : Mh 206 to 194	0205/1530-0206/1530	90 DAYS	9/26/2001	321	1,284	1,284
H: Mapsheet No. 1530 - Melrose Ave. : Mh 206 to 194	0194/1530-0196/1530	90 DAYS	9/26/2001	339	1,356	1,356
H: Mapsheet No. 1530 - Melrose Ave. : Mh 206 to 194	0204/1530-0205/1530	90 DAYS	9/26/2001	250	1,000	1,000
H: Mapsheet No. 1530 - Melrose Ave. : Mh 206 to 194	0196/1530-0203/1530	90 DAYS	9/26/2001	340	1,360	1,360
Summary for 'PM' = S09S00702				1,403	5,612	5,612
PM S09S00708						
H: Mapsheet No. 1529 - La Cienega : Mh 193 to 192	0192/1529-0193/1529	120 DAYS	8/22/2001	132	396	396
Summary for 'PM' = S09S00708				132	396	396

Periodics Report for City of West Hollywood

Year 2011 - Year 2012

DESCRIPTION	PIPE_LOCN	DAYS MONTHS	START YEAR	PIPE LENGTH	Y2011	Y2012
PM S09S00710						
H: Mapsheet No. 1530 - Beverly Blvd : Mh 116 to 120	0118/1530-0120/1530	120 DAYS	9/27/2001	300	900	900
H: Mapsheet No. 1530 - Beverly Blvd : Mh 116 to 120	0116/1530-0118/1530	120 DAYS	9/27/2001	290	870	870
	Summary for 'PM' = S09S00710			590	1,770	1,770
PM S09S00711						
H: Mapsheet No. 1530 - Almont Drive : Mh 194 to 59	0194/1530-0195/1530	90 DAYS	9/26/2001	199	796	796
H: Mapsheet No. 1530 - Almont Drive : Mh 194 to 59	0059/1530-0070/1530	90 DAYS	9/26/2001	122	488	488
H: Mapsheet No. 1530 - Almont Drive : Mh 194 to 59	0070/1530-0195/1530	90 DAYS	9/26/2001	324	1,296	1,296
	Summary for 'PM' = S09S00711			645	2,580	2,580
PM S09S00744						
H: Mapsheet No. 1530 - Swall Drive: Mh 118 to 119	0118/1530-0119/1530	120 DAYS	5/23/2003	206	618	618
	Summary for 'PM' = S09S00744			206	618	618
PM S09S00823						
H: Mapsheet No. 1529 - Harper Ave. : MH #276 to MH #275	0275/1529-0276/1529	90 DAYS	11/2/2007	316	1,264	1,264
	Summary for 'PM' = S09S00823			316	1,264	1,264
PM S09S00824						
H: Mapsheet No. 1583 Hayworth Ave. : MH #21 to MH #23	0021/1583-0023/1583	90 DAYS	1/16/2008	402	1,608	1,608
	Summary for 'PM' = S09S00824			402	1,608	1,608
PM S10C0720						
R: Mapsheet No. 1529 - Sunset Blvd From Mh 93 To Mh 95	0094/1529-0095/1529	90 DAYS	1/20/2006	142	568	568
R: Mapsheet No. 1529 - Sunset Blvd From Mh 93 To Mh 95	0093/1529-0094/1529	90 DAYS	1/20/2006	59	236	236
	Summary for 'PM' = S10C0720			201	804	804
PM S10C0726						
R: C- 1530 : N. Beverly Blvd. From Mh 132 To Mh 131	0131/1530-0132/1530	60 DAYS	2/8/2009	328	1,968	1,968
	Summary for 'PM' = S10C0726			328	1,968	1,968
PM S10S00109						
R: Mapsheet No. 1529 - Havenhurst : Mh #284 to #283	0283/1529-0284/1529	120 DAYS	2/1/1998	328	984	984
	Summary for 'PM' = S10S00109			328	984	984

Periodics Report for City of West Hollywood

Year 2011 - Year 2012

DESCRIPTION	PIPE_LOCN	DAYS MONTHS	START YEAR	PIPE LENGTH	Y2011	Y2012
PM S10S00110						
R: Mapsheet No. 1529 - R/W N/O Sherbourne Dr. : Mh #113 to #376	0352/1529-0376/1529	60 DAYS	2/1/1998	207	1,242	1,242
R: Mapsheet No. 1529 - R/W N/O Sherbourne Dr. : Mh #113 to #376	0113/1529-0352/1529	60 DAYS	2/1/1998	280	1,680	1,680
Summary for 'PM' = S10S00110				487	2,922	2,922
PM S10S00116						
R: Mapsheet No. 1529 - R/W N/O Harratt : Mh #348 to #39	0348/1529-0349/1529	90 DAYS	2/1/1998	263	1,052	1,052
R: Mapsheet No. 1529 - R/W N/O Harratt : Mh #348 to #39	0038/1529-0348/1529	90 DAYS	2/1/1998	264	1,056	1,056
Summary for 'PM' = S10S00116				527	2,108	2,108
PM S10S00117						
R: Mapsheet No. 1529 - E/S Kings Rd. : Mh #321 to #323	0321/1529-0322/1529	180 DAYS	2/1/1998	323	646	646
R: Mapsheet No. 1529 - E/S Kings Rd. : Mh #321 to #323	0322/1529-0323/1529	180 DAYS	2/1/1998	325	650	650
Summary for 'PM' = S10S00117				648	1,296	1,296
PM S10S00118						
R: Mapsheet No. 1529 - Phyllis Street : Mh #11 to #14 (2S)	0011/1529-0012/1529	120 DAYS	9/22/2001	173	519	519
R: Mapsheet No. 1529 - Phyllis Street : Mh #11 to #14 (2S)	0012/1529-0014/1529	120 DAYS	9/22/2001	327	981	981
Summary for 'PM' = S10S00118				500	1,500	1,500
PM S10S00119						
R: Mapsheet No. 1529 - Holloway Dr. : Mh #148 to #194	0197/1529-0198/1529	30 DAYS	5/4/2001	224	2,688	2,688
R: Mapsheet No. 1529 - Holloway Dr. : Mh #148 to #194	0148/1529-0149/1529	30 DAYS	5/4/2001	269	3,228	3,228
R: Mapsheet No. 1529 - Holloway Dr. : Mh #148 to #194	0157/1529-0354/1529	30 DAYS	5/4/2001	205	2,460	2,460
R: Mapsheet No. 1529 - Holloway Dr. : Mh #148 to #194	0157/1529-0355/1529	30 DAYS	5/4/2001	286	3,432	3,432
R: Mapsheet No. 1529 - Holloway Dr. : Mh #148 to #194	0199/1529-0355/1529	30 DAYS	5/4/2001	243	2,916	2,916
R: Mapsheet No. 1529 - Holloway Dr. : Mh #148 to #194	0149/1529-0354/1529	30 DAYS	5/4/2001	220	2,640	2,640
R: Mapsheet No. 1529 - Holloway Dr. : Mh #148 to #194	0198/1529-0199/1529	30 DAYS	5/4/2001	219	2,628	2,628
Summary for 'PM' = S10S00119				1,666	19,992	19,992
PM S10S00123						
R: Mapsheet No. 1530 - S/S Beverly Bl;vd: Mh 118 to 122	0118/1530-0120/1530	90 DAYS	2/1/1998	300	1,200	1,200
R: Mapsheet No. 1530 - S/S Beverly Bl;vd: Mh 118 to 122	0120/1530-0122/1530	90 DAYS	2/1/1998	282	1,128	1,128
Summary for 'PM' = S10S00123				582	2,328	2,328

Periodics Report for City of West Hollywood

Year 2011 - Year 2012

DESCRIPTION	PIPE_LOCN	DAYS MONTHS	START YEAR	PIPE LENGTH	Y2011	Y2012
PM S10S00511						
R: Mapsheet No. 1529 - Horn Avenue: Mh 86 to N/B 5 Mh's	0083/1529-CITY/1529	60 DAYS	5/13/1998	155	930	930
R: Mapsheet No. 1529 - Horn Avenue: Mh 86 to N/B 5 Mh's	0084/1529-0085/1529	60 DAYS	5/13/1998	121	726	726
R: Mapsheet No. 1529 - Horn Avenue: Mh 86 to N/B 5 Mh's	0083/1529-0084/1529	60 DAYS	5/13/1998	101	606	606
R: Mapsheet No. 1529 - Horn Avenue: Mh 86 to N/B 5 Mh's	0085/1529-0086/1529	60 DAYS	5/13/1998	80	480	480
Summary for 'PM' = S10S00511				457	2,742	2,742
PM S10S00537						
R: Mapsheet No.1530-Ashcroft From MH 180 to MH 176	0177/1530-0178/1530	90 DAYS	1/20/1999	340	1,360	1,360
R: Mapsheet No.1530-Ashcroft From MH 180 to MH 176	0178/1530-0179/1530	90 DAYS	1/20/1999	350	1,400	1,400
R: Mapsheet No.1530-Ashcroft From MH 180 to MH 176	0176/1530-0177/1530	90 DAYS	1/20/1999	188	752	752
R: Mapsheet No.1530-Ashcroft From MH 180 to MH 176	0179/1530-0180/1530	90 DAYS	1/20/1999	318	1,272	1,272
Summary for 'PM' = S10S00537				1,196	4,784	4,784
PM S10S00600						
R:Mapsheets No. 1583 Genesee Ave. Mh175 to 3rd Mh south	0176/1583-0177/1583	90 DAYS	3/5/2007	336	1,344	1,344
R:Mapsheets No. 1583 Genesee Ave. Mh175 to 3rd Mh south	0177/1583-CITY/1583	90 DAYS	3/5/2007	381	1,524	1,524
R:Mapsheets No. 1583 Genesee Ave. Mh175 to 3rd Mh south	0175/1583-0176/1583	90 DAYS	3/5/2007	319	1,276	1,276
Summary for 'PM' = S10S00600				1,036	4,144	4,144
PM S10S00681						
R: Mapsheet No. 1529 Sunset Blvd.: Mh 216 to 215	0215/1529-0216/1529	30 DAYS	1/15/2002	239	2,868	2,868
Summary for 'PM' = S10S00681				239	2,868	2,868
PM S10S00699						
R: Mapsheet No. 1530 - Norma Place: Mh 19 to 24	0022/1530-0023/1530	90 DAYS	9/16/2008	350	1,400	1,400
R: Mapsheet No. 1530 - Norma Place: Mh 19 to 24	0020/1530-0021/1530	90 DAYS	9/16/2008	180	720	720
R: Mapsheet No. 1530 - Norma Place: Mh 19 to 24	0023/1530-0024/1530	90 DAYS	9/16/2008	253	1,012	1,012
R: Mapsheet No. 1530 - Norma Place: Mh 19 to 24	0021/1530-0022/1530	90 DAYS	9/16/2008	259	1,036	1,036
R: Mapsheet No. 1530 - Norma Place: Mh 19 to 24	0019/1530-0020/1530	90 DAYS	9/16/2008	101	404	404
Summary for 'PM' = S10S00699				1,143	4,572	4,572

Periodics Report for City of West Hollywood

Year 2011 - Year 2012

DESCRIPTION	PIPE_LOCN	DAYS MONTHS	START YEAR	PIPE LENGTH	Y2011	Y2012
PM S10S00701						
R: Mapsheet No. 1530 - Kings Road: Mh 357 to 353	0354/1530-0355/1530	90 DAYS	4/17/2003	320	1,280	1,280
R: Mapsheet No. 1530 - Kings Road: Mh 357 to 353	0356/1530-0357/1530	90 DAYS	4/17/2003	43	172	172
R: Mapsheet No. 1530 - Kings Road: Mh 357 to 353	0355/1530-0356/1530	90 DAYS	4/17/2003	313	1,252	1,252
R: Mapsheet No. 1530 - Kings Road: Mh 357 to 353	0353/1530-0354/1530	90 DAYS	4/17/2003	329	1,316	1,316
Summary for 'PM' = S10S00701				1,005	4,020	4,020
PM S10S00723						
R: Mapsheet No. 1529 - Sunset Blvd: Mh 91 to 110	0091/1529-0110/1529	90 DAYS	12/15/2003	111	444	444
Summary for 'PM' = S10S00723				111	444	444
PM S10S00739						
R: Mapsheet No. 1583 - Crescent Heights Blvd: Mh 30 to 33	0032/1583-0033/1583	90 DAYS	7/22/2009	330	1,320	1,320
R: Mapsheet No. 1583 - Crescent Heights Blvd: Mh 30 to 33	0030/1583-0032/1583	90 DAYS	7/22/2009	336	1,344	1,344
Summary for 'PM' = S10S00739				666	2,664	2,664
PM S10S00997						
R: Mapsheet No. 1583 - Spaulding Ave Mh 180 to Mh 1st Mh South	0180/1583-CITY/1583	90 DAYS	12/26/2007	278	1,112	1,112
Summary for 'PM' = S10S00997				278	1,112	1,112
PM S10S01001						
R: Mapsheet No. 1583 - Fuller Ave Mh 136 to Mh 135 - FLOOD OUT	0135/1583-0136/1583	90 DAYS	7/2/2009	274	1,096	1,096
Summary for 'PM' = S10S01001				274	1,096	1,096

Total Pipe Length:	31,438 ft / 5.95 mile	
Grand Total (ft):	160,531	160,531
Grand Total (Mile	30.40	30.40
Sewers (Count):	139	139

APPENDIX D

Herbicide Treatment for Sewer Root Control Preventive Maintenance History



1020 Hiawatha Blvd., West
Syracuse, NY 13204-1131
1-800-44-ROOTS
(315) 472-4781
FAX (315) 475-4203

LOG REPORT ON COMPLETED WORK
DUKE'S SEWER-LINE CHEMICAL ROOT CONTROL SERVICE

ATTENTION: Sharon Perlstein, P.E
CLIENT: West Hollywood, City
WORK PERFORMED: February 15, 2011 - February 23, 2011
OPERATORS: G. Roberts, N. Amo
REPORT DATE: February 24, 2011
INSPECTOR: None
PURCHASE ORDER: N/A

11-0098-60.60

GUARANTEE

We guarantee to kill all the roots in every sewer we treat and to eliminate the main line stoppages caused by live tree roots.

If live roots are found in a sewer within six months after the application, or if a treated sewer plugs up and floods due to tree roots during the guarantee period (see below), we will **re-treat that section, at our own expense, or remit to the customer 100% of the payment we received to treat that section of sewer.**

The decision of the customer as to the cause of the plug-up is binding.

This guarantee applies only to sewer stoppages caused by live tree roots. It does not apply to stoppages caused by grease or other foreign matter; flat, collapsed or deformed pipe; or flooding caused by a surcharged or plugged sewer section downstream from a guaranteed sewer section. **This guarantee applies to main line sewers only.**

Guarantee Period

Any section of sanitary sewer we treat will not plug up and flood due to tree root obstructions for a period of **two years**. The guarantee period begins on the date of treatment, and ends two years after the date of treatment

Extended Guarantee With Repeat Treatments

Whenever we perform a repeat application to a section of sewer within six months of the expiration of the previous guarantee, the guarantee is extended for an **additional three years**.

Re-treatments, performed at no charge in honor of the guarantee, do not extend the expiration date of the guarantee.

Liability

Duke's is an insured, fully licensed pesticide application company, and is certified to apply EPA registered herbicides to sanitary sewers in compliance with Federal and State regulations.

Duke's accepts responsibility for any damage to above-ground vegetation. Duke's is not responsible for damages caused by sewer stoppages.



1020 Hiawatha Blvd., West • Syracuse, NY 13204-1131
(315) 472-4781 • 800-447-6687 • Fax (315) 475-4203

Treated Dates: 02/15/11 - 02/23/11

Report Date: 02/24/11

Treated	Street	Up			Down			Size	Feet	Guar End
		Type	Loc	MH	Type	Loc	MH			
02/15/11	ALTA LOMA ROAD	M	S	09-0203	M	S	09-0202	8	296	02/15/14
02/15/11	ALTA LOMA ROAD	M	S	09-0204	M	S	09-0203	8	296	02/15/14
02/15/11	ALTA LOMA ROAD	M	S	09-0205	M	S	09-0204	8	247	02/15/14
02/20/11	BEVERLY BLVD	M	U	13-0128	M	S	13-0129	10	300	02/20/13
02/20/11	BEVERLY BLVD	M	S	13-0129	M	S	13-0130	10	302	02/20/13
02/20/11	BEVERLY BLVD	M	S	13-0130	M	S	13-0131	10	314	02/20/14
02/20/11	BEVERLY BLVD	M	S	13-0131	M	S	13-0132	10	314	02/20/14
02/20/11	BEVERLY BLVD	M	S	13-0132	M	S	13-0133	10	314	02/20/14
02/19/11	BEVERLY BLVD	M	S	13-0133	M	S	13-0134	10	270	02/19/14
02/19/11	BEVERLY BLVD	M	S	14-0116	M	S	14-0115	8	314	02/19/13
02/19/11	BEVERLY BLVD	M	S	14-0118	M	S	14-0116	8	300	02/19/13
02/19/11	BEVERLY BLVD	M	S	14-0120	M	S	14-0118	8	291	02/19/13
02/19/11	BEVERLY BLVD	M	S	14-0122	M	S	14-0120	8	285	02/19/13
02/19/11	BEVERLY BLVD	M	S	14-0124	M	S	14-0122	8	303	02/19/13
02/19/11	BEVERLY BLVD	M	S	14-0126	M	S	14-0124	8	289	02/19/13
02/19/11	N CRESCENT HEIGHT	M	S	07-0285	M	S	07-0286	8	324	02/19/13
02/19/11	N CRESCENT HEIGHT	M	S	07-0286	M	S	07-0287	8	326	02/19/13
02/19/11	N CRESCENT HEIGHT	M	S	07-0287	M	S	07-0288	8	326	02/19/13
02/19/11	N CRESCENT HEIGHT	M	S	07-0288	M	S	07-0289	8	315	02/19/13
02/19/11	N CRESCENT HEIGHT	M	S	07-0289	M	S	07-0290	8	312	02/19/13
02/19/11	N CRESCENT HEIGHT	M	S	07-0290	M	S	07-0291	8	312	02/19/13
02/22/11	CRESCENT HEIGHT	M	S	08-0197	M	S	08-0404	8	192	02/22/13
02/22/11	CRESCENT HEIGHT	M	S	08-0229	M	S	08-0197	8	303	02/22/13
02/22/11	CURSON AVENUE	M	S	05-0185	M	S	05-0184	8	346	02/22/13
02/22/11	CURSON AVENUE	M	S	05-0186	M	S	05-0185	8	351	02/22/14
02/16/11	DE LONGPRE AVEN	M	S	09-0234	M	S	09-0235	8	322	02/16/14
02/16/11	DE LONGPRE AVEN	M	S	09-0235	M	S	09-0362	8	178	02/16/14
02/16/11	DE LONGPRE AVEN	M	S	09-0362	M	S	09-0237	8	170	02/16/14
02/17/11	DELONGPRE AVENU	M	S	07-0263	M	S	07-0262	8	309	02/17/14
02/17/11	DELONGPRE AVENU	M	S	07-0265	M	S	07-0264	8	145	02/17/14
02/17/11	DELONGPRE AVENU	M	S	07-0266	M	S	07-0265	8	141	02/17/14
02/23/11	DETROIT STREET	M	S	02-0117	M	S	02-0118	8	302	02/23/14
02/23/11	DETROIT STREET	M	S	02-0119	M	S	02-0114	8	319	02/23/13
02/21/11	EDINBURGH AVENU	M	S	08-0200	M	S	08-0201	8	260	02/21/14
02/21/11	EDINBURGH AVENU	M	S	08-0201	M	S	08-0402	8	192	02/21/14
02/16/11	FLORES STREET	M	S	09-0244	M	S	09-0329	8	291	02/16/14
02/16/11	FLORES STREET	M	S	09-0245	M	S	09-0244	8	290	02/16/14
02/16/11	FLORES STREET	M	S	09-0246	M	S	09-0245	8	290	02/16/14
02/16/11	FLORES STREET	M	S	09-0247	M	S	09-0246	8	388	02/16/14
02/17/11	FLORES STREET	M	S	09-0248	M	S	09-0249	8	246	02/17/14
02/17/11	FLORES STREET	M	S	09-0249	M	S	09-0250	8	276	02/17/14
02/17/11	FLORES STREET	M	S	09-0250	M	S	09-0251	8	319	02/17/14
02/17/11	FLORES STREET	M	S	09-0251	M	S	09-0252	8	289	02/17/13
02/16/11	FLORES STREET	M	S	09-0329	M	S	09-0243	8	291	02/16/13
02/23/11	FORMOSA AVENUE	M	S	02-0113	M	S	02-0125	8	205	02/23/13
02/23/11	FORMOSA AVENUE	M	S	02-0120	M	S	02-0113	8	311	02/23/13
02/23/11	FORMOSA AVENUE	M	S	02-0121	M	S	02-0120	8	325	02/23/14
02/23/11	FORMOSA AVENUE	M	S	02-0122	M	S	02-0121	8	305	02/23/14
02/23/11	FORMOSA AVENUE	M	S	02-0125	M	S	02-0126	8	231	02/23/14
02/22/11	GENESEE AVENUE	M	S	06-0055	M	S	06-0054	8	310	02/22/14
02/22/11	GENESEE AVENUE	M	S	06-0056	M	S	06-0055	8	316	02/22/14
02/22/11	GENESEE AVENUE	M	S	06-0058	M	S	06-0057	8	231	02/22/13
02/23/11	GREEN ACRE AVEN	M	S	03-0130	M	S	03-0131	8	345	02/23/14
02/23/11	GREEN ACRE AVEN	M	S	03-0131	M	S	03-0132	8	335	02/23/14
02/23/11	GREEN ACRE AVEN	M	S	03-0132	M	S	03-0100	8	300	02/23/14
02/15/11	HACIENDA PLACE	M	S	09-0224	M	S	09-0223	8	266	02/15/13
02/15/11	HACIENDA PLACE	M	S	09-0225	M	S	09-0224	8	266	02/15/14
02/15/11	HACIENDA PLACE	M	S	09-0361	M	S	09-0225	8	266	02/15/14

Treated Dates: 02/15/11 - 02/23/11

Report Date: 02/24/11

Treated	Street	Up Up Up			Down Down Down			Size	Feet	Guar End
		Type	Loc	MH	Type	Loc	MH			
02/23/11	HAMPTON AVENUE	M	S	02-0107	M	S	02-0108	8	123	02/23/14
02/17/11	HARPER AVENUE	M	E	07-0267	M	E	07-0268	8	81	02/17/13
02/17/11	HARPER AVENUE	M	S	07-0268	M	S	07-0269	8	214	02/17/13
02/17/11	HARPER AVENUE	M	S	07-0269	M	S	07-0270	8	268	02/17/14
02/17/11	HARPER AVENUE	M	S	07-0270	M	S	07-0271	8	333	02/17/14
02/17/11	HARPER AVENUE	M	S	07-0271	M	S	07-0272	8	381	02/17/14
02/17/11	HARPER AVENUE	M	S	07-0272	M	S	07-0274	8	314	02/17/13
02/17/11	HARPER AVENUE	M	S	07-0274	M	S	07-0275	8	312	02/17/14
02/17/11	HARPER AVENUE	M	S	07-0275	M	S	07-0276	8	312	02/17/13
02/18/11	N HARPER AVENUE	M	S	08-0303	M	S	08-0406	8	285	02/18/14
02/18/11	N HARPER AVENUE	M	S	08-0304	M	S	08-0303	8	285	02/18/14
02/18/11	N HARPER AVENUE	M	S	08-0305	M	S	08-0304	8	260	02/18/14
02/18/11	N HARPER AVENUE	M	S	08-0306	M	S	08-0305	8	260	02/18/14
02/21/11	HAVENHURST DRIV	M	S	07-0279	M	S	07-0278	8	323	02/21/14
02/21/11	HAVENHURST DRIV	M	S	07-0280	M	S	07-0279	8	312	02/21/14
02/21/11	HAVENHURST DRIV	M	S	07-0281	M	S	07-0280	8	315	02/21/14
02/21/11	HAVENHURST DRIV	M	S	07-0282	M	S	07-0281	8	326	02/21/14
02/21/11	HAVENHURST DRIV	M	S	07-0283	M	S	07-0282	8	326	02/21/14
02/21/11	HAVENHURST DRIV	M	S	07-0284	M	S	07-0283	8	324	02/21/14
02/18/11	HAVENHURST DRIV	M	S	08-0313	M	S	08-0347	8	260	02/18/14
02/18/11	HAVENHURST DRIV	M	S	08-0314	M	S	08-0313	8	260	02/18/14
02/18/11	HAYWORTH AVENUE	M	S	08-0231	M	S	08-0205	8	295	02/18/14
02/16/11	KINGS ROAD	M	S	08-0319	M	S	08-0320	8	288	02/16/14
02/16/11	KINGS ROAD	M	S	08-0320	M	S	08-0321	8	254	02/16/14
02/16/11	KINGS ROAD	M	S	08-0321	M	S	08-0322	8	328	02/16/14
02/16/11	KINGS ROAD	M	S	08-0322	M	S	08-0323	8	315	02/16/14
02/16/11	KINGS ROAD	M	S	08-0323	M	S	08-0365	8	287	02/16/14
02/16/11	KINGS ROAD	M	S	08-0324	M	S	08-0364	8	302	02/16/14
02/16/11	KINGS ROAD	M	S	08-0325	M	S	08-0324	8	321	02/16/14
02/16/11	KINGS ROAD	M	S	08-0326	M	S	08-0325	8	323	02/16/14
02/16/11	KINGS ROAD	M	S	08-0327	M	S	08-0326	8	260	02/16/14
02/16/11	KINGS ROAD	M	S	08-0328	M	S	08-0327	8	268	02/16/14
02/16/11	KINGS ROAD	M	S	08-0364	M	S	08-0363	8	228	02/16/14
02/16/11	KINGS ROAD	M	S	08-0365	M	S	08-0366	8	248	02/16/14
02/16/11	KINGS ROAD	M	S	09-0239	M	S	09-0240	8	327	02/16/14
02/16/11	KINGS ROAD	M	S	09-0240	M	S	09-0241	8	316	02/16/14
02/16/11	KINGS ROAD	M	S	09-0241	M	S	09-0242	8	316	02/16/13
02/15/11	LA CIENEGA BLVD	M	U	09-0215	M	B	09-0216	8	235	02/15/13
02/15/11	LA CIENEGA BLVD	M	B	09-0216	M	U	09-0217	8	157	02/15/13
02/15/11	LA CIENEGA BLVD	M	U	09-0217	M	A	09-0360	8	35	02/15/13
02/15/11	LA CIENEGA BLVD	M	A	09-0360	M	U	09-0218	8	199	02/15/13
02/18/11	LA JOLLA AVENUE	M	S	08-0309	M	S	08-0310	8	260	02/18/14
02/18/11	LA JOLLA AVENUE	M	S	08-0310	M	S	08-0311	8	260	02/18/14
02/18/11	LA JOLLA AVENUE	M	S	08-0311	M	S	08-0312	8	292	02/18/14
02/18/11	LA JOLLA AVENUE	M	S	08-0312	M	S	08-0405	8	282	02/18/14
02/21/11	LAUREL AVENUE	M	S	07-0001	M	S	07-0002	8	324	02/21/14
02/21/11	LAUREL AVENUE	M	S	07-0002	M	S	07-0003	8	326	02/21/14
02/21/11	LAUREL AVENUE	M	S	07-0003	M	S	07-0004	8	326	02/21/14
02/21/11	LAUREL AVENUE	M	S	07-0004	M	S	07-0005	8	315	02/21/14
02/21/11	LAUREL AVENUE	M	S	07-0005	M	S	07-0006	8	312	02/21/14
02/21/11	LAUREL AVENUE	M	S	07-0006	M	S	07-0007	8	318	02/21/14
02/21/11	LAUREL AVENUE	M	S	07-0700	M	S	07-0009	8	150	02/21/14
02/21/11	LAUREL AVENUE	M	S	08-0230	M	S	08-0233	8	300	02/21/14
02/21/11	LAUREL AVENUE	M	S	08-0233	M	S	08-0403	8	192	02/21/14
02/22/11	NORTON AVENUE	M	A	04-0069	M	A	04-0070	8	245	02/22/13
02/22/11	NORTON AVENUE	M	S	04-0070	M	A	04-0071	8	318	02/22/13
02/22/11	NORTON AVENUE	M	S	06-0066	M	S	06-0055	8	350	02/22/14
02/21/11	NORTON AVENUE	M	E	07-0015	M	E	07-0016	8	300	02/21/14

Treated Dates: 02/15/11 - 02/23/11

Report Date: 02/24/11

Treated	Street	Up			Down			Size	Feet	Guar End
		Type	Loc	MH	Type	Loc	MH			
02/21/11	NORTON AVENUE	M	S	07-0016	M	S	07-0017	8	220	02/21/14
02/20/11	NORTON AVENUE	M	S	07-0017	M	S	07-0018	15	122	02/20/13
02/21/11	NORTON AVENUE	M	S	07-0017	M	E	07-0007	8	215	02/21/14
02/20/11	NORTON AVENUE	M	S	07-0018	M	S	07-0291	15	324	02/20/14
02/20/11	NORTON AVENUE	M	S	07-0276	M	S	07-0297	15	380	02/20/14
02/20/11	NORTON AVENUE	M	S	07-0277	M	S	07-0276	15	230	02/20/14
02/20/11	NORTON AVENUE	M	S	07-0278	M	S	07-0277	15	211	02/20/14
02/20/11	NORTON AVENUE	M	S	07-0291	M	S	07-0292	15	239	02/20/14
02/20/11	NORTON AVENUE	M	S	07-0292	M	S	07-0278	15	213	02/20/14
02/16/11	OGDEN DRIVE	M	S	06-0059	M	S	06-0060	8	319	02/16/14
02/15/11	OLIVE DRIVE	M	S	09-0229	M	S	09-0228	8	306	02/15/13
02/15/11	OLIVE DRIVE	M	S	09-0230	M	S	09-0229	8	306	02/15/14
02/15/11	OLIVE DRIVE	M	S	09-0232	M	S	09-0231	8	299	02/15/14
02/15/11	OLIVE DRIVE	M	S	09-0233	M	S	09-0232	8	242	02/15/14
02/15/11	OLIVE DRIVE	M	S	09-0701	M	S	09-0230	8	308	02/15/14
02/15/11	ORANGE GROVE AV	M	S	05-0169	M	S	05-0170	8	342	02/15/14
02/21/11	ORANGE GROVE AV	M	S	06-0046	M	S	06-0047	8	295	02/21/14
02/21/11	ORANGE GROVE AV	M	S	06-0047	M	S	06-0048	8	295	02/21/14
02/18/11	POINSETTA PLACE	M	S	03-0129	M	U	03-0128	12	334	02/18/14
02/23/11	POINSETTIA DRIV	M	S	03-0104	M	S	03-0102	8	320	02/23/14
02/23/11	POINSETTIA PLAC	M	S	02-0108	M	S	02-0109	8	237	02/23/14
02/23/11	POINSETTIA PLAC	M	S	02-0109	M	S	02-0110	8	245	02/23/14
02/23/11	POINSETTIA PLAC	M	S	02-0110	M	S	02-0111	8	251	02/23/14
02/23/11	POINSETTIA PLAC	M	S	02-0111	M	S	02-0112	8	277	02/23/13
02/15/11	SANTA MONICA BL	M	S	07-0332	M	A	07-0334	15	352	02/15/13
02/15/11	SANTA MONICA BL	M	S	07-0333	M	S	07-0335	8	322	02/15/13
02/15/11	SANTA MONICA BL	M	A	07-0334	M	A	07-0336	15	243	02/15/13
02/15/11	SANTA MONICA BL	M	S	07-0335	M	A	07-0337	8	295	02/15/13
02/18/11	SANTA MONICA BL	M	A	07-0336	M	A	07-0338	15	350	02/18/13
02/15/11	SANTA MONICA BL	M	A	07-0337	M	A	07-0339	8	320	02/15/13
02/18/11	SANTA MONICA BL	M	A	07-0338	M	A	07-0383	15	115	02/18/13
02/15/11	SANTA MONICA BL	M	S	07-0339	M	S	07-0343	8	124	02/15/13
02/22/11	SIERRA BONITA A	M	S	05-0189	M	S	05-0190	8	281	02/22/14
02/22/11	STANLEY AVENUE	M	S	05-0163	M	S	05-0181	8	285	02/22/14
02/20/11	SWEETZER AVENUE	M	S	07-0255	M	S	07-0299	15	315	02/20/13
02/18/11	SWEETZER AVENUE	M	S	07-0257	M	S	07-0255	12	330	02/18/14
02/18/11	SWEETZER AVENUE	M	S	07-0258	M	S	07-0257	12	336	02/18/14
02/17/11	SWEETZER AVENUE	M	S	07-0259	M	S	07-0258	12	302	02/17/14
02/17/11	SWEETZER AVENUE	M	S	07-0262	M	S	07-0261	12	350	02/17/14
02/18/11	SWEETZER AVENUE	M	S	07-0264	M	S	07-0262	12	115	02/18/14
02/17/11	SWEETZER AVENUE	M	S	08-0300	M	S	08-0301	8	285	02/17/14
02/17/11	SWEETZER AVENUE	M	S	08-0301	M	S	08-0302	8	285	02/17/14
02/17/11	SWEETZER AVENUE	M	S	08-0302	M	S	08-0407	8	290	02/17/14
02/17/11	SWEETZER AVENUE	M	S	08-0367	M	S	08-0300	8	285	02/17/14
02/19/11	SWEETZER AVENUE	M	S	09-0254	M	S	09-0253	8	300	02/19/13
02/22/11	VISTA STREET	M	S	03-0091	M	S	03-0092	8	180	02/22/14
02/22/11	VISTA STREET	M	S	03-0094	M	S	03-0095	8	286	02/22/14
02/22/11	VISTA STREET	M	S	03-0095	M	S	03-0096	8	288	02/22/13
02/17/11	VISTA STREET	M	S	05-0154	M	S	05-0153	8	200	02/17/13
02/17/11	VISTA STREET	M	S	05-0155	M	S	05-0154	8	198	02/17/13

Manhole Type Codes:

C Clean Out
H House Number
L Line Number
M Manhole Number

Manhole Location Codes:

A Alley
B Backyard
E Easement (woods or no building)
F Front Yard
L Left Side Yard(when facing front)
R Right Side Yard(when facing front)
S Street
U Unknown

Break Down:

10	1,814
12	1,767
15	3,094
8	39,505
Total:	46,180



1020 Hiawatha Blvd., West
Syracuse, NY 13204-1131
1-800-44-ROOTS
(315) 472-4781
FAX (315) 475-4203

LOG REPORT ON COMPLETED WORK
DUKE'S SEWER-LINE CHEMICAL ROOT CONTROL SERVICE

ATTENTION: Sharon Perlstein, P.E
CLIENT: West Hollywood, City
WORK PERFORMED: January 18, 2012 - January 26, 2012
OPERATORS: C. Burdick, M. Lawler
REPORT DATE: January 27, 2012
INSPECTOR: Sharon Perlstein
PURCHASE ORDER: N/A

12-0053-32.50

GUARANTEE

We guarantee to kill all the roots in every sewer we treat and to eliminate the main line stoppages caused by live tree roots.

If live roots are found in a sewer within six months after the application, or if a treated sewer plugs up and floods due to tree roots during the guarantee period (see below), we will **re-treat that section, at our own expense, or remit to the customer 100% of the payment we received to treat that section of sewer.**

The decision of the customer as to the cause of the plug-up is binding.

This guarantee applies only to sewer stoppages caused by live tree roots. It does not apply to stoppages caused by grease or other foreign matter; flat, collapsed or deformed pipe; or flooding caused by a surcharged or plugged sewer section downstream from a guaranteed sewer section. **This guarantee applies to main line sewers only.**

Guarantee Period

Any section of sanitary sewer we treat will not plug up and flood due to tree root obstructions for a period of **two years**. The guarantee period begins on the date of treatment, and ends two years after the date of treatment

Extended Guarantee With Repeat Treatments

Whenever we perform a repeat application to a section of sewer within six months of the expiration of the previous guarantee, the guarantee is extended for an **additional three years**.

Re-treatments, performed at no charge in honor of the guarantee, do not extend the expiration date of the guarantee.

Liability

Duke's is an insured, fully licensed pesticide application company, and is certified to apply EPA registered herbicides to sanitary sewers in compliance with Federal and State regulations.

Duke's accepts responsibility for any damage to above-ground vegetation. Duke's is not responsible for damages caused by sewer stoppages.



The Full-Service Root Control Experts

1020 Hiawatha Blvd., West • Syracuse, NY 13204-1131
(315) 472-4781 • 800-447-6687 • Fax (315) 475-4203

Treated Dates: 01/18/12 - 01/26/12

Report Date: 01/27/12

Treated	Street	Up Up Up			Down Down Down			Size	Feet	Guar End
		Type	Loc	MH	Type	Loc	MH			
01/26/12	ALTA LOMA ROAD	M	S	09-0203	M	S	09-0202	8	296	01/26/15
01/26/12	ALTA LOMA ROAD	M	S	09-0204	M	S	09-0203	8	296	01/26/15
01/26/12	ALTA LOMA ROAD	M	S	09-0205	M	S	09-0204	8	240	01/26/15
01/25/12	ASHCROFT AVENUE	M	S	13-0151	M	S	13-0150	8	333	01/25/15
01/25/12	ASHCROFT AVENUE	M	S	13-0152	M	S	13-0151	8	346	01/25/15
01/20/12	ASHCROFT AVENUE	M	S	13-0177	M	S	13-0176	8	144	01/20/14
01/20/12	ASHCROFT AVENUE	M	S	13-0177	M	S	13-0190	8	250	01/20/14
01/20/12	ASHCROFT AVENUE	M	S	13-0178	M	S	13-0177	8	350	01/20/14
01/20/12	ASHCROFT AVENUE	M	S	13-0179	M	S	13-0178	8	350	01/20/15
01/20/12	ASHCROFT AVENUE	M	S	13-0180	M	S	13-0179	8	350	01/20/14
01/20/12	ASHCROFT AVENUE	M	S	13-0181	M	S	13-0180	8	350	01/20/15
01/25/12	BONNER DRIVE	M	S	13-0143	M	S	13-042	8	235	01/25/15
01/25/12	BONNER DRIVE	M	S	13-0144	M	S	13-0143	8	248	01/25/15
01/25/12	BONNER DRIVE	M	S	13-0145	M	S	13-0144	8	248	01/25/15
01/20/12	CURSON AVENUE	M	S	04-0087	M	S	04-0086	8	145	01/20/14
01/19/12	CURSON AVENUE	M	S	05-0184	M	S	05-0403	8	348	01/19/14
01/19/12	CURSON AVENUE	M	S	05-0185	M	S	05-0184	8	346	01/19/15
01/19/12	CURSON AVENUE	M	S	05-0186	M	S	05-0185	8	344	01/19/15
01/20/12	DETROIT STREET	M	S	02-0116	M	S	02-0117	8	235	01/20/14
01/20/12	DETROIT STREET	M	S	02-0117	M	S	02-0118	8	296	01/20/15
01/20/12	DETROIT STREET	M	S	02-0118	M	S	02-0119	8	314	01/20/14
01/20/12	DETROIT STREET	M	S	02-0119	M	S	02-0114	8	314	01/20/15
01/25/12	DORRINGTON AVEN	M	S	13-0154	M	S	13-0153	8	55	01/25/14
01/25/12	DORRINGTON AVEN	M	S	13-0155	M	S	13-0154	8	326	01/25/14
01/25/12	DORRINGTON AVEN	M	S	13-0156	M	S	13-0155	8	298	01/25/15
01/24/12	DORRINGTON AVEN	M	S	13-0170	M	S	13-0171	8	317	01/24/15
01/24/12	DORRINGTON AVEN	M	S	13-0171	M	S	13-0172	8	346	01/24/15
01/24/12	DORRINGTON AVEN	M	S	13-0172	M	S	13-0173	8	316	01/24/15
01/24/12	DORRINGTON AVEN	M	S	13-0173	M	S	13-0174	8	316	01/24/15
01/20/12	FORMOSA AVENUE	M	S	02-0113	M	S	02-0125	8	205	01/20/15
01/20/12	FORMOSA AVENUE	M	S	02-0120	M	S	02-0113	8	311	01/20/15
01/20/12	FORMOSA AVENUE	M	S	02-0121	M	S	02-0120	8	316	01/20/15
01/20/12	FORMOSA AVENUE	M	S	02-0122	M	S	02-0121	8	297	01/20/15
01/20/12	FORMOSA AVENUE	M	S	02-0123	M	S	02-0122	8	234	01/20/14
01/20/12	FORMOSA AVENUE	M	S	02-0125	M	S	02-0126	8	231	01/20/15
01/20/12	FORMOSA AVENUE	M	S	02-0126	M	S	02-0127	8	231	01/20/14
01/18/12	FULLER AVENUE	M	S	03-0133	M	S	03-0134	8	289	01/18/14
01/18/12	FULLER AVENUE	M	S	03-0134	M	S	03-0135	8	288	01/18/14
01/18/12	FULLER AVENUE	M	S	03-0135	M	S	03-0136	8	288	01/18/14
01/18/12	FULLER AVENUE	M	S	03-0136	M	S	03-0099	8	288	01/18/14
01/18/12	FULLER AVENUE	M	S	03-0137	M	S	03-0138	8	218	01/18/14
01/18/12	FULLER AVENUE	M	S	03-0138	M	S	03-0139	8	256	01/18/14
01/19/12	GENESEE AVENUE	M	S	05-0175	M	S	05-0176	8	344	01/19/14
01/19/12	GENESEE AVENUE	M	S	05-0176	M	S	05-0177	8	346	01/19/14
01/19/12	GENESEE AVENUE	M	S	05-0177	M	S	05-0406	8	348	01/19/14
01/18/12	GENESEE AVENUE	M	S	06-0055	M	S	06-0054	8	310	01/18/15
01/18/12	GENESEE AVENUE	M	S	06-0056	M	S	06-0055	8	316	01/18/15
01/18/12	GENESEE AVENUE	M	S	06-0057	M	S	06-0056	8	320	01/18/14
01/18/12	GENESEE AVENUE	M	S	06-0058	M	S	06-0057	8	231	01/18/15
01/20/12	GREEN ACRE AVEN	M	S	03-0130	M	S	03-0131	8	345	01/20/15
01/20/12	GREEN ACRE AVEN	M	S	03-0131	M	S	03-0132	8	335	01/20/15
01/20/12	GREEN ACRE AVEN	M	S	03-0132	M	S	03-0100	8	300	01/20/15
01/19/12	HAYWORTH AVENUE	M	S	07-0019	M	S	07-0016	8	312	01/19/15
01/19/12	HAYWORTH AVENUE	M	S	07-0020	M	S	07-0019	8	312	01/19/15
01/19/12	HAYWORTH AVENUE	M	S	07-0021	M	S	07-0020	8	315	01/19/15
01/19/12	HAYWORTH AVENUE	M	S	07-0023	M	S	07-0021	8	326	01/19/15
01/19/12	HAYWORTH AVENUE	M	S	07-0024	M	S	07-0023	8	326	01/19/15
01/19/12	HAYWORTH AVENUE	M	S	07-0025	M	S	07-0024	8	324	01/19/15

Treated Dates: 01/18/12 - 01/26/12

Report Date: 01/27/12

Treated	Street	Up Up Up			Down Down Down			Size	Feet	Guar End
		Type	Loc	MH	Type	Loc	MH			
01/18/12	HAYWORTH AVENUE	M	S	08-0203	M	S	08-0204	8	298	01/18/15
01/18/12	HAYWORTH AVENUE	M	S	08-0204	M	S	08-0231	8	260	01/18/15
01/18/12	HAYWORTH AVENUE	M	S	08-0205	M	S	08-0401	8	278	01/18/15
01/18/12	HAYWORTH AVENUE	M	S	08-0231	M	S	08-0205	8	295	01/18/15
01/25/12	LA PEER DRIVE	M	S	13-0197	M	S	13-0196	8	260	01/25/14
01/25/12	LA PEER DRIVE	M	S	13-0198	M	S	13-0197	8	276	01/25/15
01/20/12	MARTEL AVENUE	M	S	05-0151	M	S	05-0401	8	145	01/20/14
01/20/12	MARTEL AVENUE	M	S	05-0152	M	S	05-0151	8	238	01/20/14
01/25/12	NORWICH DRIVE	M	S	13-0233	M	S	13-0231	8	68	01/25/15
01/25/12	NORWICH DRIVE	M	S	13-0234	M	S	13-0233	8	346	01/25/15
01/25/12	NORWICH DRIVE	M	S	13-0235	M	S	13-0234	8	346	01/25/15
01/25/12	NORWICH DRIVE	M	S	13-0236	M	S	13-0235	8	171	01/25/15
01/19/12	OGDEN DRIVE	M	S	05-0172	M	S	05-0407	8	348	01/19/14
01/19/12	OGDEN DRIVE	M	S	05-0173	M	S	05-0172	8	346	01/19/14
01/19/12	OGDEN DRIVE	M	S	05-0174	M	S	05-0173	8	344	01/19/14
01/18/12	OGDEN DRIVE	M	S	06-0059	M	S	06-0060	8	319	01/18/15
01/18/12	OGDEN DRIVE	M	S	06-0060	M	S	06-0061	8	322	01/18/14
01/18/12	OGDEN DRIVE	M	S	06-0061	M	S	06-0062	8	216	01/18/14
01/18/12	OGDEN DRIVE	M	S	06-0062	M	S	06-0063	8	260	01/18/14
01/18/12	ORANGE GROVE AV	M	S	05-0169	M	S	05-0170	8	342	01/18/15
01/18/12	ORANGE GROVE AV	M	S	05-0170	M	S	05-0171	8	346	01/18/14
01/18/12	ORANGE GROVE AV	M	S	05-0171	M	S	05-0408	8	348	01/18/14
01/18/12	ORANGE GROVE AV	M	S	06-0044	M	S	06-0045	8	218	01/18/14
01/18/12	ORANGE GROVE AV	M	S	06-0045	M	S	06-0046	8	50	01/18/14
01/18/12	ORANGE GROVE AV	M	S	06-0046	M	S	06-0047	8	295	01/18/15
01/18/12	ORANGE GROVE AV	M	S	06-0047	M	S	06-0048	8	295	01/18/15
01/18/12	ORANGE GROVE AV	M	S	06-0048	M	S	06-0049	8	250	01/18/14
01/26/12	POINSETTA PLACE	M	E	03-0101	M	E	03-0129	12	342	01/26/14
01/18/12	POINSETTA PLACE	M	S	03-0128	M	S	03-0140	12	11	01/18/14
01/26/12	POINSETTA PLACE	M	S	03-0129	M	U	03-0128	12	334	01/26/15
01/20/12	POINSETTIA DRIV	M	S	03-0104	M	S	03-0102	8	320	01/20/15
01/20/12	POINSETTIA DRIV	M	S	03-0105	M	S	03-0104	8	320	01/20/14
01/20/12	POINSETTIA DRIV	M	S	03-0106	M	S	03-0105	8	320	01/20/14
01/19/12	POINSETTIA PLAC	M	S	02-0108	M	S	02-0109	8	237	01/19/15
01/19/12	POINSETTIA PLAC	M	S	02-0109	M	S	02-0110	8	245	01/19/15
01/19/12	POINSETTIA PLAC	M	S	02-0110	M	S	02-0111	8	246	01/19/15
01/19/12	POINSETTIA PLAC	M	S	02-0111	M	S	02-0112	8	271	01/19/15
01/25/12	RANGELY AVENUE	M	S	12-0160	M	S	12-0159	12	346	01/25/14
01/25/12	RANGELY AVENUE	M	S	12-0161	M	S	12-0160	12	335	01/25/14
01/25/12	RANGELY AVENUE	M	S	12-0164	M	S	12-0163	10	104	01/25/14
01/25/12	RANGELY AVENUE	M	S	12-0165	M	S	12-0164	10	346	01/25/14
01/25/12	RANGELY AVENUE	M	S	12-0166	M	S	12-0165	10	246	01/25/14
01/24/12	RANGELY AVENUE	M	S	12-0167	M	S	12-0374	8	219	01/24/14
01/24/12	RANGELY AVENUE	M	S	12-0374	M	S	12-0166	8	246	01/24/14
01/18/12	ROMAINE STREET	M	S	03-0139	M	S	03-0140	8	349	01/18/14
01/25/12	ROSEWOOD AVENUE	M	S	13-0146	M	S	13-0147	8	250	01/25/15
01/25/12	ROSEWOOD AVENUE	M	S	13-0147	M	S	13-0148	8	251	01/25/15
01/25/12	ROSEWOOD AVENUE	M	S	13-0148	M	S	13-0149	8	238	01/25/15
01/20/12	ROSEWOOD AVENUE	M	S	13-0184	M	S	13-0186	8	345	01/20/15
01/20/12	ROSEWOOD AVENUE	M	S	13-0186	M	S	13-0187	8	346	01/20/15
01/20/12	ROSEWOOD AVENUE	M	S	13-0187	M	S	13-0188	8	336	01/20/15
01/20/12	ROSEWOOD AVENUE	M	S	13-0188	M	S	13-0189	8	346	01/20/14
01/20/12	ROSEWOOD AVENUE	M	S	13-0189	M	S	13-0191	8	204	01/20/14
01/24/12	RUGBY DRIVE	M	S	15-0186	M	S	15-0187	8	127	01/24/15
01/24/12	RUGBY DRIVE	M	S	15-0188	M	S	15-0187	8	162	01/24/15
01/24/12	RUGBY DRIVE	M	S	15-0189	M	S	15-0188	8	253	01/24/15
01/25/12	SAN VINCENTE BL	M	S	13-0227	M	S	13-0226	8	197	01/25/15
01/25/12	SAN VINCENTE BL	M	S	13-0228	M	S	13-0227	8	239	01/25/15

Treated Dates: 01/18/12 - 01/26/12

Report Date:01/27/12

Treated	Street	Up Up Up			Down Down Down			Size	Feet	Guar End
		Type	Loc	MH	Type	Loc	MH			
01/25/12	SAN VINCENTE BL	M	S	13-0229	M	S	13-0228	8	350	01/25/15
01/25/12	SHERBOURNE DRIV	M	S	13-0142	M	S	13-0141	10	346	01/25/14
01/25/12	SHERBOURNE DRIV	M	S	13-0149	M	S	13-0142	10	265	01/25/14
01/25/12	SHERBOURNE DRIV	M	S	13-0150	M	S	13-0149	10	281	01/25/14
01/25/12	SHERBOURNE DRIV	M	S	13-0153	M	S	13-0150	10	280	01/25/14
01/26/12	SHERBOURNE DRIV	M	S	13-0219	M	S	13-0220	10	280	01/26/14
01/26/12	SHERBOURNE DRIV	M	S	13-0221	M	S	13-0222	10	238	01/26/14
01/26/12	SHERBOURNE DRIV	M	S	13-0221	M	S	13-0220	10	265	01/26/14
01/26/12	SHERBOURNE DRIV	M	S	13-0222	M	S	14-0140	10	115	01/26/14
01/24/12	SHERWOOD DRIVE	M	S	15-0282	M	S	15-0291	8	311	01/24/15
01/24/12	SHERWOOD DRIVE	M	S	15-0370	M	S	15-0282	8	315	01/24/15
01/19/12	SIERRA BONITA A	M	S	05-0187	M	S	05-0188	8	236	01/19/14
01/19/12	SIERRA BONITA A	M	S	05-0188	M	S	05-0189	8	236	01/19/14
01/19/12	SIERRA BONITA A	M	S	05-0189	M	S	05-0190	8	281	01/19/15
01/19/12	SIERRA BONITA A	M	S	05-0190	M	S	05-0402	8	282	01/19/14
01/18/12	SPAULDING AVENU	M	S	04-0078	M	S	04-0077	8	126	01/18/14
01/18/12	SPAULDING AVENU	M	S	04-0089	M	S	04-0233	8	169	01/18/14
01/19/12	SPAULDING AVENU	M	S	05-0178	M	S	05-0179	8	344	01/19/14
01/19/12	SPAULDING AVENU	M	S	05-0179	M	S	05-0180	8	346	01/19/14
01/19/12	SPAULDING AVENU	M	S	05-0180	M	S	05-0405	8	348	01/19/14
01/19/12	STANLEY AVENUE	M	S	05-0163	M	S	05-0181	8	285	01/19/15
01/19/12	STANLEY AVENUE	M	S	05-0181	M	S	05-0182	8	284	01/19/14
01/19/12	STANLEY AVENUE	M	S	05-0182	M	S	05-0183	8	280	01/19/14
01/19/12	STANLEY AVENUE	M	S	05-0183	M	S	05-0404	8	282	01/19/14
01/18/12	VISTA STREET	M	S	03-0091	M	S	03-0092	8	180	01/18/15
01/18/12	VISTA STREET	M	S	03-0092	M	S	03-0093	8	110	01/18/14
01/18/12	VISTA STREET	M	S	03-0093	M	S	03-0094	8	288	01/18/14
01/18/12	VISTA STREET	M	S	03-0094	M	S	03-0095	8	286	01/18/15
01/18/12	VISTA STREET	M	S	03-0095	M	S	03-0096	8	288	01/18/15
01/20/12	VISTA STREET	M	S	05-0154	M	S	05-0153	8	191	01/20/15
01/20/12	VISTA STREET	M	S	05-0155	M	S	05-0154	8	187	01/20/15
01/24/12	WESTBOURNE DRIV	M	S	09-0256	M	S	09-0255	8	339	01/24/15
01/24/12	WESTBOURNE DRIV	M	S	09-0257	M	S	09-0256	8	329	01/24/15
01/24/12	WESTBOURNE DRIV	M	S	15-0185	M	S	15-0186	8	66	01/24/15
01/24/12	WESTBOURNE DRIV	M	S	15-0186	M	S	15-0293	8	196	01/24/15
01/24/12	WESTBOURNE DRIV	M	S	15-0289	M	S	15-0288	8	326	01/24/15
01/24/12	WESTBOURNE DRIV	M	S	15-0290	M	S	15-0289	8	360	01/24/15
01/24/12	WESTBOURNE DRIV	M	S	15-0291	M	S	15-0290	8	345	01/24/15
01/24/12	WESTBOURNE DRIV	M	S	15-0292	M	S	15-0291	8	219	01/24/15
01/24/12	WESTBOURNE DRIV	M	S	15-0293	M	S	15-0292	8	325	01/24/15
01/24/12	WESTBOURNE DRIV	M	S	16-0251	M	S	16-0250	8	166	01/24/14
01/24/12	WESTBOURNE DRIV	M	S	16-0252	M	S	16-0251	8	296	01/24/15
01/24/12	WESTBOURNE DRIV	M	S	16-0253	M	S	16-0252	8	271	01/24/15
01/24/12	WESTBOURNE DRIV	M	S	16-0254	M	S	16-0253	8	281	01/24/15
01/24/12	WESTMOUNT DRIVE	M	S	09-0258	M	S	09-0259	8	264	01/24/15
01/24/12	WESTMOUNT DRIVE	M	S	09-0259	M	S	09-0260	8	261	01/24/15
01/24/12	WESTMOUNT DRIVE	M	S	09-0260	M	S	09-0261	8	348	01/24/15
01/24/12	WESTMOUNT DRIVE	M	S	15-0279	M	S	15-0280	8	349	01/24/15
01/24/12	WESTMOUNT DRIVE	M	S	15-0280	M	S	15-0281	8	346	01/24/15
01/24/12	WESTMOUNT DRIVE	M	S	15-0281	M	S	15-0282	8	51	01/24/15
01/24/12	WESTMOUNT DRIVE	M	S	15-0283	M	S	15-0284	8	306	01/24/15
01/24/12	WESTMOUNT DRIVE	M	S	15-0284	M	S	15-0285	8	325	01/24/15
01/24/12	WESTMOUNT DRIVE	M	S	15-0285	M	S	15-0286	8	341	01/24/15

Manhole Type Codes:

C Clean Out
H House Number
L Line Number
M Manhole Number

Manhole Location Codes:

A Alley
B Backyard
E Easement (woods or no building)
F Front Yard
L Left Side Yard(when facing front)
R Right Side Yard(when facing front)
S Street
U Unknown

Break Down:

10	2,766
12	1,368
8	42,376
Total:	46,510

APPENDIX E

Overflow Emergency Response Plan Regulatory Contact Information

6.1.1 REGULATORY AGENCIES NOTIFICATION AND TIME FRAME

SSO Category	Type or Description	Agencies to be Notified	Type of Notification and Timeframe	
			Telephone/Fax	Written Report/*Online Database
1	A. SSO ≥ 1,000 gallons	Health Department	As soon as possible, but no later than 15 minutes after becoming aware of the spill.	NA
	B. Results in discharge to drainage channel and/or surface water	Flood Maintenance Division	As soon as possible, but no later than 2 hours after becoming aware of the spill.	NA
	C. Discharge to a storm drainpipe and not fully captured and returned to the sanitary sewer system	RWQCB (Region 4 or 6)	As soon as possible, but no later than 2 hours after becoming aware of the spill.	Certify that the notification has been made ASAP, but no later than 24 hours after becoming aware of the spill.
		Cal EMA	Immediately or as soon as possible	NA
SWRCB	As soon as we become aware of the SSO, reporting is possible and can be provided without substantially impeding cleanup or other measures.	Online Initial Report - ASAP but no later than initial 3 business days after we are made aware of it. Final Online Certified Report – Within 15 calendar days on conclusion of the SSO response and remediation. Additional Information – Anytime in form of an attachment.		
2	All other SSOs resulting from SMD sanitary sewer system	Health Department RWQCB (Region 4) Cal EMA RWQCB (Region 6) SWRCB	Same as above Same as above Same as above Same as above N/A	NA Same as above NA Same as above Online – Within 30 days after the end of the calendar month in which the SSO occurred.
3	Private lateral sewage discharge caused by blockages or other problems within a privately-owned lateral	Health Department SWRCB (optional) Cal EMA RWQCB (Regions 4 and 6)	Same as above NA Same as above Same as above	NA NA NA Same as above
NA	No SSO in a calendar month	SWRCB	NA	Online Database Certified – Within 30 days after the end of the calendar month, certified statement that no SSO occurred.

* If the SSO database is not available, fax the required information to the appropriate RWQCB, but enter the information into the online database as soon as possible.

6.1.2 AGENCIES TELEPHONE/FAX NUMBERS

Agency	Contacts	Hours of Operation
County Health Department	(213) 974-1234	Answered on a 24-hour, 7-day a week basis
California Emergency Management Agency	1-800-852-7550	Answered on a 24-hour, 7-day a week basis
Los Angeles Regional Water Quality Control Board (Region 4)	(213) 576-6600 (213) 576-6650	Answered only during normal working hours
Lahontan Regional Water Quality Control Board (Lancaster/Palmdale area) (Region 6)	(760) 241-6583	Answered only during normal working hours
Flood Maintenance Division East Area	(626) 445-7630 (626) 798-6761	Answered only during normal working hours
South Area	(562) 861-0316	Answered only during normal working hours
West Area	(818) 896-0594 (818) 248-3842	Answered only during normal working hours
State Water Resource Control Board	Online database website address	