



Robertson - Existing





Existing: 40' roadway + 10' sidewalks
2 travel lanes 2 parking lanes



Options

If 2 vehicle lanes + 2 parking lanes:

- Curb extensions near intersections & at park

If 2 vehicle lanes + 1 parking lane (-26 spaces), **10'**:

- 15' sidewalks on both sides OR
- 20' sidewalk on one side

If 2 vehicle lanes only (-50 spaces), **20'**:

- 15' sidewalks on both sides + bike lanes
- 20' sidewalks

Option 1

Curb extensions near intersections & at park

Change in parking spaces: -12



Option 1

Curb extensions near intersections & at park

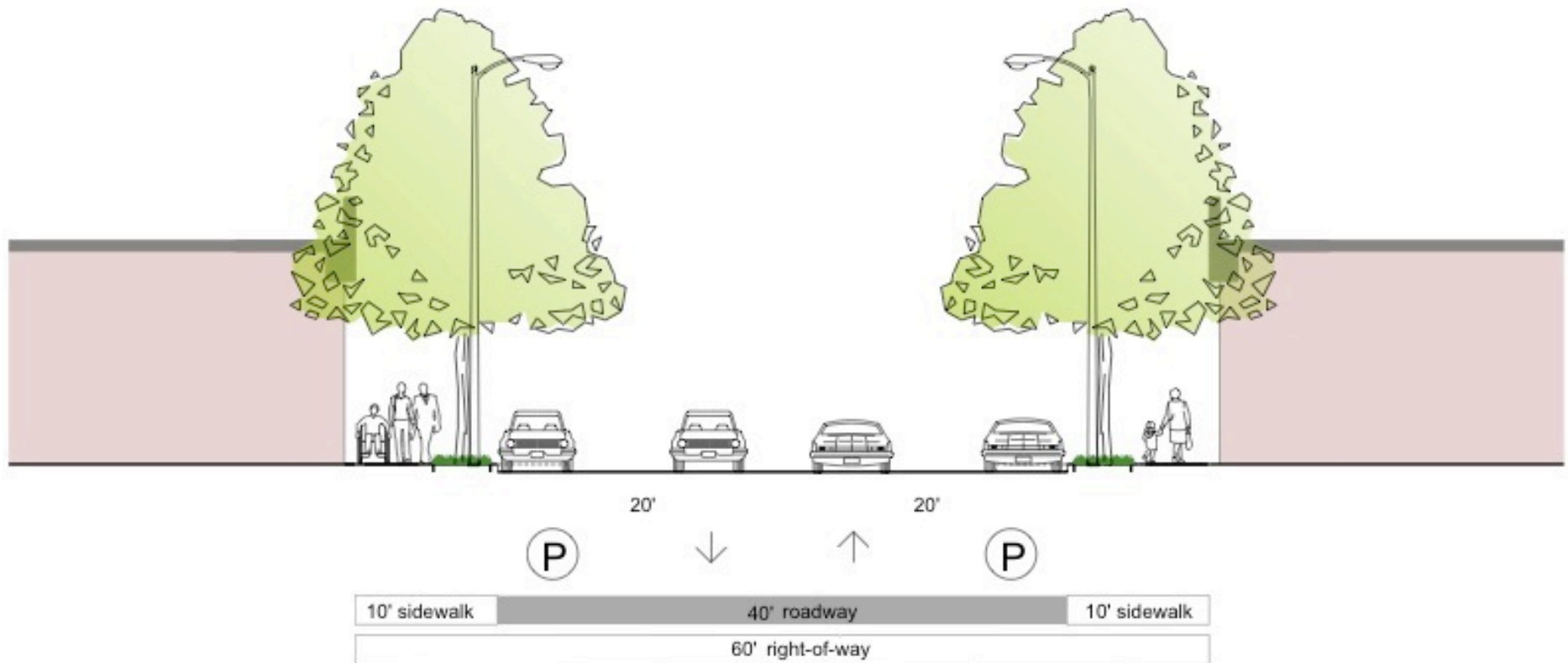

Option 2

15' sidewalks on both sides

Change in parking spaces: -25

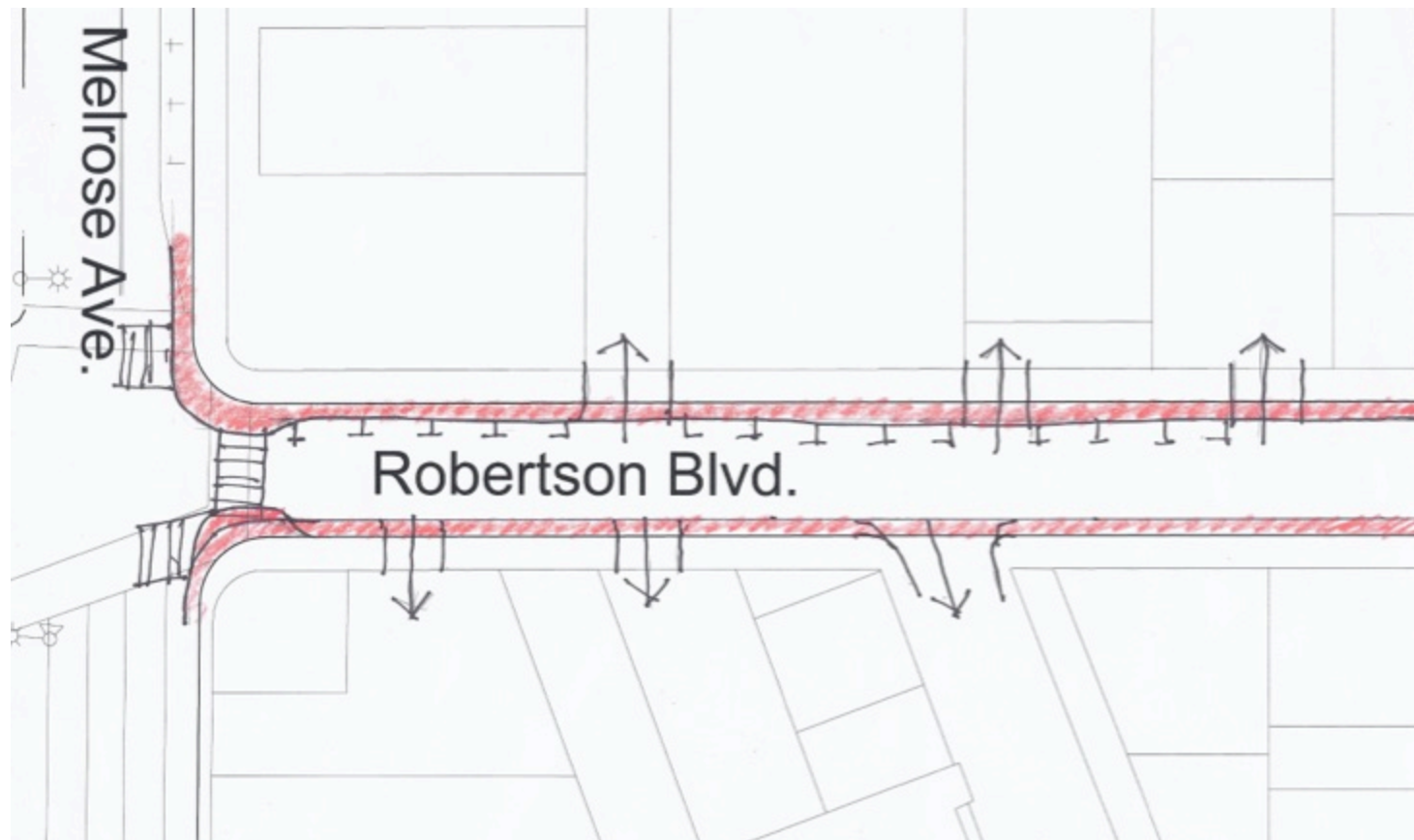

Option 2

15' sidewalks on both sides

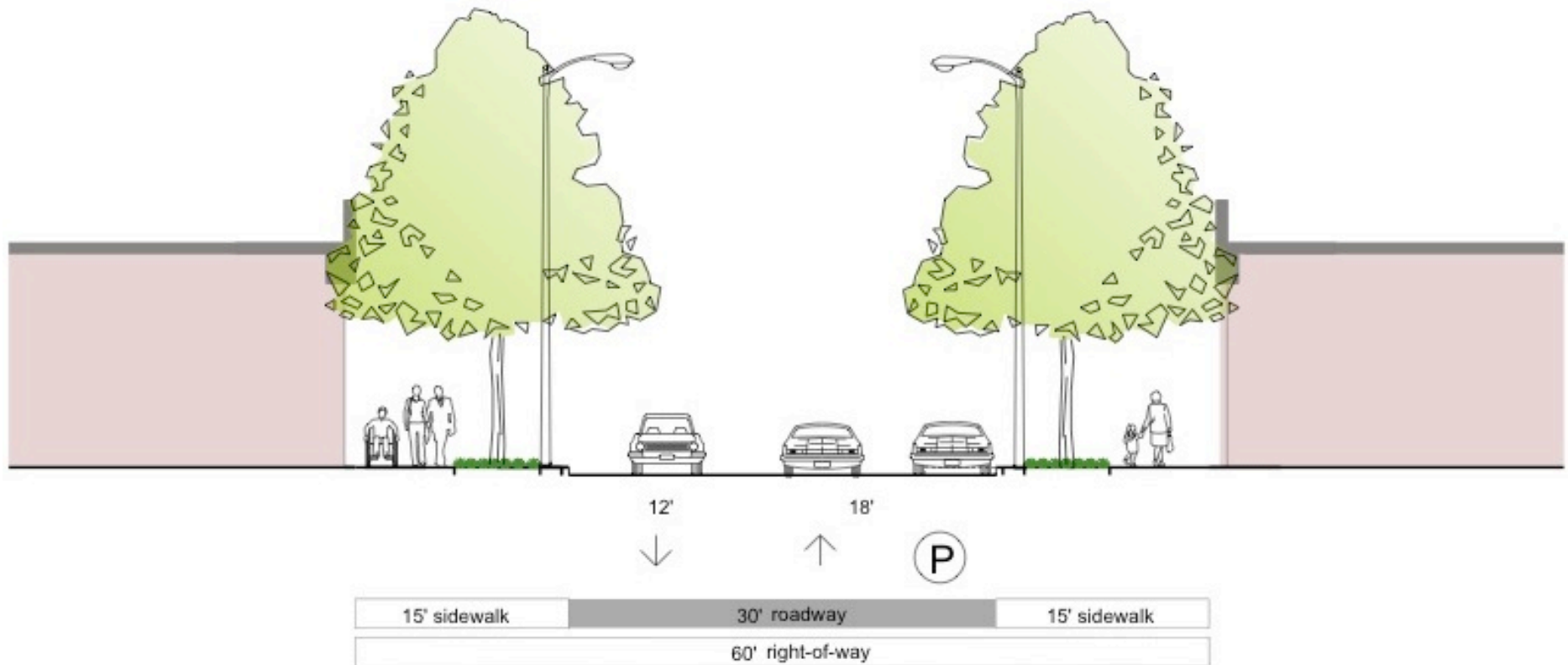

Option 3

20' sidewalk on one side

Change in parking spaces: -25

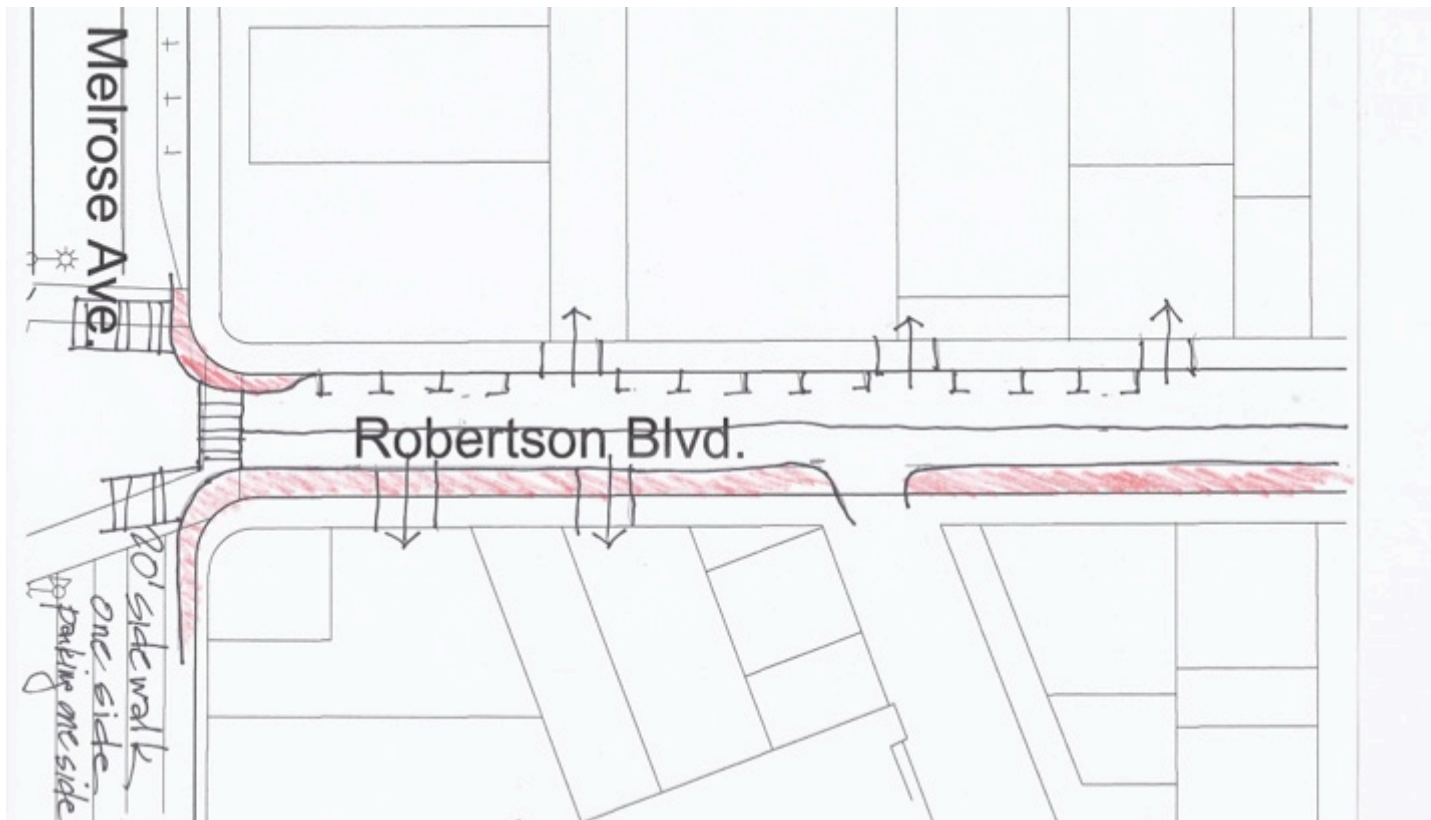

Option 3

20' sidewalk on one side

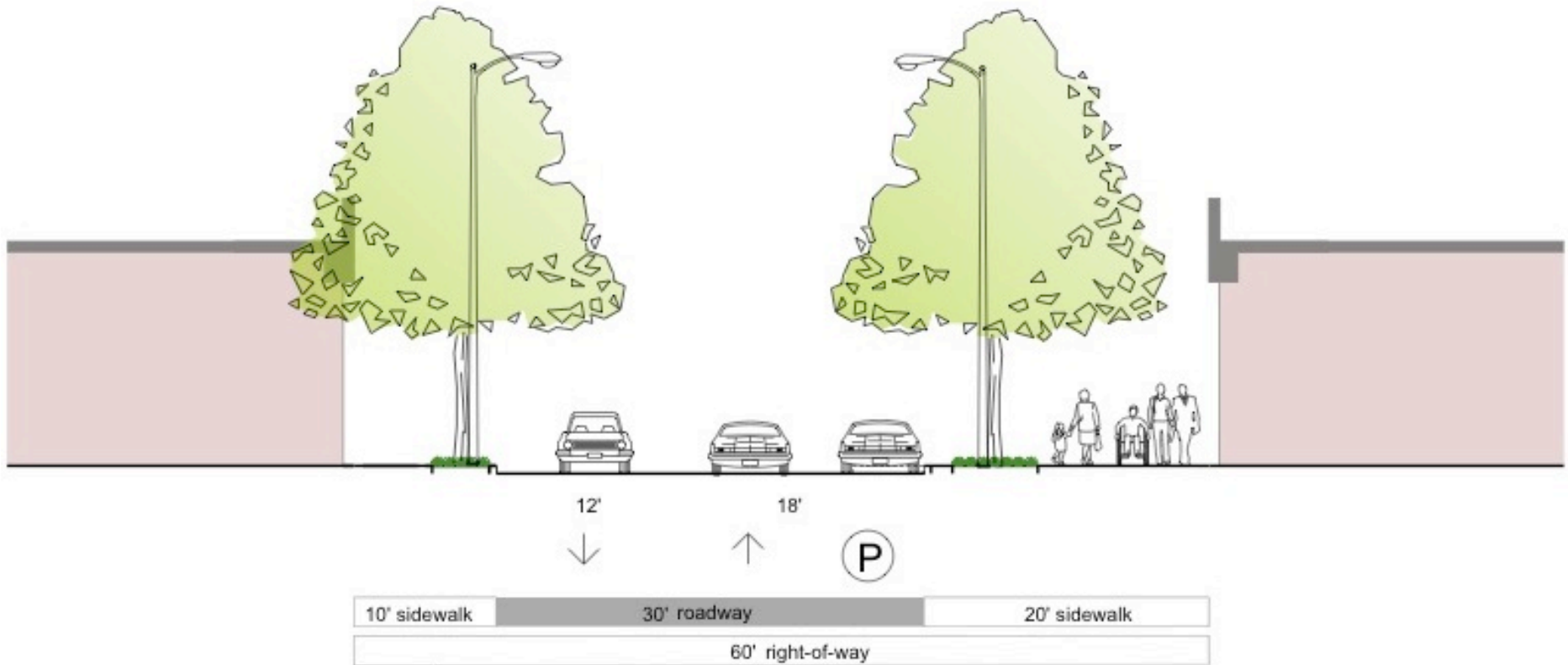

Option 4

15' sidewalks + bike lanes

Change in parking spaces: -50

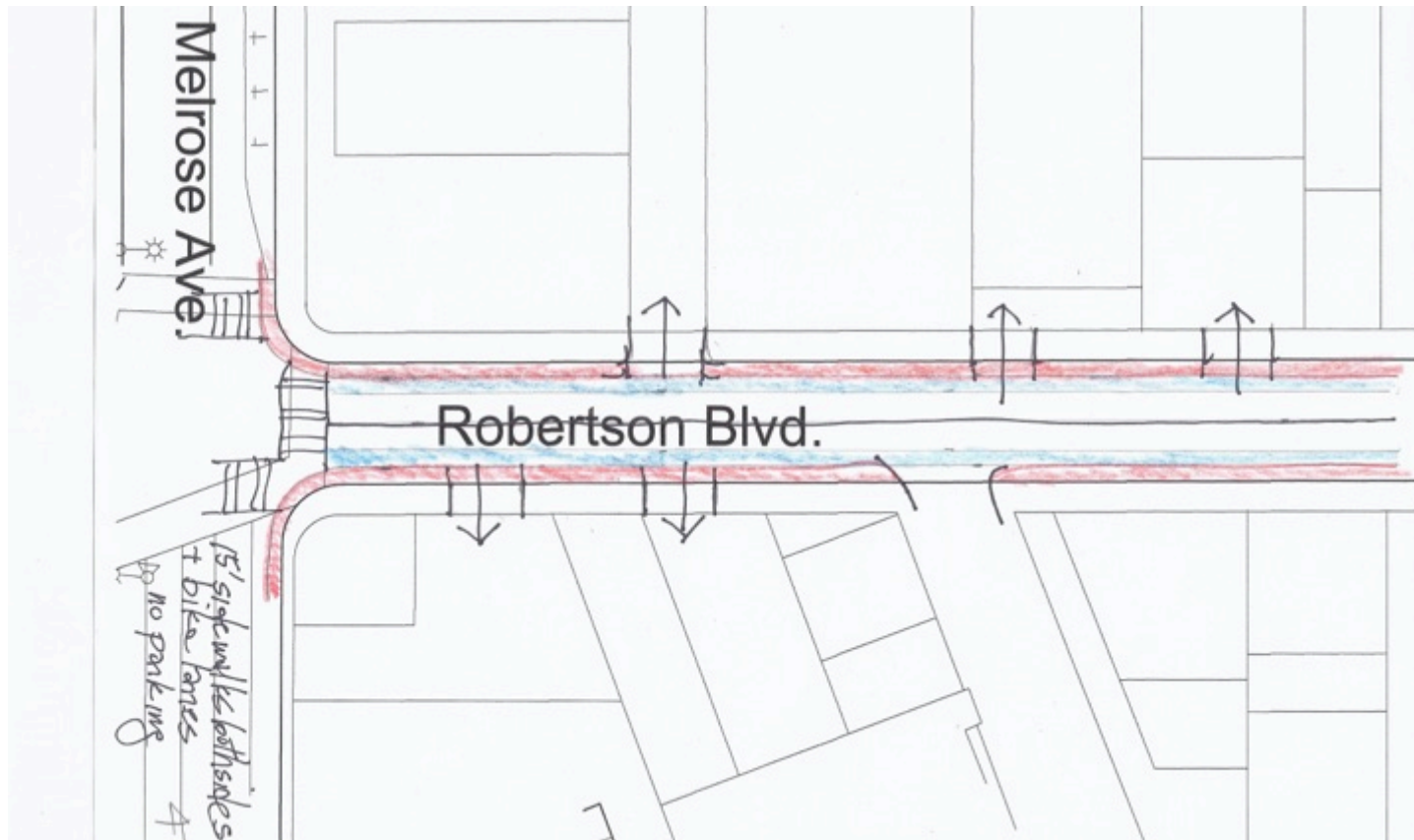

Robertson North of Melrose

Option 4

15' sidewalks + bike lane

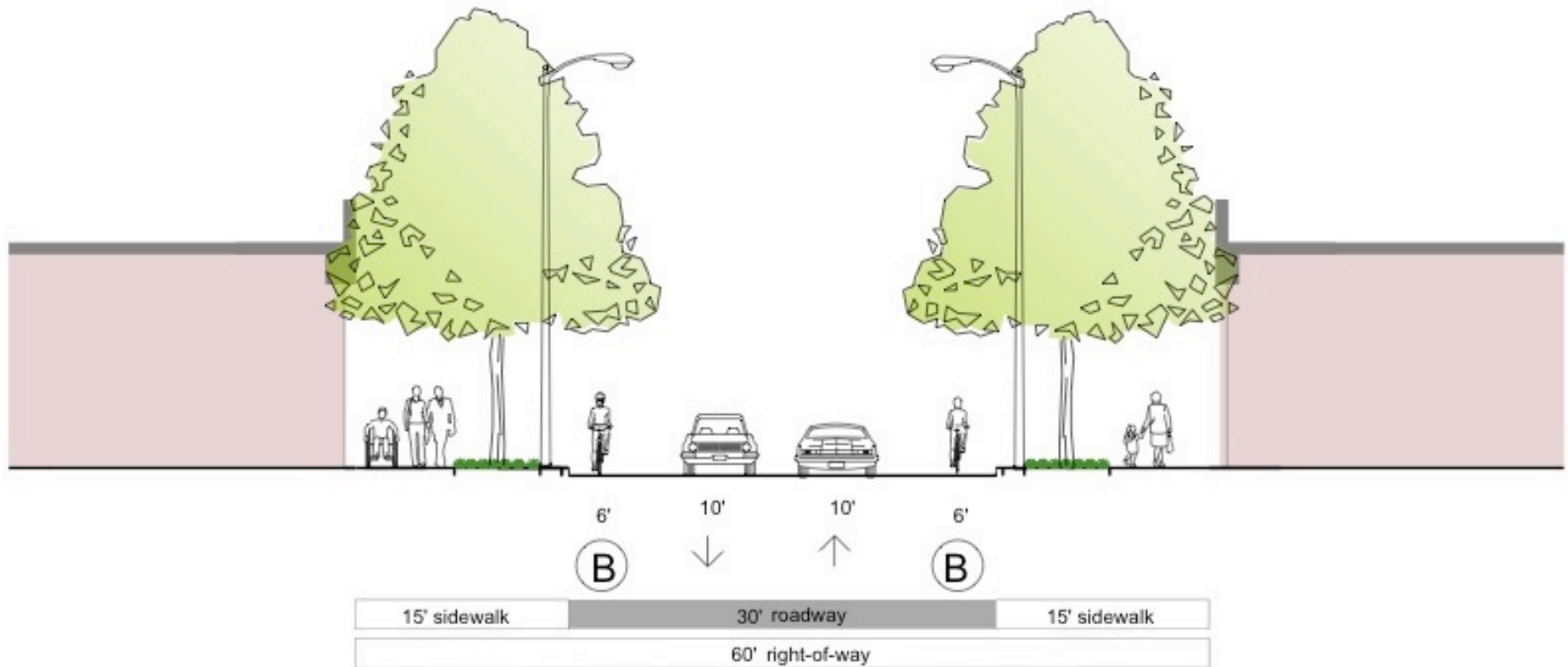

Option 5

20' sidewalks

Change in parking spaces: -50

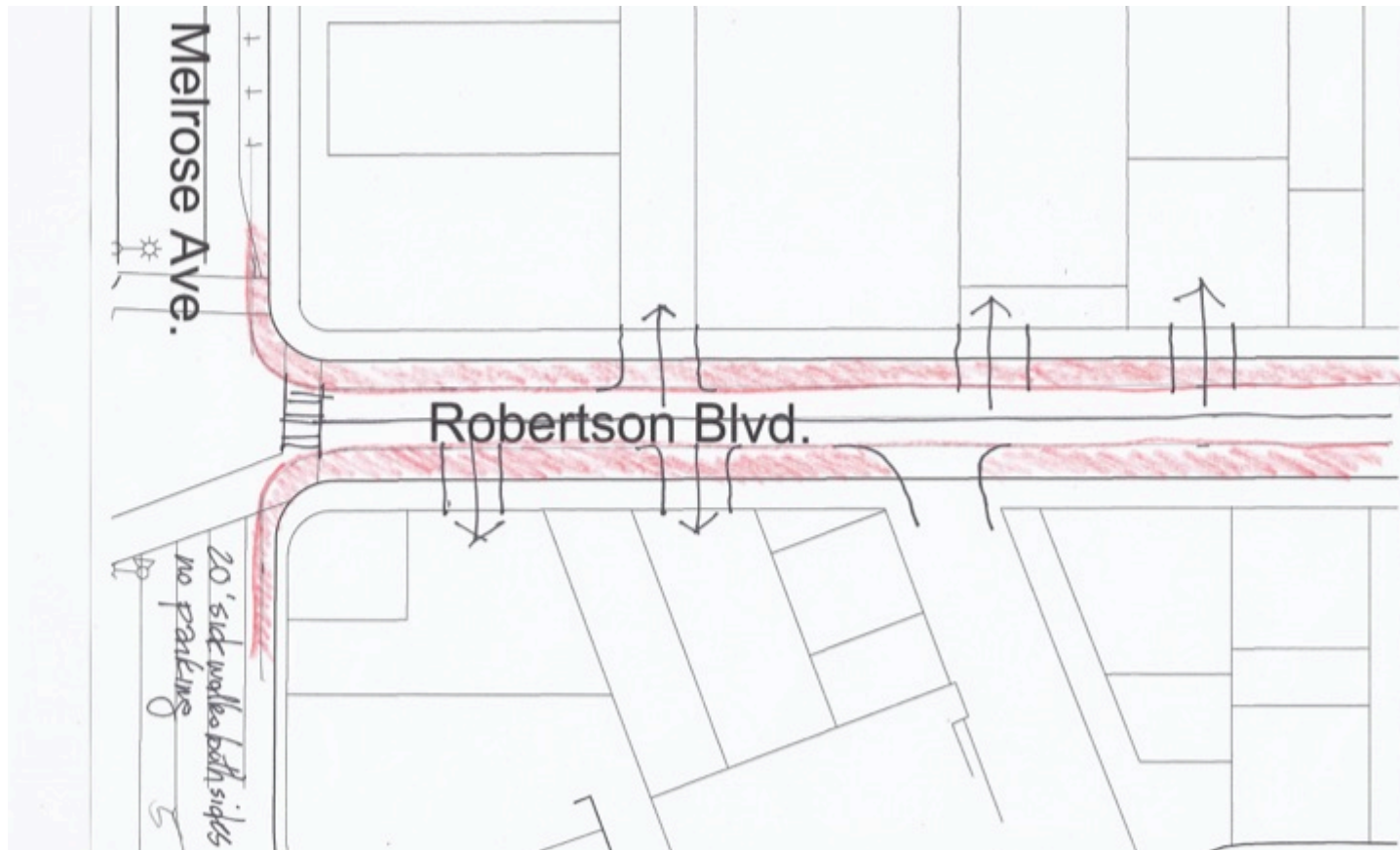

Robertson North of Melrose

Option 5

20' sidewalks

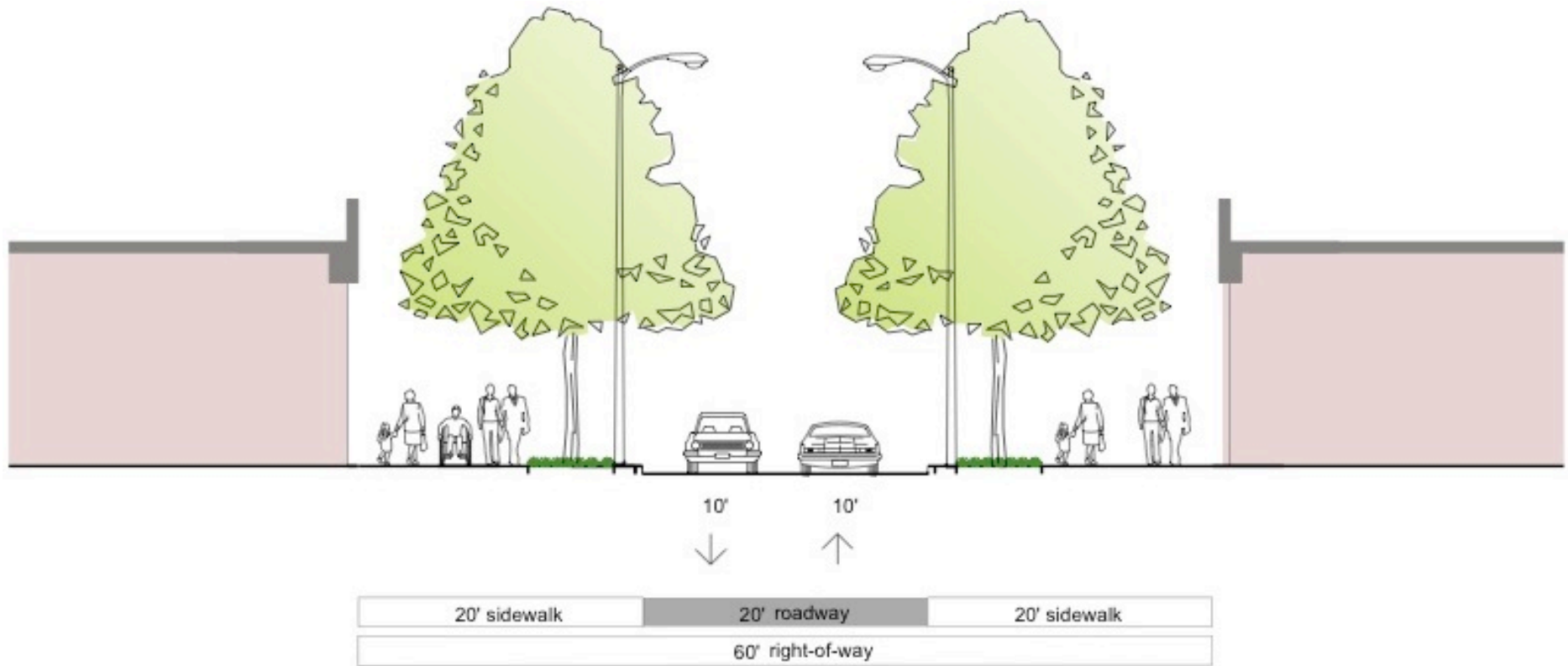

Existing: 70' roadway + 15' sidewalks
Center lane + 4 travel lanes + 2 parking lanes



Options

No change to existing cross sections

- Landscaped medians

Eliminate center lane, **10' to re-purpose:**

- On-street bike lanes
- Raised bike tracks adj. to sidewalk

Narrow sidewalks by 2-3' each side, **4-6' to re-purpose:**

- On-street bike lanes

Option 1 Landscaped Medians

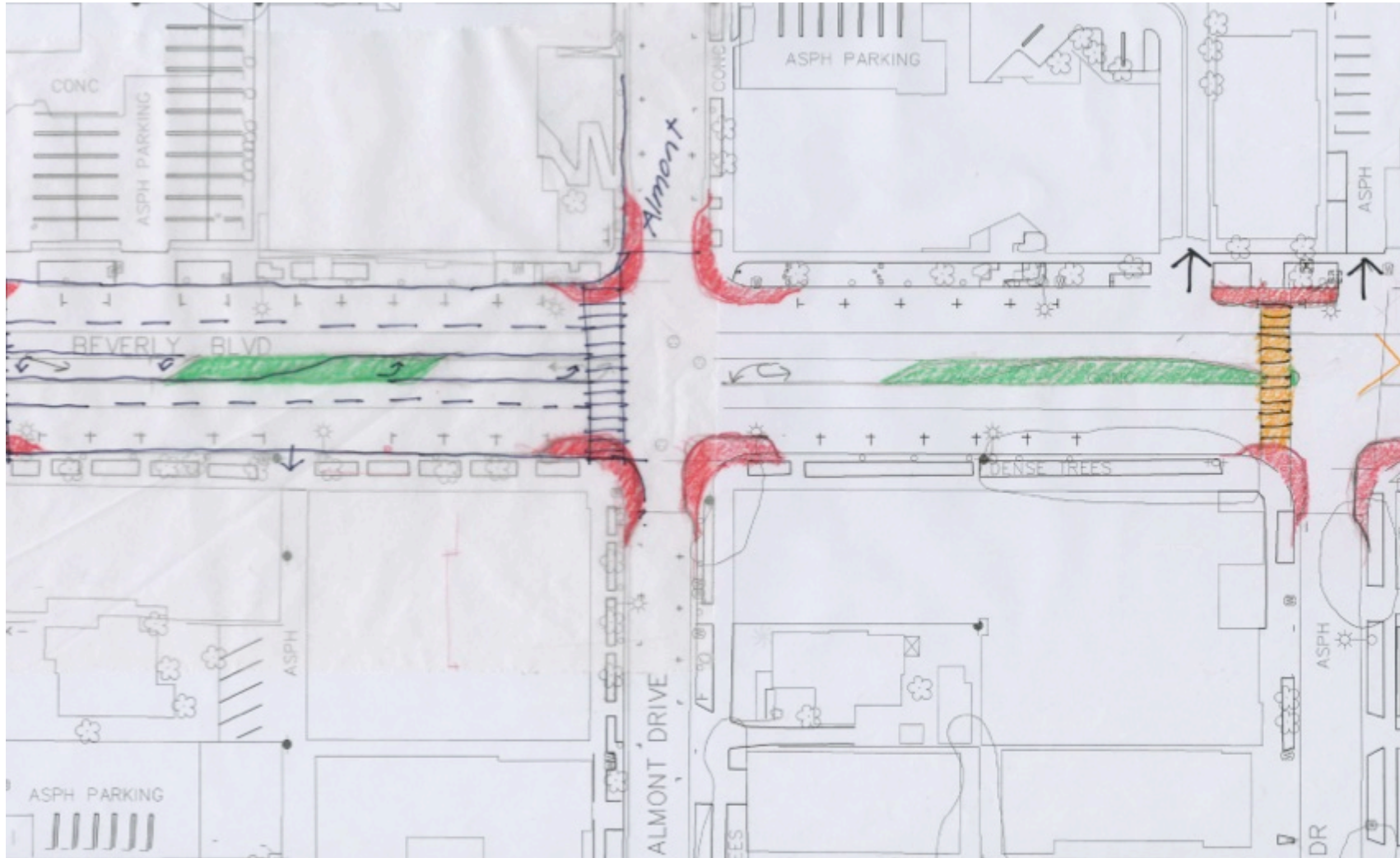

Option 1 Landscaped Medians

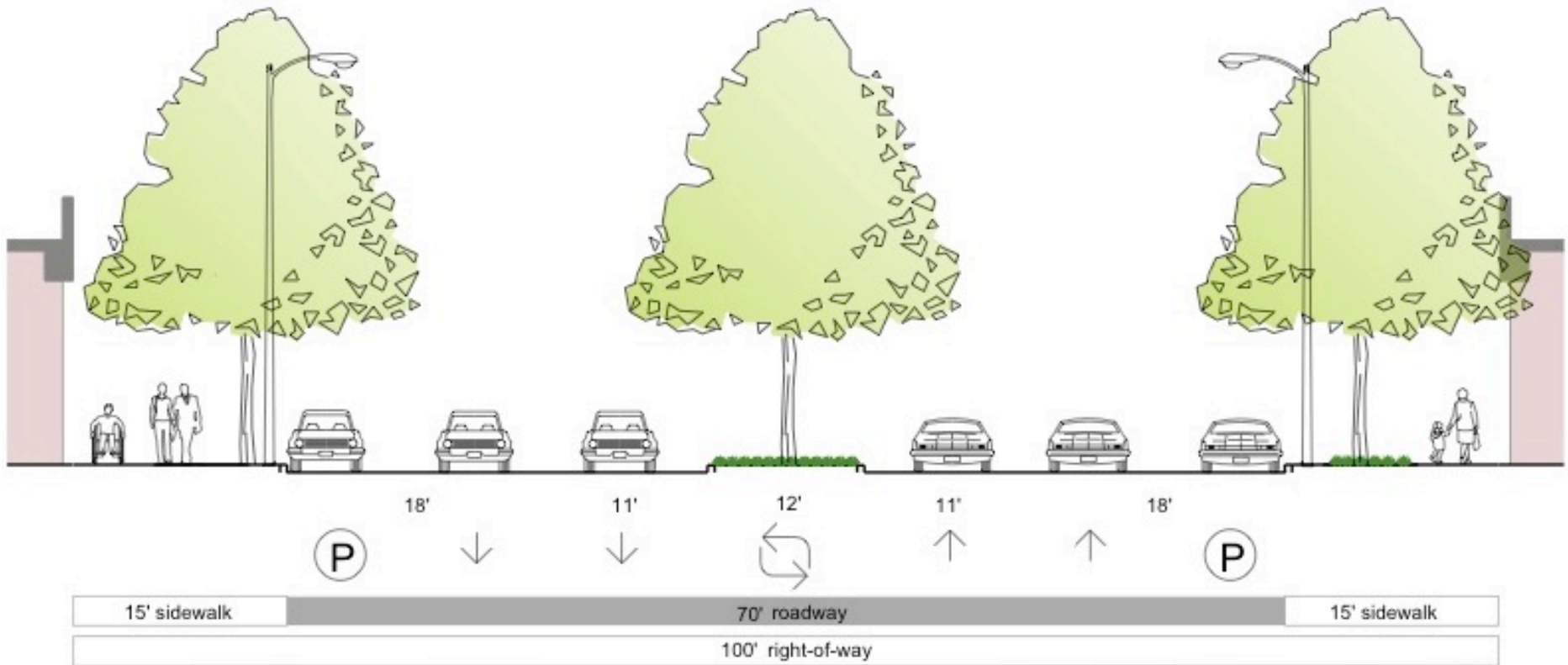

Option 2 Eliminate Center Lane / Add Bike Lanes

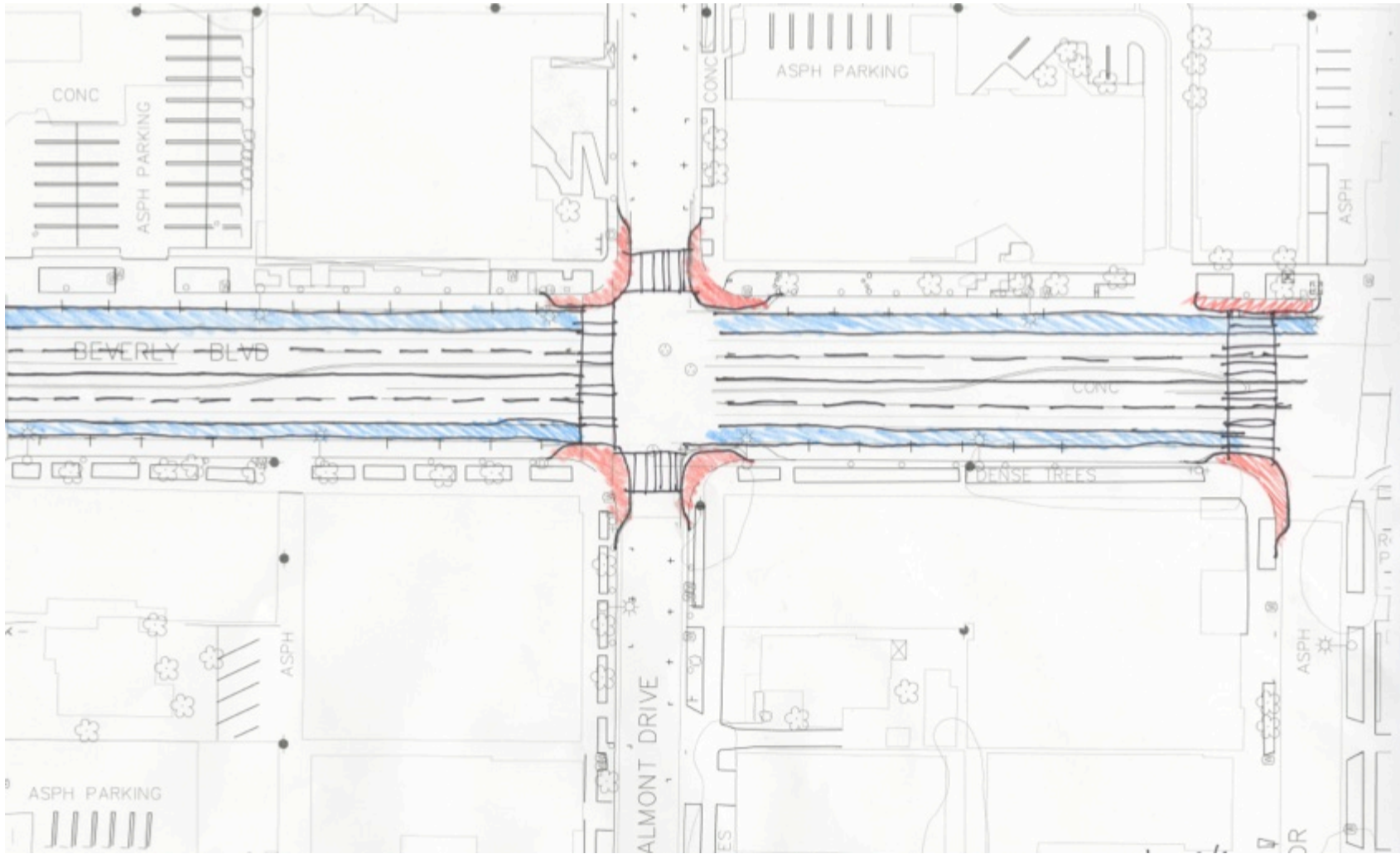

Option 2 Eliminate Center Lane / Add Bike Lanes

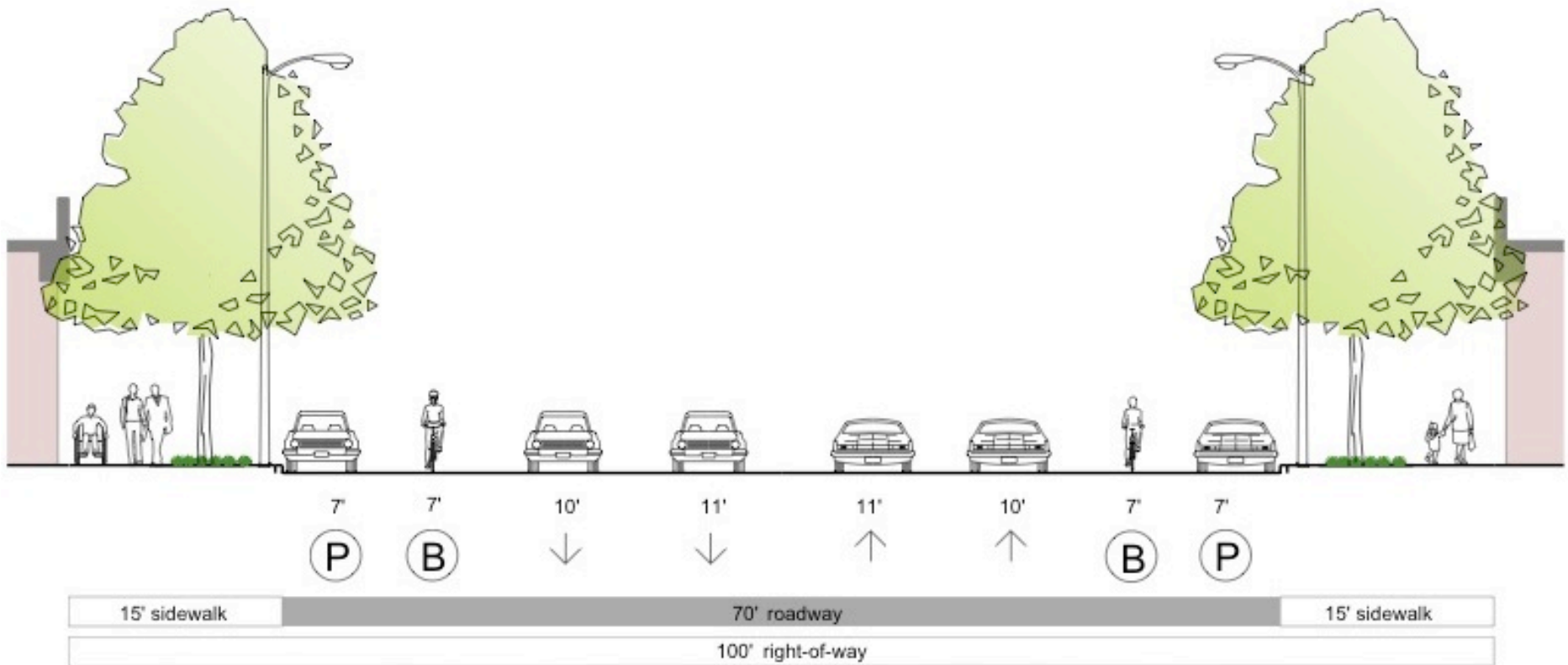

Option 3 Eliminate Center Lane / Add Raised Bike Tracks

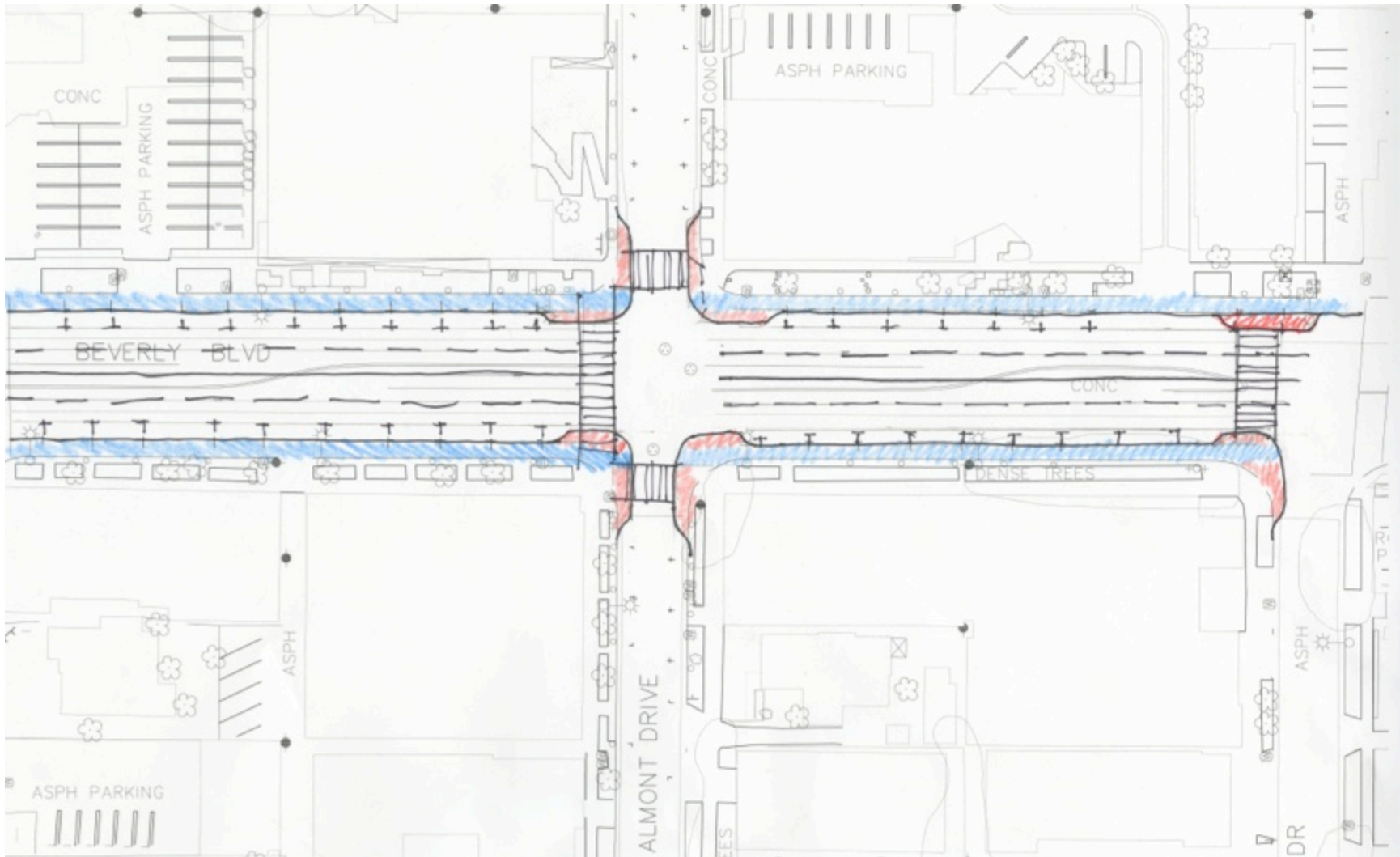

Option 3 Eliminate Center Lane / Add Raised Bike Tracks

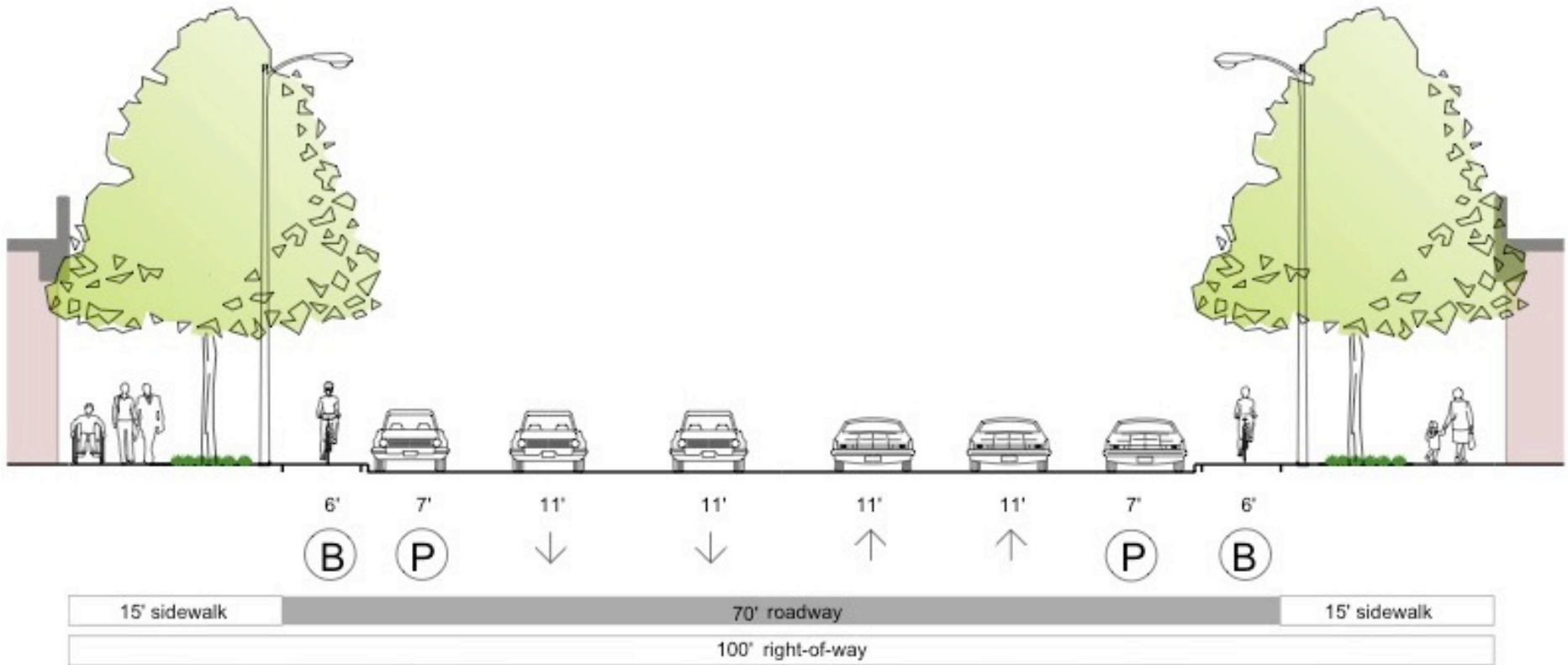

Option 4 Narrow Sidewalks / Add Bike Lanes

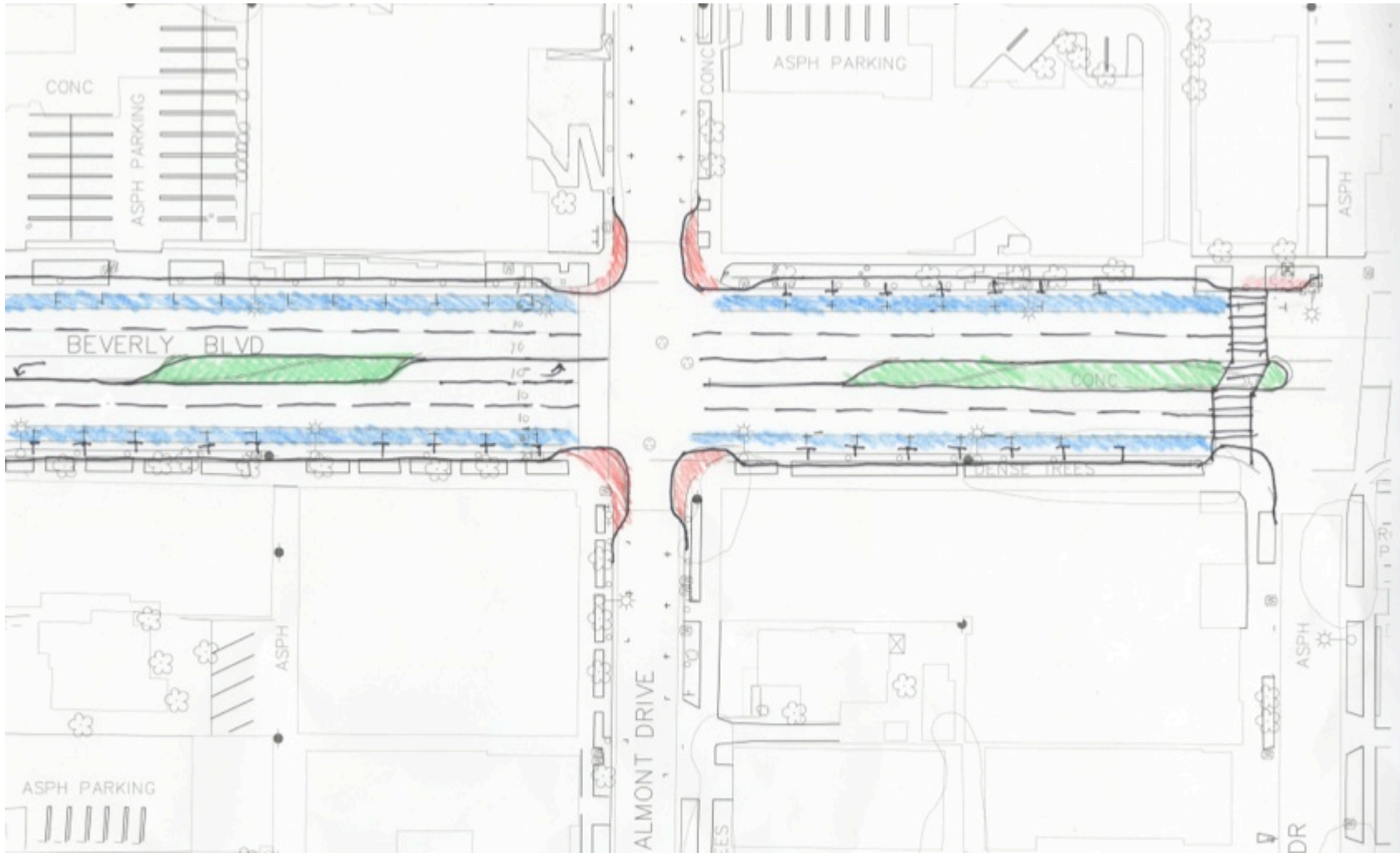

Option 4 Narrow Sidewalks / Add Bike Lanes

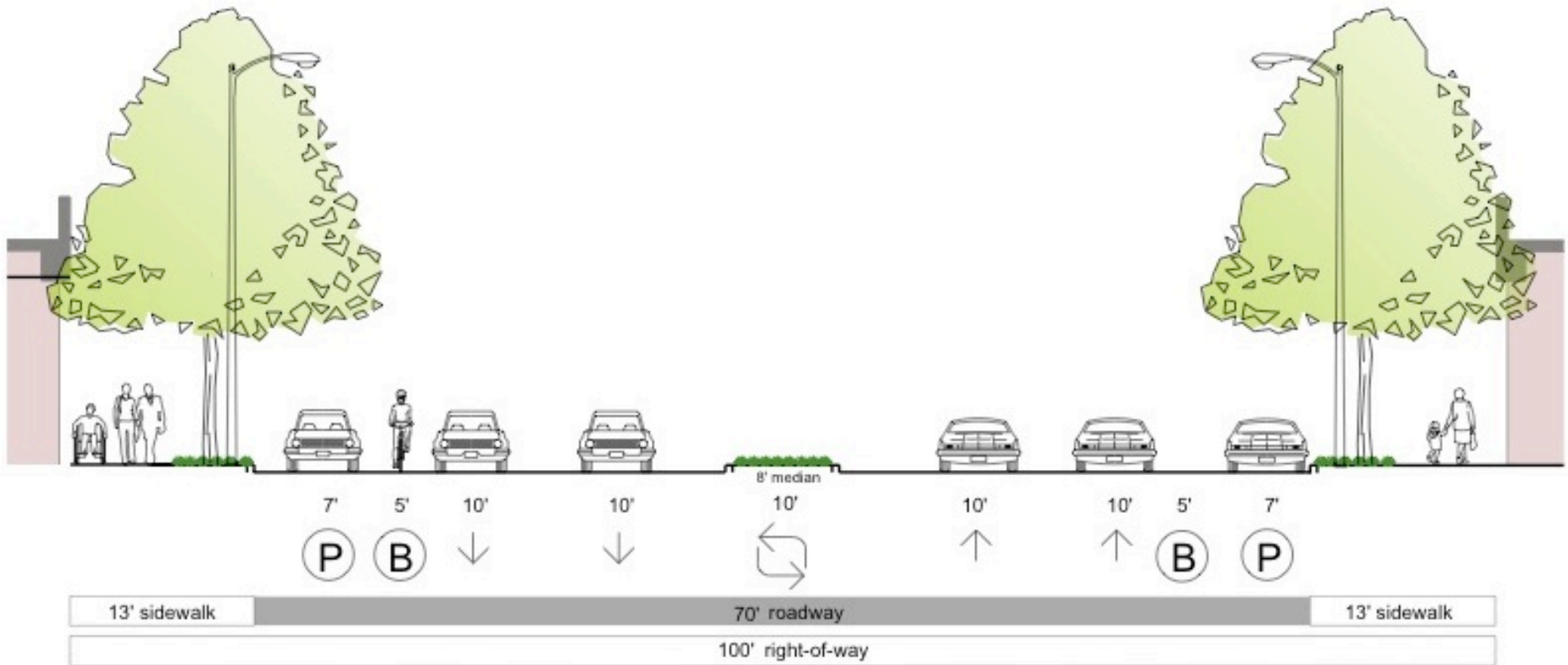



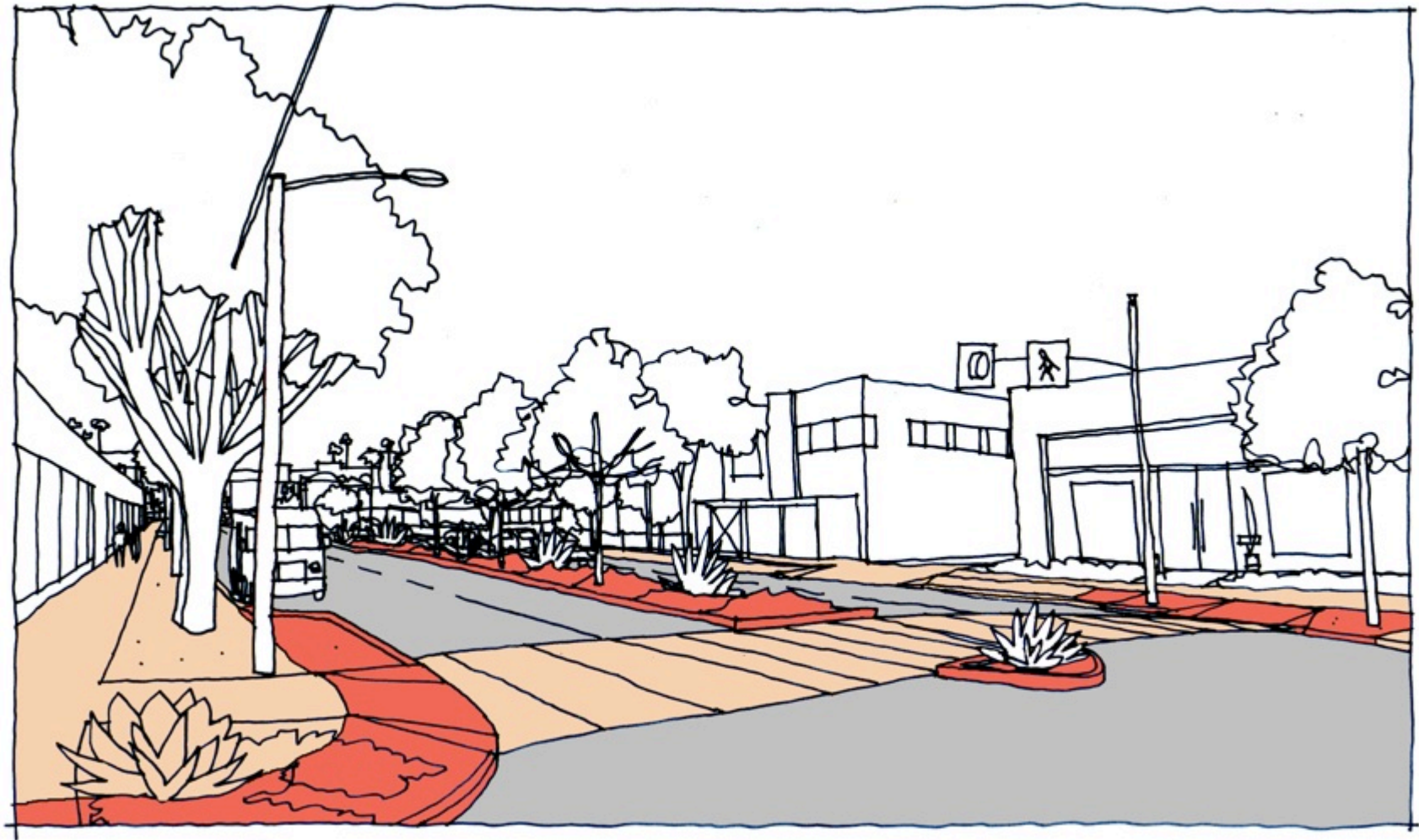

Other Possibilities – Give Us Your Input

1. Crosswalk islands on Melrose and Robertson.
2. Midblock curb extension locations.
3. District valet station locations.





Option 3 15' Sidewalks

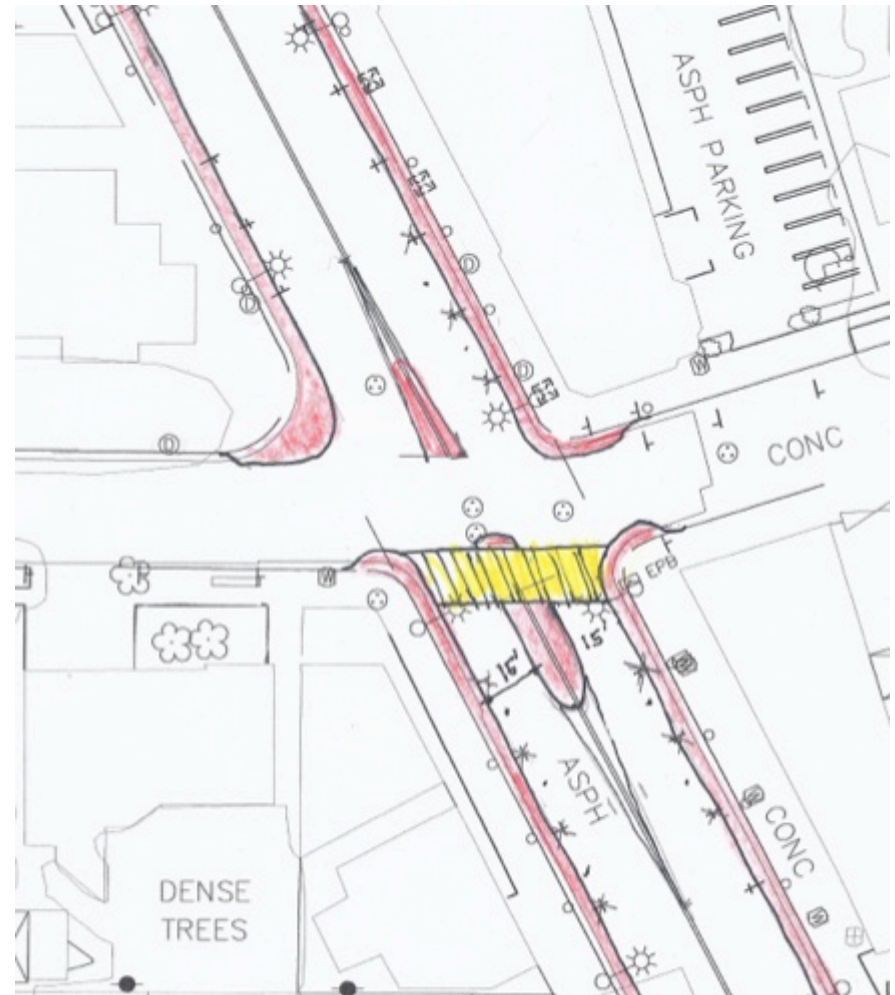

Island: -8 parking spaces

Crosswalk Islands instead of Curb Extensions

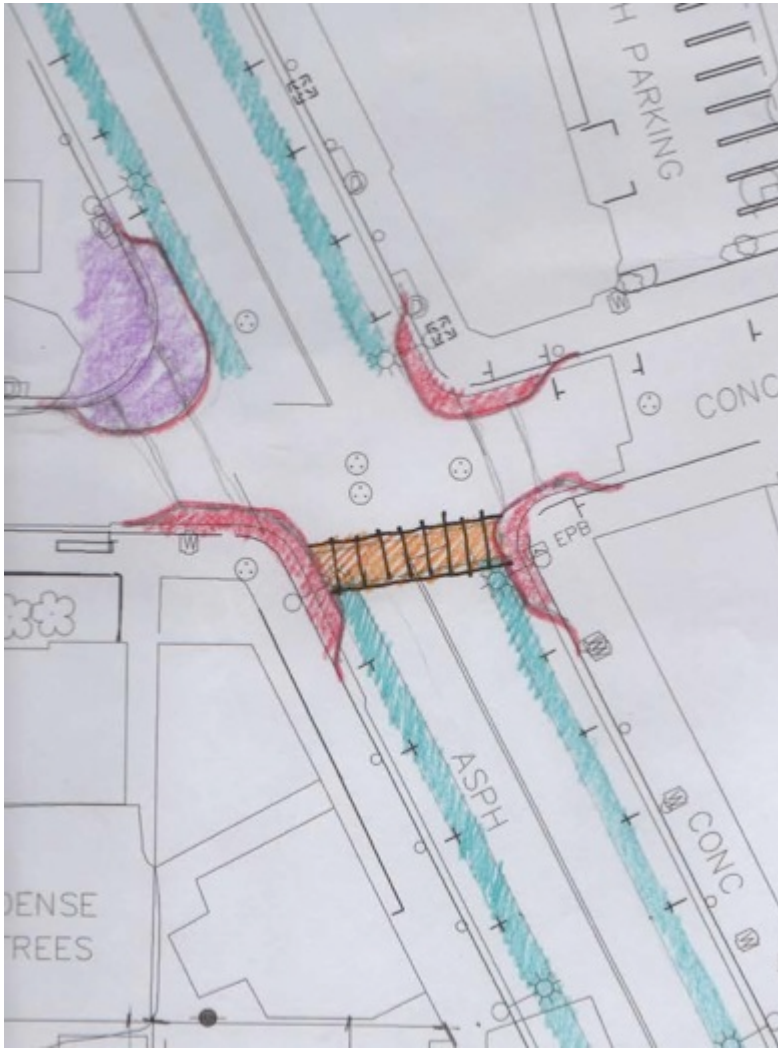

Option 2 Bike Lanes

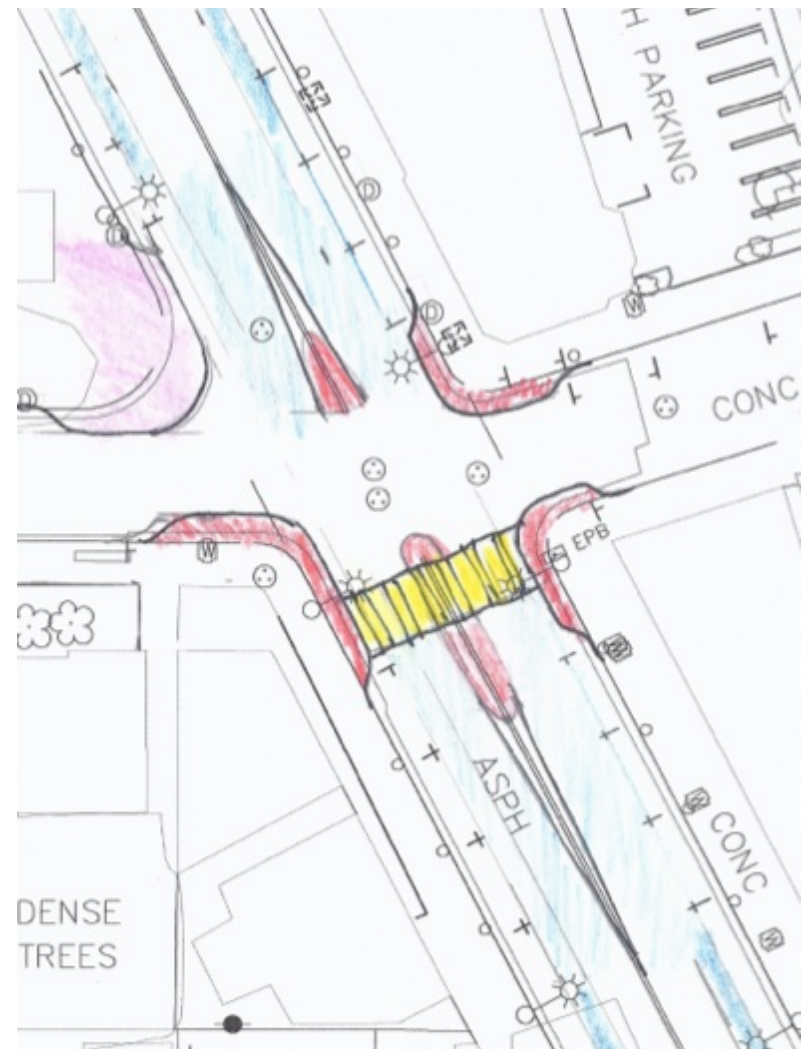

Island: sharrows not bike lanes

Crosswalk Islands instead of Bike Lanes

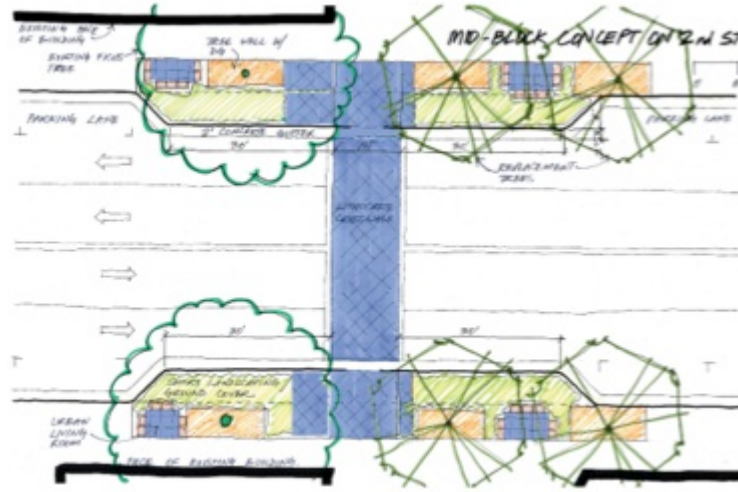

Mid-Block Curb Extension Locations

Future Topics: Streetscape Design

Walkways/parkways/setbacks,
street trees & lights, stormwater infiltration

July

Gathering places, wayfinding,
furnishings, other lighting, art

August

Note: Parklet locations will be selected by business owners.

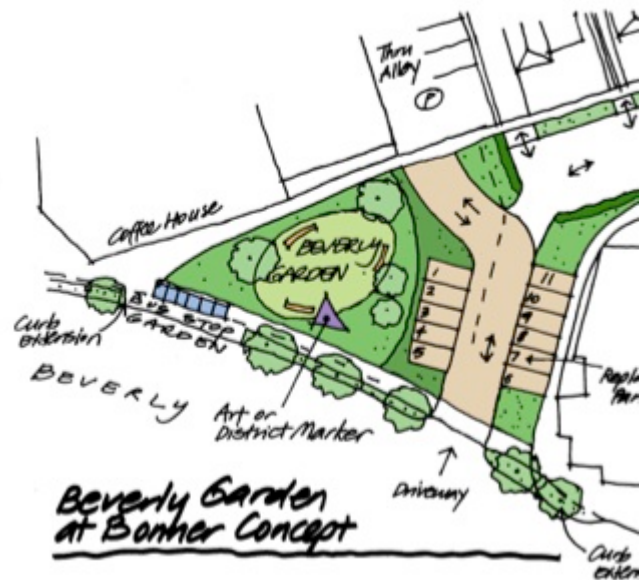

4. Enhance pedestrian & bike access / safety

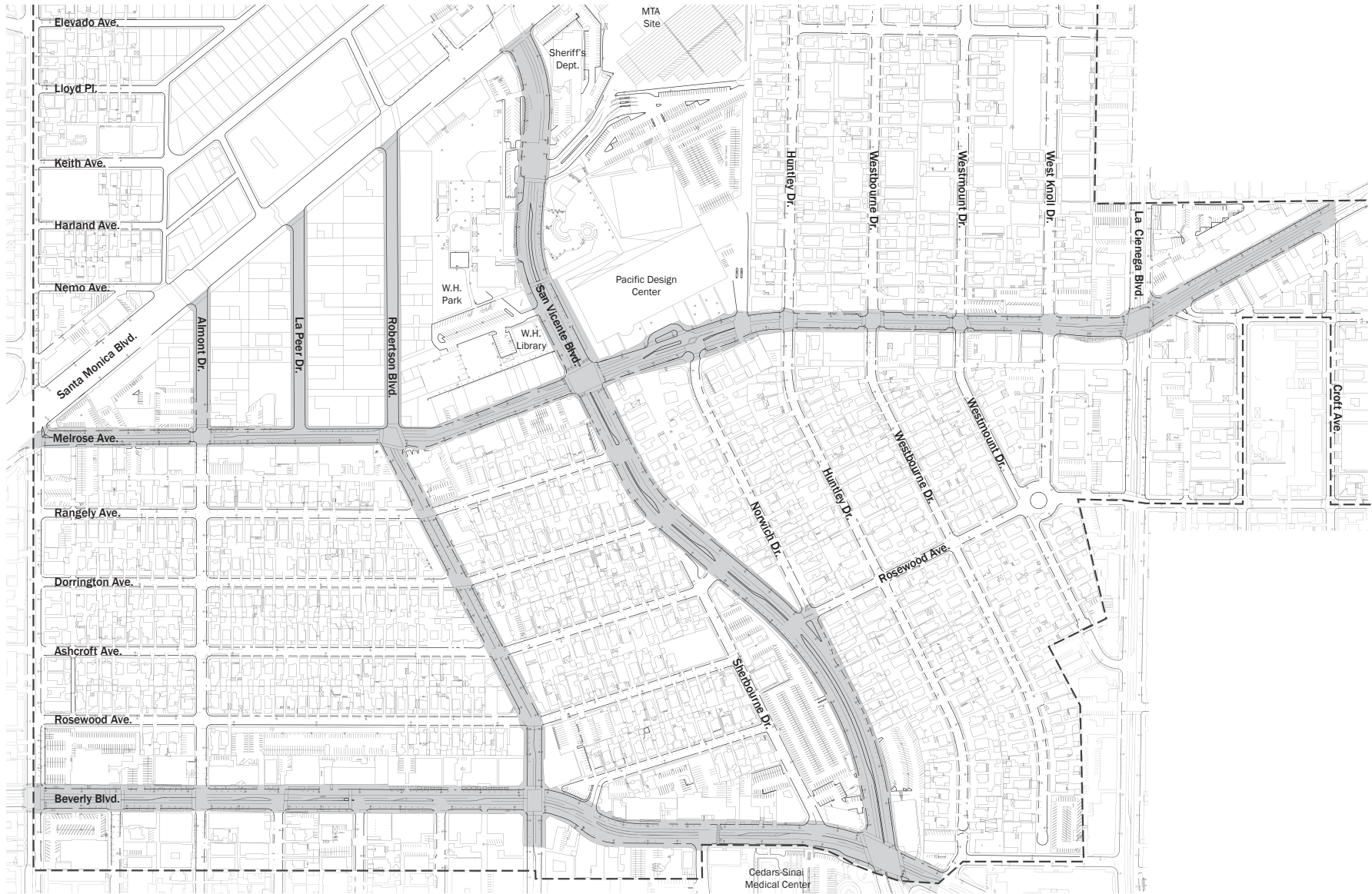

Our Work Today: Select Option(s) for Each Avenue

Presentation (45 minutes):

1. Working Group's mobility objectives
2. Mobility strategies
3. Mobility options for each avenue
4. "Best Practices" to implement where appropriate

Work Session (1 hour +) – break into groups

1. Select preferred option(s) for each avenue
2. Present back to entire group

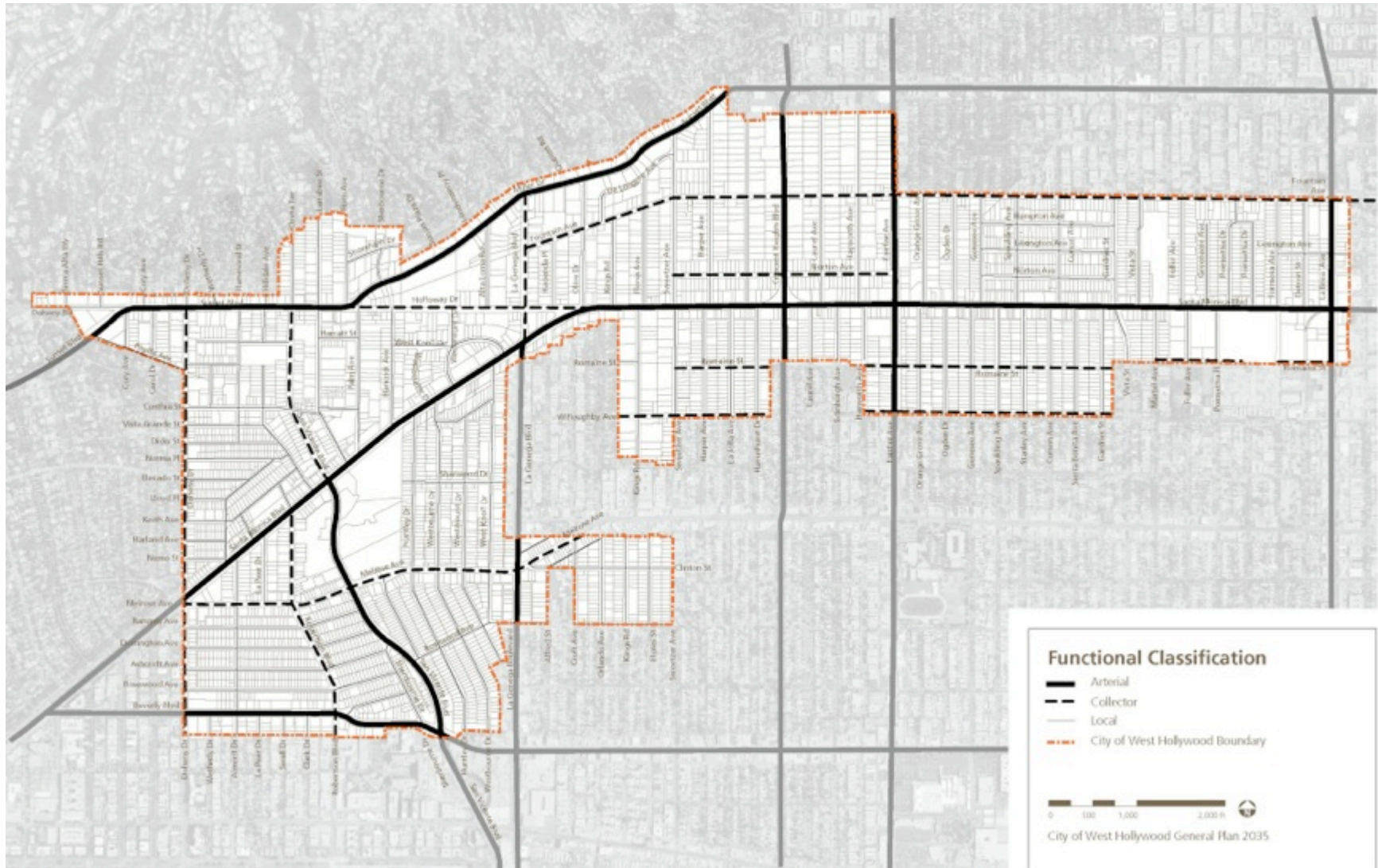



Beverly Garden at Bonner - Concept

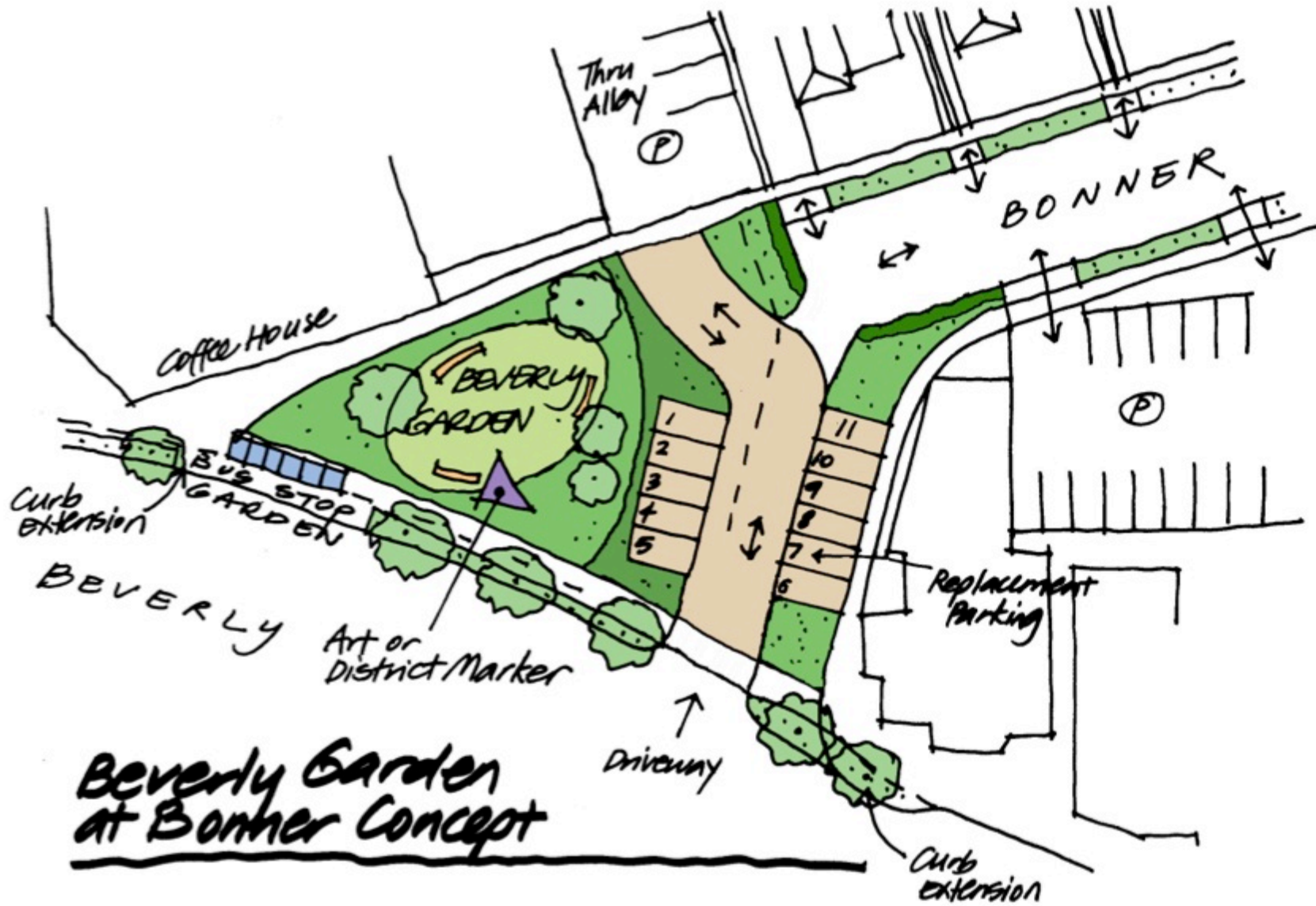

Beverly Garden at Bonner - Concept



2. Consistent Roadway Width/Striping: Melrose

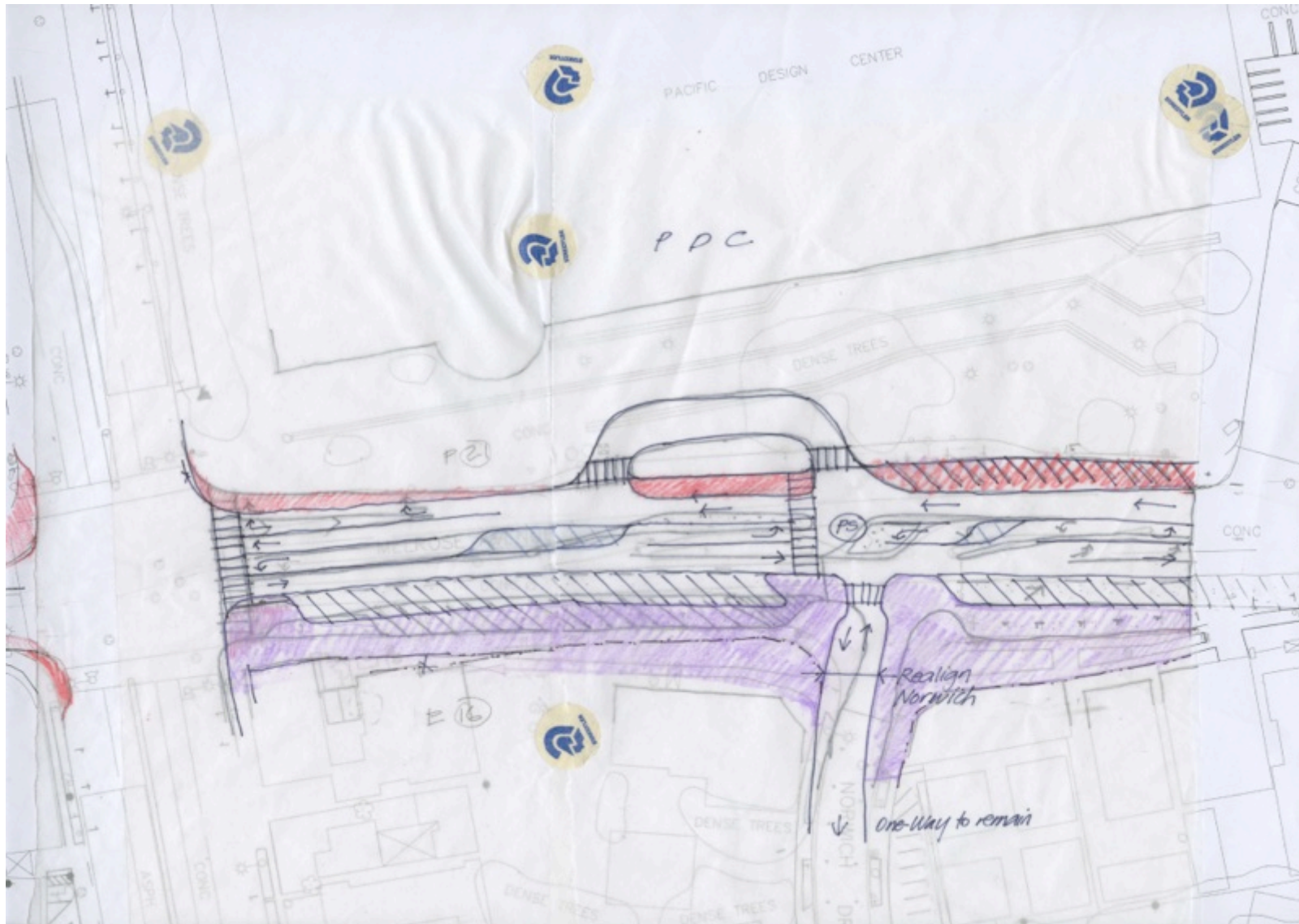

2. Consistent Roadway Width/Striping: Melrose

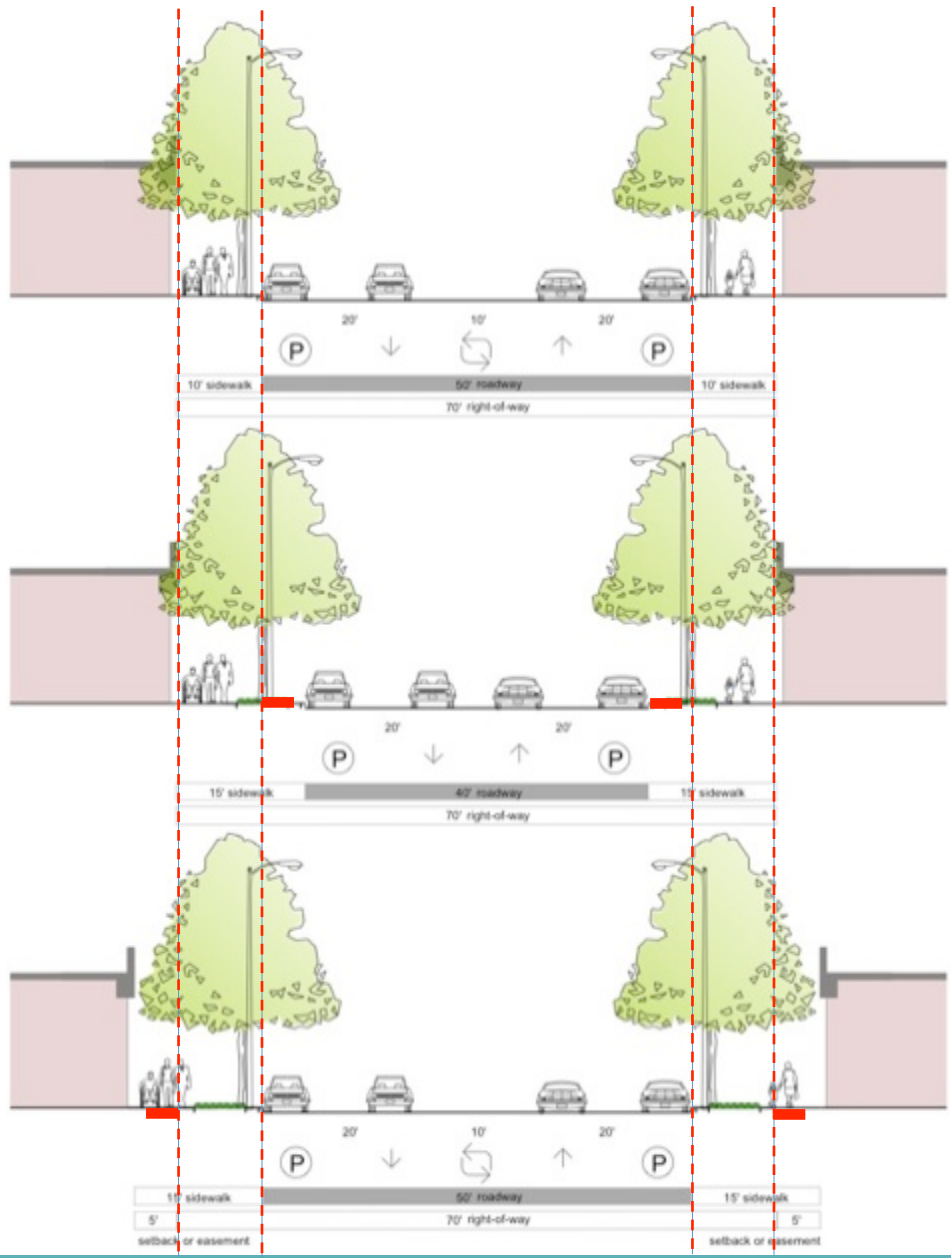

3. Expand Sidewalks: Move Curb or Set Development Back 92